

# ZEBCO 154™

## CLOSED-FACE SPINNING REEL

weight	10.5 oz./298 g		
pound test	8	10	12
yards	120	110	90
meters	110	101	82
gear ratio	3.5:1		

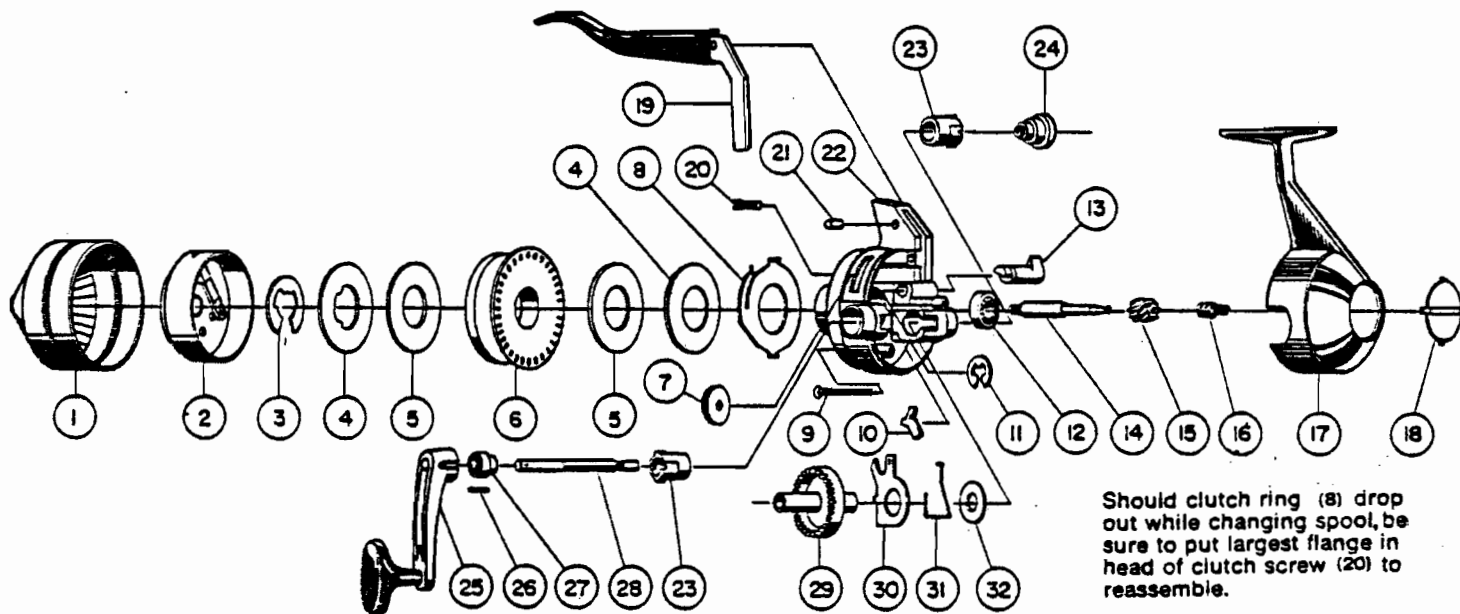

[WWW.REELDR.COM](http://WWW.REELDR.COM)

KEY No.	PART No.	DESCRIPTION	PRICE	KEY No.	PART No.	DESCRIPTION	PRICE
1	CJ24//SA	FRONT COVER	\$3.75	18	CJ75/A	BACK CAP	.65
2	CJ10//SA	SPINNER HEAD	4.20	19	CJ50//SA	FINGER BRAKE	1.40
3	GZ34/B	RETAINER CLIP	.30	20	BJ54/A	CLUTCH SCREW	.25
4	CJ40/A	SPOOL WASHER	.70	21	CJ172/0	FINGER BRAKE PIN	.45
5	CJ108/0	FLAT WASHER	.30	22	CJ1//SA	BODY SUB-ASSY.	3.75
6	CJ21//CP	SPOOL (EMPTY)	2.45	23	CJ26/A	CRANK BEARING	.65
7	CJ32/A	CLUTCH WHEEL	.85	24	DJ69/B	CRANK ROD NUT	.80
8	CJ27/0	CLUTCH RING	.95	25	CJ18//SA	CRANK HANDLE ASSY. (25-28)	3.95
9	CJ126/B	MACHINE SCREW	.35	26	CJ171/0	CRANK HANDLE PIN	.30
10	CJ60/0	ANTI-REVERSE PAWL	.40	27	DJ68/B	CRANK ROD SPACER	.60
11	BJ121/A	RETAINING CLIP	.25	28	CJ67/B	CRANK ROD	2.25
12	AZ28/B	BALL BEARING	3.35	29	CJ12/C	CRANK GEAR	1.35
13	CJ2/B	ANTI-REVERSE ACTUATOR	.50	30	CJ14/0	ANTI-REVERSE DRAG	.35
14	CJ15/A	*CENTER SHAFT	.95	31	CJ61/0	ANTI-REVERSE PAWL SPRING	.30
15	CJ11/A	*PINION GEAR	2.05	32	CJ106/0	WASHER	.30
16	CJ20/0	*CENTER SHAFT SPRING	.30	*AVAILABLE AS ONE UNIT,			
17	CJ23//CP	BACK COVER	5.25	CJ15//SA CENTER SHAFT ASSY.			3.05

PLEASE ORDER BY PART NUMBER