

ZEBCO ZX20

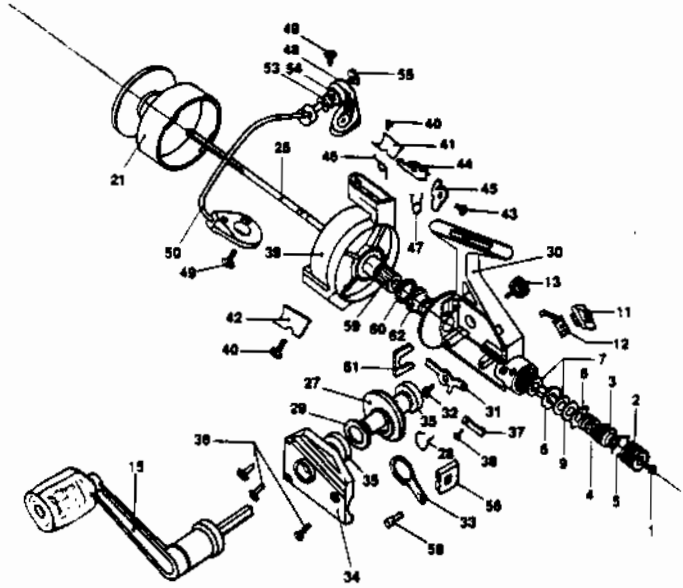

KEY PART

NO.	NO.	DESCRIPTION
1	JK079	DRAG SCREW
2	JK032	DRAG NUT
3	JK127	PRESSURE SLEEVE
4	JK128	PRESSURE SPRING
5	JK070	SAFETY RING
6	JK104	DRAG WHEEL
7	JK030	BRAKE DISC A
8	JK039	NOTCHED DISC B
9	JK046	BRAKE DISC C
10	JK129	LOCK WASHER
11	JK059	ANTI-REVERSE LEVER
12	JK090	ANTI-REVERSE SPRING
13	JK073	HANDLE SCREW CAP
15	JK318	HANDLE ASSY.
21	JK321	SPOOL ASSY.
25	JK315	MAIN SHAFT ASSY.
27	JK012	DRIVE GEAR
28	JK213	DRIVE GEAR SPRING
29	JK026	DRIVE GEAR WASHER
30	JK301	BODY ASSY.
31	JK083	ANTI-REVERSE PAWL
32	JK089	A/R PAWL SCREW
33	JK025	OSCILLATOR GUIDE
34	JK323	SIDE PLATE
35	JK013	SIDE PLATE BUSHING

KEY PART

NO.	NO.	DESCRIPTION
36	JK057	SIDE PLATE SCREW
37	JK068	CLICK CLAW
38	JK067	CLICK CLAW SPRING
39	JK009	ROTOR
40	JK085	ROTOR COVER SCREW
41	JK087	ROTOR COVER (L)
42	JK024	ROTOR COVER (S)
43	JK037	STOP LEVER SCREW
44	JK019	STOP LEVER (L)
45	JK018	STOP LEVER (S)
46	JK049	TURNING SPRING
47	JK047	STOP LEVER SPRING
48	JK007	ANGLE LEVER
49	JK051	ANGLE LEVER SCREW
50	JK347	BAIL ASSY.
53	JK004	LINE ROLLER
54	JK016	LINE ROLLER WASHER
55	JK108	LINE ROLLER SCREW
56	JK081	SLIDE
58	JK084	SLIDE SCREW
59	JK011	PINION GEAR
60	JK010	PINION GEAR WASHER
61	JK125	ROTOR HOLDING PLATE
62	JK126	PINION GEAR BUSHING

JK007 # 13 mill

WWW.REELDR.COM

Prices subject to change without notice. Prices do not include postage and handling.

PLEASE ORDER BY PART NUMBER

Rev. 11/90

Zebco Division Brunswick Corporation, Box 270, Tulsa, OK 74101 USA 918-636-5581

