

**TREBCO**

**STERLING™ 7025™**

weight	10.3 oz./292 g		
pound test	8	8"	10
yards	280	200	138
meters	256	183	123
gear ratio	4.7:1		

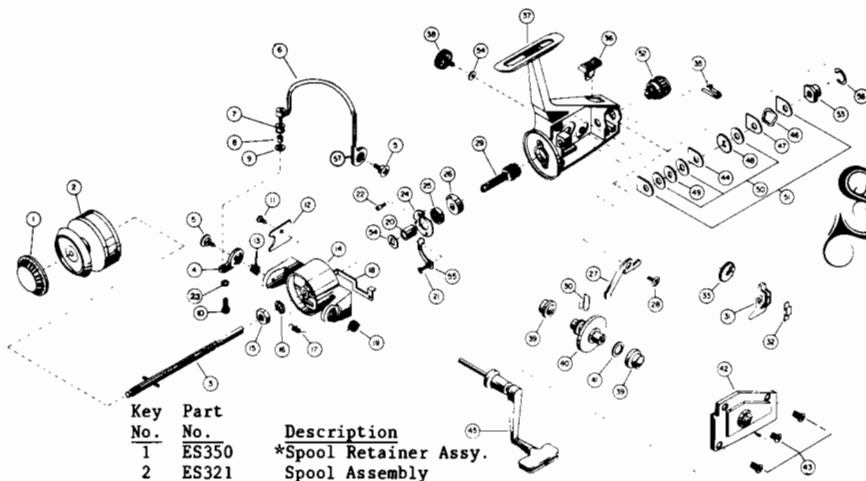

Key No.	Part No.	Description
1	ES350	*Spool Retainer Assy.
2	ES321	Spool Assembly
3	ES315	Center Shaft Assy.
4	ES7	Bail Arm A
5	ES51	Bail Retainer Screw
6	ES347	Bail Assembly
7	ES4	Line Roller
8	EO16	Line Roller Bushing
9	ES102	Bail Axle Washer
10	ES14	Bail Axle Screw
11	ES85	Return Sprg. Cvr. Screw
12	ES87	Return Spring Cover
13	ES44	Bail Spring A
14	ES9	Rotor
15	ES6	Rotor Nut
16	ES65	Rotor Lock Washer
17	ES22	Bail Actuator Spring
18	ES19	Bail Trip Lever
19	ES49	Bail Spring B
20	ES29	Trip Lever Ret. Collar
21	ES80	Bearing Ret. Screw
22	ES84	Bail Actuator Boss
23	ES48	Bail Axle Screw Washer
24	ES40	Bearing Retainer
25	ES28	Pinion Bearing
26	ES60	Anti-Rev. Ratchet
27	ES63	Anti-Reverse Pawl
28	ES100	Anti-Rev. Pawl Screw
29	ES11	Pinion

Key No.	Part No.	Description
30	ES61	Anti-Rev. Pawl Spring
31	ES25	Oscillator Slider
32	ES78	Oscillator Slider Ret.
33	ES53	Oscillator Gear
34	ES24	Trip Lever Retainer
35	ES68	Drag Click Spring
36	ES59	Anti-Reverse Knob
37	ES301	Body
38	ES54	Crank Handle Retainer
39	ES27	Crank Shaft Bushing
40	ES12	Crank Gear
41	ES26	Crank Gear Shim
42	ES323	Side Plate Assy.
43	ES57	Side Plate Screw
44	ES37	Drag Washer D
45	ES318	Crank Handle Assy.
46	ES31	Drag Tension Spring
47	ES38	Drag Washer B
48	ES66	Drag Drive A
49	ES39	Drag Drive B
50	ES30	Drag Washer A
51	ES46	Drag Washer C
52	ES32	Drag Knob
53	ES112	Flanged Nut
54	ES109	Handle Retainer Washer
55	ES125	Bail Actuator Brake
56	ES70	Drag Retainer Clip
57	ES17	Bail Arm B

\*Available individually or in Spool Assembly

Rev. 1084. Prices subject to change without notice. Prices do not include postage and handling.

[WWW.REELDR.COM](http://WWW.REELDR.COM)

**TREBCO**

**STERLING™ 7050™**

weight	16.5 oz./465 g		
pound test	14	17"	20
yards	280	250	160
meters	256	229	166
gear ratio	4:1		

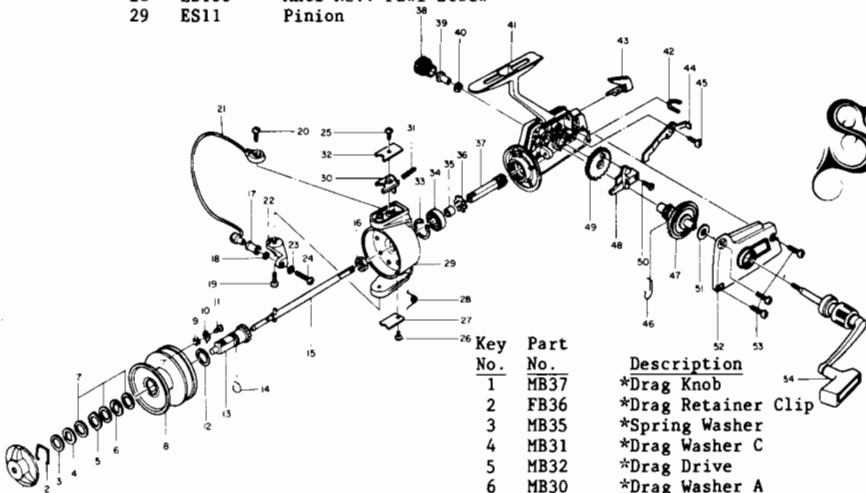

Key No.	Part No.	Description
1	MB37	*Drag Knob
2	FB36	*Drag Retainer Clip
3	MB35	*Spring Washer
4	MB31	*Drag Washer C
5	MB32	*Drag Drive
6	MB30	*Drag Washer A
7	MB33	*Drag Washer B
8	MB321	Spool Assembly
9	LB57	*Spool Claw Spring
10	LB55	*Spool Claw
11	LB56	*Spool Claw Screw
12	LB59	*Spool Spindle Washer
13	MB58	*Spool Spindle Assy.
14	LB60	*Spool Spindle Spring
15	MB15	Center Shaft
16	DB6	Rotor Nut
17	FB4	Line Roller
18	FB16	Line Roller Bushing
19	EB51	Bail Screw A
20	EB51	Bail Screw B
21	FB347	Bail Assembly
22	EB7	Bail Arm A
23	CB102	Bail Axle Screw
24	CB108	Bail Axle Screw
25	EB85	Bail Cover Screw
26	EB85	Bail Cover Screw
27	MB25	Bail Spring Cover

Key No.	Part No.	Description
28	FB22	Bail Spring
29	MB9	Rotor
30	FB19	Bail Trip Lever
31	CB49	Bail Trip Spring
32	MB24	Bail Trip Cover
33	DB40	Bearing Retainer
34	DB28	Pinion Bearing
35	FB81	Pinion Spacer
36	FB60	Anti-Reverse Ratchet
37	FB11	Pinion Gear
38	MB73	Handle Retainer Cover
39	FB54	Handle Retainer
40	FB56	Handle Retainer Washer
41	MB301	Body Assembly
42	FB69	Anti-Rev. Knob Spring
43	FB59	Anti-Reverse Knob
44	MB63	Anti-Reverse Pawl
45	FB80	Anti-Rev. Pawl Screw
46	MB42	Anti-Reverse Actuator
47	MB12	Crank Gear
48	FB25	Oscillator Slider
49	FB53	Oscillator Gear
50	FB100	Osc. Slider Screw A
51	FB92	Crank Gear Shim
52	MB323	Side Plate Assy.
53	CB57	Side Plate Screw
54	MB318	Crank Handle Assy.

\*Available individually or in Spool Assy.

Rev. 1084. Prices subject to change without notice. Prices do not include postage and handling.