

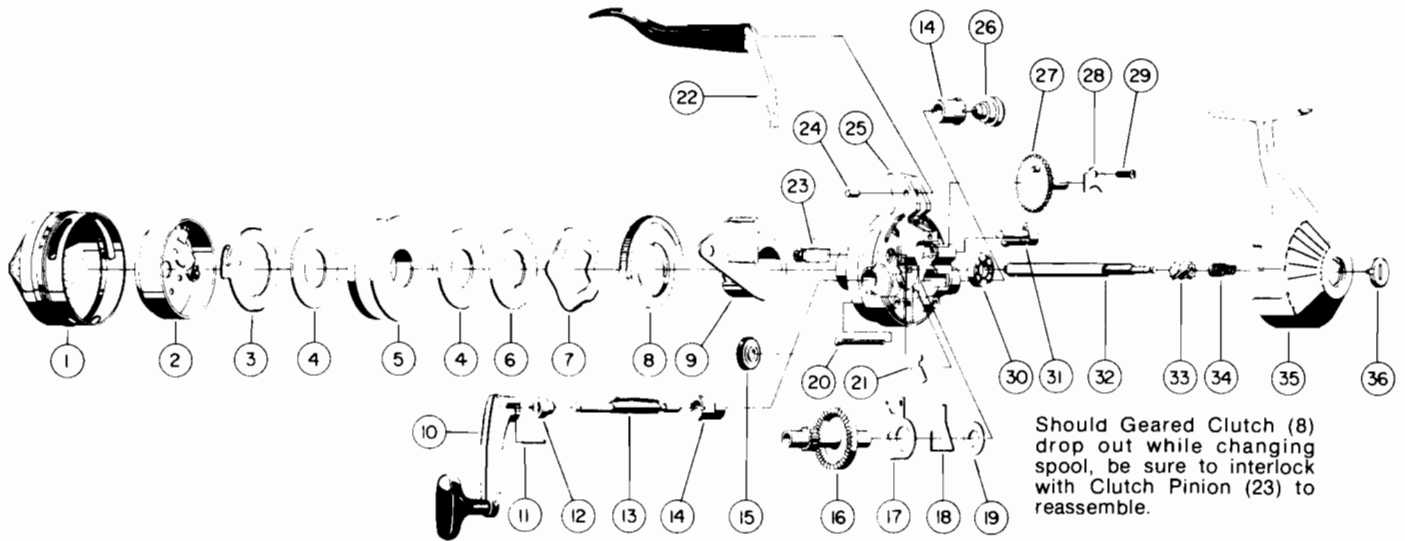

# STERLING™ 60SR™

## CLOSED-FACE SPINNING REEL

weight	15.5 oz./440 g		
pound test	12	14	17
yards	180	165	125
meters	165	151	114
gear ratio	3.5:1		



MODEL 60SR

[WWW.REELDR.COM](http://WWW.REELDR.COM)

Key No.	Part No.	Description	Key No.	Part No.	Description
1	DJ324-1	Front Cover Assy. (SR)	19	CJ106	Pawl Spring Washer
2	DJ310	Spinner Head Assy.	20	CJ126	Machine Screw
3	DJ034	Spool Clip	21	CJ060	Anti-Reverse Pawl
4	DJ108	Flat Washer	22	DJ350	Finger Brake Assy.
5	DJ021	Spool (Empty)	23	DJ054	Clutch Pinion
	DJ321-17T	Spool w/17# Trilene	24	CJ172	Finger Brake Pin
6	DJ040	Spool Washer	25	DJ301-3	Body Assy.(SR)w/Bearing
7	DJ027	Clutch Ring	26	DJ769-2	Crank Rod Nut (SR)
8	DJ197	Geared Clutch	27	DJ190	Oscillator Gear
9	DJ189	Spool Carrier	28	DJ199	Oscillator Gear Ret.
10	DJ318-2	Crank Handle (SR/11-13)	29	AJ057	Retainer Screw
11	CJ171	Crank Handle Pin	30	AZ028	Ball Bearing
12	DJ068	Crank Handle Spacer	31	DJ002	Anti-Rev. Actuator
13	DJ067	Crank Rod	32	DJ015	*Center Shaft
14	CJ026	Crank Bearing	33	CJ011	*Pinion Gear
15	DJ032	Clutch Wheel	34	DJ020	*Center Shaft Spring
16	DJ012	Crank Gear	35	DJ023	Back Cover Assy.
17	CJ014	Anti-Reverse Drag	36	DJ075	Back Cap
18	CJ061	Anti-Rev. Pawl Spring			

\*Available As One Unit,  
DJ315 Center Shaft Assy.

PLEASE ORDER BY PART NUMBER

Zebco Division Brunswick Corporation, Box 270, Tulsa, OK 74101 USA 918-836-5581

