

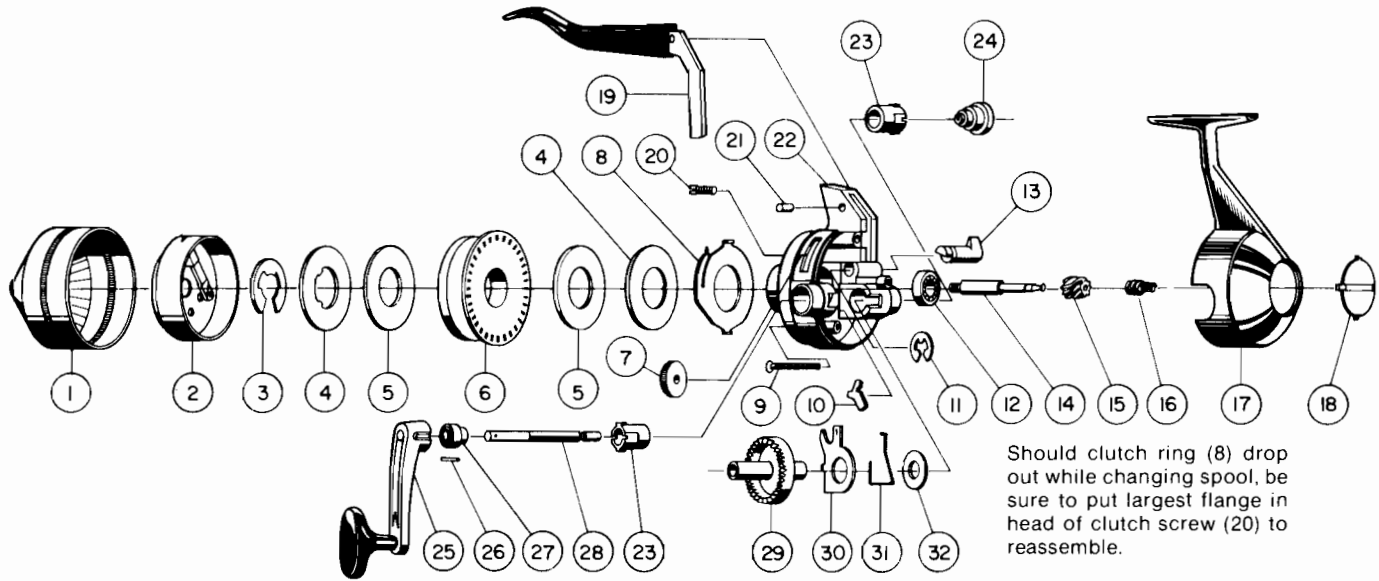

STERLING™ 50SR™

CLOSED-FACE SPINNING REEL

weight	10.5 oz./298 g		
pound test	8	10	12
yards	120	110	90
meters	110	101	82
gear ratio	3.5:1		



Should clutch ring (8) drop out while changing spool, be sure to put largest flange in head of clutch screw (20) to reassemble.

MODEL 50SR

WWW.REELDR.COM

Key No.	Part No.	Description	Key No.	Part No.	Description
1	CJ324-4	Front Cover (Sterling)	17	CJ023	Back Cover
2	CJ310	Spinner Head	18	DJ075	Back Cap
3	GZ034	Retainer Clip	19	CJ350	Finger Brake
4	CJ040	Spool Washer	20	BJ054	Clutch Screw
5	CJ108	Flat Washer	21	CJ172	Finger Brake Pin
6	CJ021	Spool (Empty)	22	CJ301-3	Body Assy.(G) w/Bearing
	CJ321-10T	Spool w/10# Trilene	23	CJ026	Crank Bearing
7	CJ032	Clutch Wheel	24	DJ769-2	Crank Rod Nut (SR)
8	CJ027	Clutch Ring	25	CJ318-3	(SR) Crnk. Hdl. (25-28)
9	CJ126	Machine Screw	26	CJ171	Crank Handle Pin
10	CJ060	Anti-Reverse Pawl	27	DJ068	Crank Rod Spacer
11	BJ121	Retaining Clip	28	CJ067	Crank Rod
12	AZ028	Ball Bearing	29	CJ012	Crank Gear
13	CJ002	Anti-Reverse Actuator	30	CJ014	Anti-Reverse Drag
14	CJ015	*Center Shaft	31	CJ061	Anti-Reverse Pawl Sprng.
15	CJ011	*Pinion Gear	32	CJ106	Washer
16	DJ020	*Center Shaft Spring			

*Available as One Unit,
CJ315 Center Shaft Assy.

PLEASE ORDER BY PART NUMBER

Zebco Division Brunswick Corporation, Box 270, Tulsa, OK 74101 USA 918-836-5581

