

QUANTUM SS3

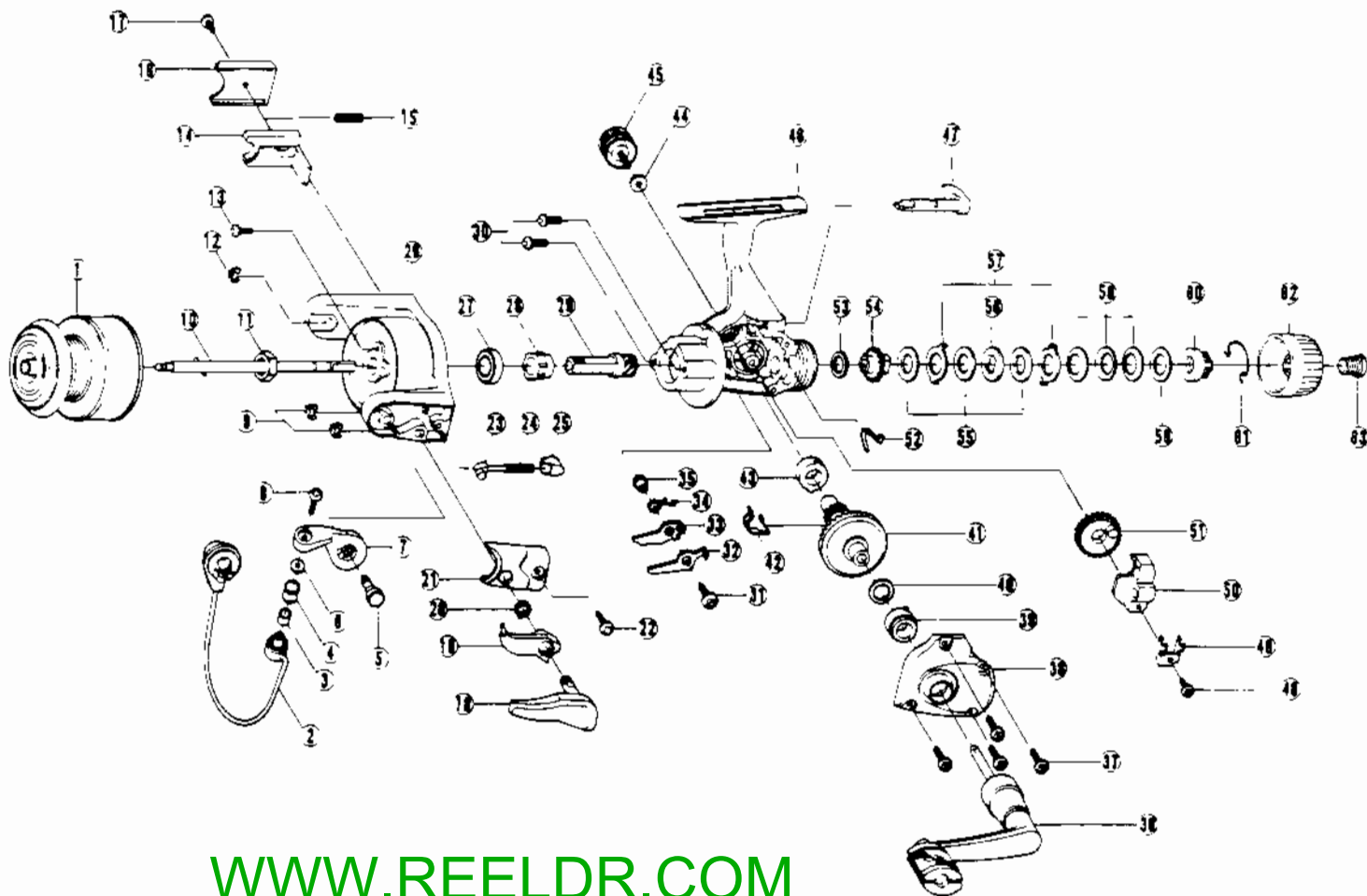

WWW.REELDR.COM

KEY NO.	PART NO.	DESCRIPTION	KEY NO.	PART NO.	DESCRIPTION	KEY NO.	PART NO.	DESCRIPTION
1	JU321	Spool Ass'y	23	QL031	Spring Shaft	46	JU001	Body
2	GU347-3	Bail Ass'y	24	KQ049-2	Arm Lever Spring	47	GU090	Stopper Lever
3	MT016-2	Line Roller Bushing	25	QL020	Arm Lever Spring Holder	48	JU100	Oscillator Retainer Screw
4	MT004	Line Roller	26	JU009	Rotor	49	JU078	Oscillator Slider Retainer
5	GU051-3	Arm Lever Pin	27	AQ028-6	Ball Bearing	50	JU025	Oscillator Slider
6	GU105-7	Line Roller Washer	28	JU060	Ratchet Gear	51	JU053	Oscillation Gear
7	JU007	Arm Lever	29	JU011	Pinion Gear	52	GU089	Stopper Lever Spring
8	KQ108	Bail Screw	30	JU077	Bearing Screw	53	GL105-17	Drag Friction Washer
9	KQ034	"E" Clip	31	GU077-5	Stopper Screw	54	JU075	Metal
10	JU315	Main Shaft Ass'y	32	JU063	Stopper "A"	55	GU105-18	Drag "B" Washer
11	GU006-2	Rotor Nut	33	JU074	Stopper "B"	56	JU080	Drag "D" Washer
12	KQ034	"E" Clip	34	JU061	Stopper Spring	57	JU081	Drag "A" Washer
13	GU077-4	Rotor Nut Lock Screw	35	GU091-2	Stopper Bushing	58	JU043	Drag Spring
14	JU019	Kick Lever	36	GU318-3	Handle Ass'y	59	GU105-19	Drag Adj. Washer
15	KQ049	Kick Lever Spring	37	JU057	Body Cover Screw	60	JU066	Drag Nut
16	JU046	Kick Lever Cover	38	JU023	Body Cover	61	JU083	Drag Click Claw
17	GU077-2	Kick Lever Cover Screw	39	JU027	Body Cover Bushing	62	JU032	Drag Knob
18	GU115-2	Trip Lever Ass'y	40	GU105-13	Drive Gear Adj. Washer	63	JU101	Drag Knob Screw
19	GU097	Trip Link Ass'y	41	JU012	Drive Gear			
20	NL096	Trip Link Spring	42	JU086	Silent Cam			
21	JU087	Arm Lever Spring Cover	43	JU027	Body Bushing			
22	GU077-2	Arm Lever Spring Cover Screw	44	GU105	Handle Cap Washer			
			45	GU073	Handle Screw Cap			

PLEASE ORDER BY PART NUMBER

Rev. 7/92

Zebco Division Brunswick Corporation, Box 270, Tulsa, OK 74101 USA 918-836-5581



BRUNSWICK