

# QUANTUM SS2A

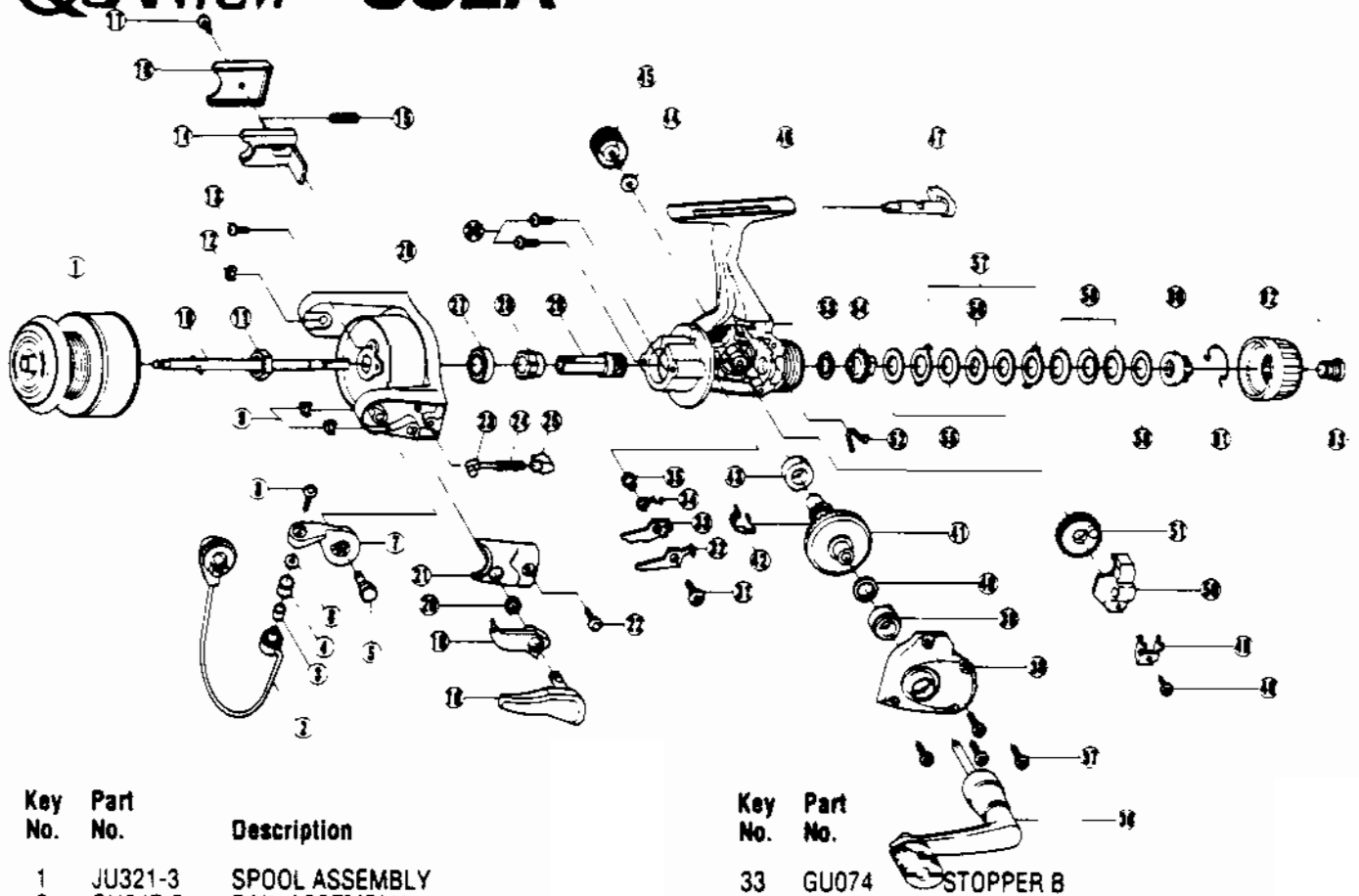

Key No.	Part No.	Description
1	JU321-3	SPOOL ASSEMBLY
2	GU347-5	BAIL ASSEMBLY
3	MT016-2	LINE ROLLER BUSHING
4	MT004	LINE ROLLER
5	GU051-3	ARM LEVER PIN
6	GU105-7	WASHER-LINE ROLLER
7	KQ021	SPOOL
8	KQ108	BAIL SCREW
9	KQ034	E-CLIP
10	JU315-2	MAIN SHAFT
11	GU006	ROTOR NUT
12	KQ034	E-CLIP
13	GU077-4	SCREW ROTOR NUT LOCK
14	HU019	KICK LEVER
15	KQ049	KICK LEVER SPRING
16	HU046	KICK LEVER COVER
17	GU077-2	SCREW
18	GU115-2	TRIP LEVER-ASSEMBLY
19	GU097	TRIP LINK ASSEMBLY
20	NL096	TRIP LINK SPRING
21	HU087	ARM LEVER SP/COVER
22	GU077-2	SCREW
23	NL031	SPRING SHAFT
24	KQ049-3	ARM LEVER SPRING
25	QL020	SPRING HOLDER
26	HU009	ROTOR
27	AQ028	BODY BEARING - ROTOR
28	PL060	RATCHET GEAR
29	KQ044	BAIL HOLDER SCREW
30	GU077	SCREW-BEARING
31	GU077-5	SCREW-STOPPER
32	GU063	STOPPER A

WWW.REELDR.COM

Key No.	Part No.	Description
33	GU074	STOPPER B
34	GU061	STOPPER SPRING
35	GU091	STOPPER BUSHING
36	GU318-5	HANDLE ASSEMBLY
37	GU057	SCREW-BODY COVER
38	HU023	BODY COVER
39	GU027	BODY BUSHING
40	GU105-8	D/G ADJ. WASHER
41	GU012	DRIVE GEAR
42	GU086	SILENT CAM
43	GU027	BODY BUSHING
44	GU105	WASHER-HANDLE SCREW CAP
45	GU073	HANDLE SCREW CAP
46	HU001	BODY
47	GU090	STOPPER LEVER
48	JU100	SCREW-OSC. RETAINER
49	HU078	RETAINER-OSC. SLIDER
50	HU025	OSC. SLIDER
51	HU053	OSCILLATION GEAR
52	GU089	STOPPER LEVER SPRING
53	GU105-22	WASHER-DRAG FRICTION
54	HU075	METAL GEAR
55	GU105-23	WASHER-DRAG B
56	HU080	WASHER-DRAG D
57	HU081	WASHER DRAG A
58	HU043	DRAG SPRING
59	GU105-24	DRAG ADJ. WASHER
60	HU066	DRAG NUT
61	RL033	DRAG CLICK CLAW
62	HU032	DRAG KNOB
63	HU101	DRAG KNOB SCREW

Prices subject to change without notice. Prices do not include postage and handling.

**PLEASE ORDER BY PART NUMBER**

Rev. 5/93

Zebco Division Brunswick Corporation, Box 270, Tulsa, OK 74101 USA 918-836-5581

