

If Bud won't fly back Kick lever is bent. Take cover off and replace. Don't undo rotor.

QUANTUM SS20

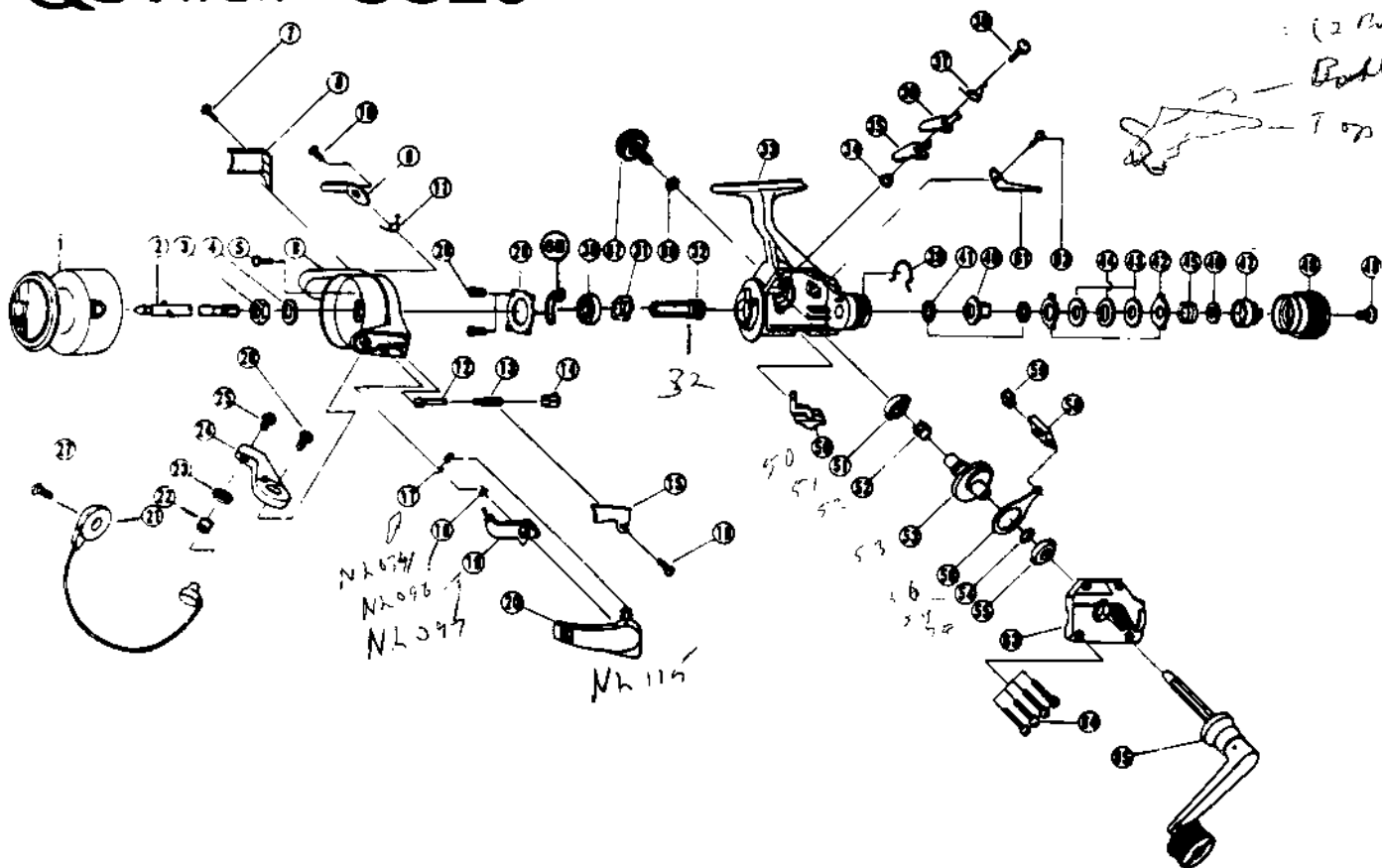

KEY PART NO. NO.

KEY PART NO. NO.	DESCRIPTION
1 PL321	SPOOL ASSY.
2 SL315	MAIN SHAFT ASSY.
3 RLO08	ROTOR NUT
4 RLO65	ROTOR 'D' WASHER
5 RLO94	ROTOR NUT LOCK SCREW
6 PLO09	ROTOR
7 RD665	COVER/CLICK CLAM SCREW
8 SLO24	KICK LEVER COVER
9 SLO19	KICK LEVER
10 RLO37	KICK LEVER SCREW
11 RLO49	KICK LEVER SPRING
12 RLO31	SPRING SHAFT
13 RLO22	BAIL SPRING
14 RLO20	SPRING HOLDER
15 PLO87	BAIL SPRING COVER
16 NL085	BAIL SPRING COVER SCREW
17 NL034	E-CLIP
18 NL096	TRIP LINK SPRING
19 NL097	TRIP LINK ASSY.
20 NL115	TRIP LEVER ASSY.
21 PL347	BAIL ASSY.
22 SLO04	LINE ROLLER
23 SLO17	BAIL COLLAR
24 PLO07	ARM LEVER
25 SL108	BAIL SCREW
26 NL107	ARM LEVER SCREW
27 RLO51	BAIL HOLDER SCREW
28 SLO80	BEARING PLATE SCREW
29 RLO40	BEARING PLATE
30 RLO28	BALL BEARING
31 RLO60	PATCHET GEAR
32 SLO11	PINION GEAR
33 PLO01	BODY
34 RLO91	STOPPER BUSHING

KEY PART NO. NO.

KEY PART NO. NO.	DESCRIPTION
35 RLO64	STOPPER 'A'
36 RLO63	STOPPER 'B'
37 RLO61	STOPPER SPRING
38 RLO83	STOPPER SCREW
39 SLO33	DRAG CLICK CLAM
40 RLO75	METAL
41 SLO38	DRAG 'B' WASHER - 1
42 RLO30	DRAG 'A' WASHER
43 SLO39	DRAG 'B' WASHER - 2
44 RLO66	DRAG 'D' WASHER
45 RLO43	DRAG COIL SPRING
46 RLO46	DRAG ADJUSTING WASHER
47 RLO29	DRAG NUT
48 PLO32	DRAG CAP
49 RLO79	DRAG CAP SCREW
50 RLO59	STOPPER LEVER
51 RLO13	BODY/BODY COVER BUSHING
52 RLO86	SILENT CAM
53 SLO12	DRIVE GEAR
54 RLO26	DRIVE GEAR ADJ. WASHER
55 RLO13	BODY/BODY COVER BUSHING
56 SLO25	O/S SLIDER
58 SLO81	PIN SLIDER
59 SLO78	SLIDER STOPPER
61 RLO68	CLICK CLAM
62 RLO85	COVER/CLICK CLAM SCREW
63 PLO23	BODY COVER
64 SLO57	BODY COVER SCREW
65 SL318	HANDLE ASSY.
66 SLO76	HANDLE SCREW CAP WASHER
67 PLO73	HANDLE SCREW CAP
68 RLO82	KICK LEVER GUIDE

WWW.REELDR.COM

Prices subject to change without notice. Prices do not include postage and handling.

PLEASE ORDER BY PART NUMBER

Rev. 11/90

Zebco Division Brunswick Corporation, Box 270, Tulsa, OK 74101 USA 918-836-5581

