

QUANTUM SS05

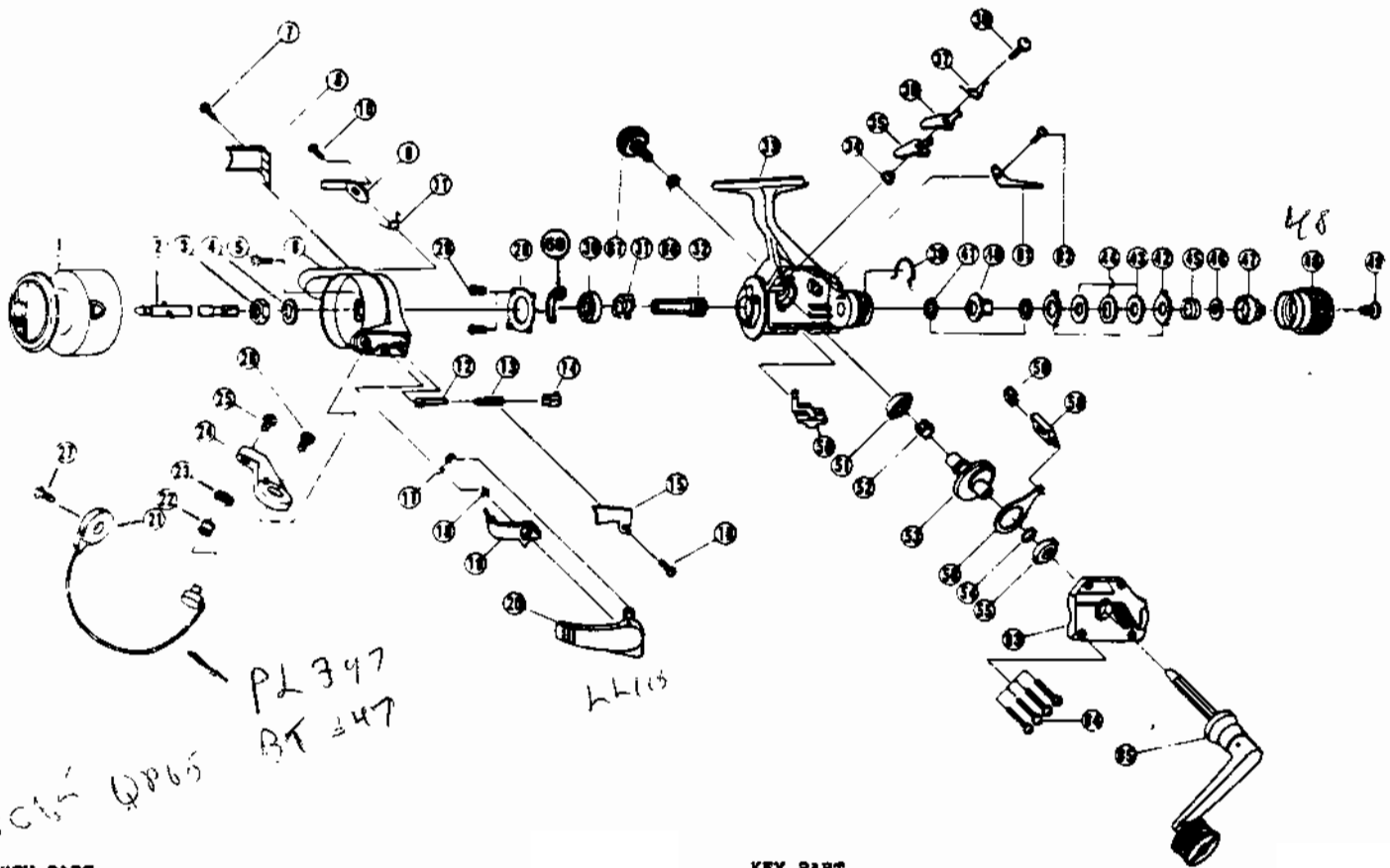

KEY PART NO. NO.	DESCRIPTION
1 NL321	SPOOL ASSY.
2 RL315	MAIN SHAFT ASSY.
3 RLO06	ROTOR NUT
4 RLO65	ROTOR 'D' WASHER
5 RLO94	ROTOR NUT LOCK SCREW
6 NLO09	ROTOR
7 RLO85	COVER/CLICK CLAM SCREW
8 RLO24	KICK LEVER COVER
9 RLO19	KICK LEVER
10 RLO37	KICK LEVER SCREW
11 RLO49	KICK LEVER SPRING
12 RLO31	SPRING SHAFT
13 RLO22	BAIL SPRING
14 RLO20	SPRING HOLDER
15 NLO87	BAIL SPRING COVER
16 NLO85	BAIL SPRING COVER SCREW
17 NLO34	E-CLIP
18 NLO96	TRIP LINK SPRING
19 NLO97	TRIP LINK ASSY.
20 NL115	TRIP LEVER ASSY.
21 NL347	BAIL ASSY.
22 RLO64	LINE ROLLER
23 RLO17	BAIL COLLAR
24 NLO07	ARM LEVER
25 RL108	BAIL SCREW
26 NL107	ARM LEVER SCREW
27 RLO51	BAIL HOLDER SCREW
28 RLO80	BEARING PLATE SCREW
29 RLO40	BEARING PLATE
30 RLO28	BALL BEARING
31 RLO60	RATCHET GEAR
32 RLO11	PINION GEAR
33 NL001	BODY
34 RLO91	STOPPER BUSHING

KEY PART NO. NO.	DESCRIPTION
35 RLO64	STOPPER 'A'
36 RLO63	STOPPER 'B'
37 RLO61	STOPPER SPRING
38 RLO82	STOPPER SCREW
39 RLO33	DRAG CLICK CLAW METAL
40 RLO75	METAL
41 RLO38	DRAG 'B' WASHER - 1
42 RLO30	DRAG 'A' WASHER
43 RLO39	DRAG 'B' WASHER - 2
44 RLO66	DRAG 'D' WASHER
45 RLO43	DRAG COIL SPRING
46 RLO46	DRAG ADJUSTING WASHER
47 RLO29	DRAG NUT
48 NLO32	DRAG CAP
49 RLO79	DRAG CAP SCREW
50 RLO59	STOPPER LEVER
51 RLO13	BODY/BODY COVER BUSHING
52 RLO86	SILENT CAM
53 RLO12	DRIVE GEAR
54 RLO26	DRIVE GEAR ADJ. WASHER
55 RLO13	BODY/BODY COVER BUSHING
56 RLO25	O/S SLIDER
58 RLO81	SLIDER PIN
61 RLO68	CLICK CLAW
62 RLO85	COVER/CLICK CLAM SCREW
63 NLO23	BODY COVER
64 RLO57	BODY COVER SCREW
65 NL318	HANDLE ASSY.
66 RLO76	HANDLE SCREW CAP WASHER
67 NLO73	HANDLE SCREW CAP
68 RLO82	KICK LEVER GUIDE

WWW.REELDR.COM

Prices subject to change without notice. Prices do not include postage and handling.

PLEASE ORDER BY PART NUMBER

Rev. 11/90

Zebco Division Brunswick Corporation, Box 270, Tulsa, OK 74101 USA 918-636-5581



BRUNSWICK