

QUANTUM SLC4

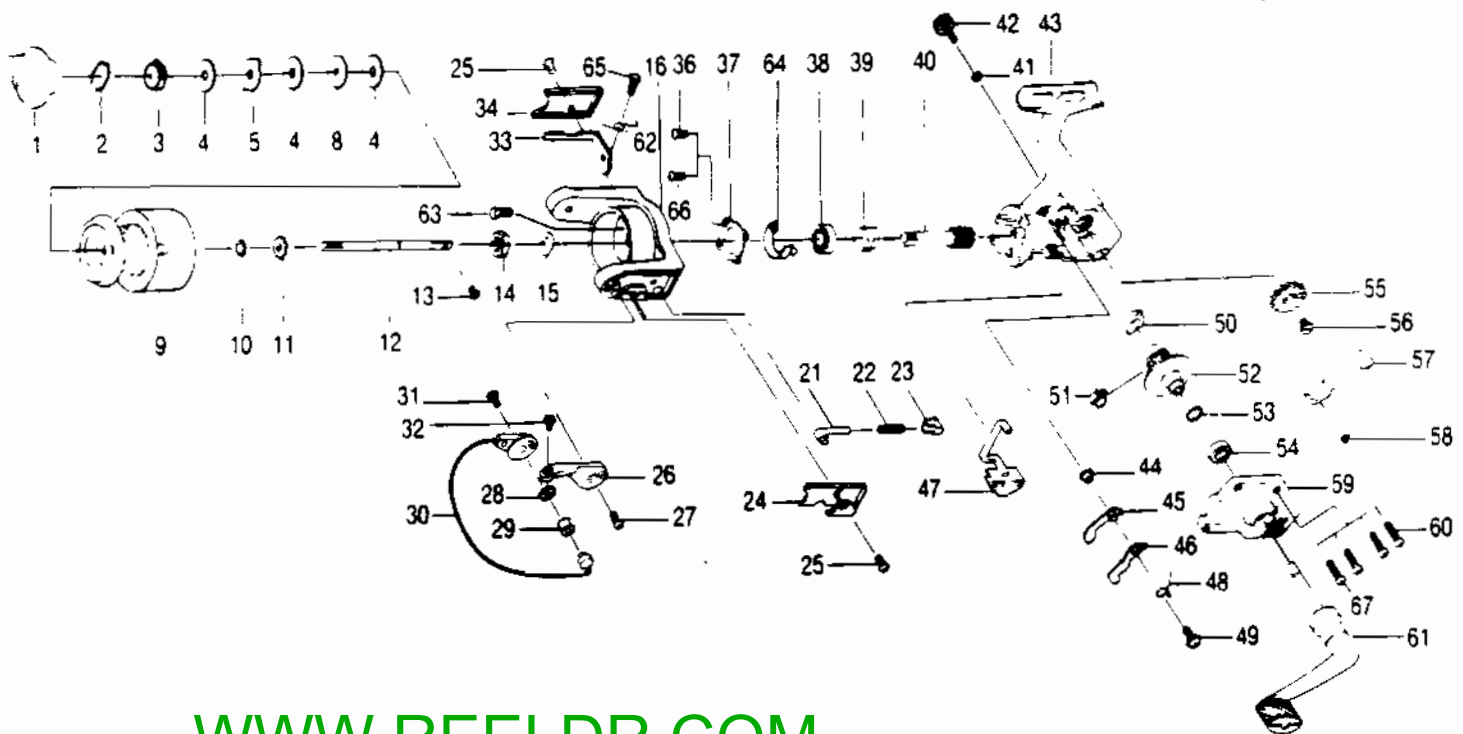

WWW.REELDR.COM

KEY NO.	PART NO.	DESCRIPTION	KEY NO.	PART NO.	DESCRIPTION	KEY NO.	PART NO.	DESCRIPTION
1	CQ332	Drag Knob Assy.	27	AQ051	Arm Lever S/C	48	CQ061	Stopper L/R Spring
2	CQ038	Drag Retainer	28	PL017	Bail Collar	49	CQ083	Stopper S/C
3	CQ050	Spool Retainer	29	PL004	Line Roller	50	AQ013-1	Body Bushing
4	CQ033	Spool W/S A	30	CQ347-1	Bail Assy.	51	CQ086	Sliding Spring
5	CQ029	Spool W/S B	31	AQ044	Bail Holder S/C	52	CQ012	Drive Gear
8	CQ046	Spool W/S D	32	SL108	Bail S/C	53	AQ026	Drive Gear A/J W/S
9	GQ321-3	Spool Assy.	33	CQ019-1	Kick Lever	54	AL013	Body Cover Bushing
10	CQ030	Spool A/J W/S	34	CQ024-1	Kick Lever Cover	55	CQ053	O/S Gear
11	CQ037	Spool Click Gear	36	AQ080	Bearing Plate S/C	56	WK078	O/S Gear S/C
12	CQ015-1	Main Shaft	37	CQ040-1	Bearing Plate	57	CQ025	O/S Pivot Arm
13	AQ100	Main Shaft S/C	38	CQ028	B/Bearing - Rotor	58	AQ056	O/S Pivot Arm W/S
14	UL006	Rotor Nut	39	CQ060	Ratchet Gear	59	CQ023-2	Body Cover
15	UL065	Rotor Retainer W/S	40	GQ011-2	Pinion Gear	60	AQ057	Body Cover S/C
16	CQ009-2	Rotor	41	BQ105	Handle Cap W/S	61	QL318	Handle Assy.
21	QL031	Spring Shaft	42	QL073	Handle S/C Cap	62	CQ049-1	Kick Lever Spring
22	QL022	Bail Spring	43	CQ001-2	Body	63	RL094	Rotor Nut Lock S/C
23	QL020	Spring Holder	44	NL091	Stopper Bushing	64	CQ082-1	Kick Lever Guide
24	CQ087-1	Bail Spring Cover	45	QL064	Stopper-A	65	AQ077	Kick Lever S/C
25	AQ085	Rotor Cover S/C	46	QL063	Stopper-B	66	AQ080-1	Bearing Plate S/C
26	CQ007	Arm Lever	47	CQ059	Stopper Lever	67	—	Body Cover S/C

PLEASE ORDER BY PART NUMBER

Rev. 7/92

Zebco Division Brunswick Corporation, Box 270, Tulsa, OK 74101 USA 918-838-6581

