

QUANTUM™ QMD20, QMD20QC

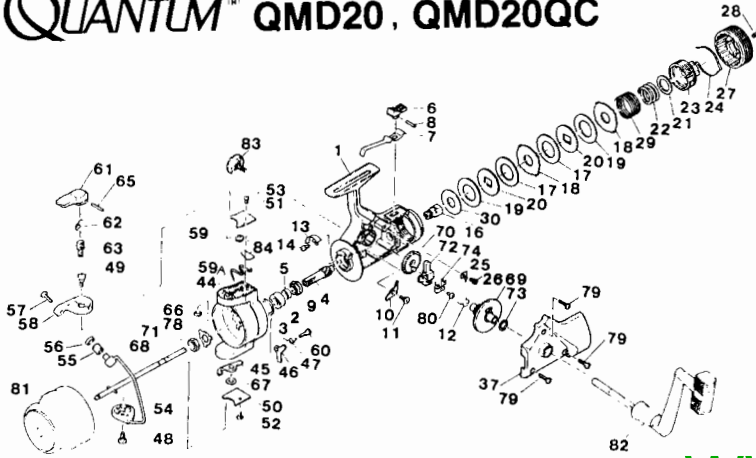

WWW.REELDR.COM

Key No.	Part No.	Description
1	Q31001	Body Assembly
2	Q31002	Rotor Bearing
3	Q00401	Bearing Retainer
4	Q31004	Pinion Gear
5	Q31005	Pinion Sleeve QMD20
6	Q31006	Anti-Reverse Switch Knob
7	Q31007	Anti-Reverse Lever Spring
8	Q00308	Switch Knob Retaining Pin
9	Q31010	Anti-Reverse Ratchet QMD20
	Q31010A	Anti-Reverse Ratchet QMD20QC
10	Q31011	Anti-Reverse Pawl
11	Q31012	Anti-Reverse Pawl Screw
12	Q31013	Silent Anti-Reverse Spring
13	Q21015	Rotor Brake
14	Q00108	Rotor Brake Screw
16	Q31101	Drag Shaft
17	Q31102	Fiber Drag Washer
18	Q31104	Keyed Drag Washer
19	Q31105	Teflon Drag Washer
20	Q31106	Shaft Drag Washer
21	Q31108	Drag Spring Washer
22	Q31109	Main Drag Spring
23	Q31110	Drag Screw
24	Q31112	Drag Knob Retainer
25	Q11115	Click Pawl
26	Q00108	Click Pawl Screw
27	Q31117	Drag Knob
28	Q00123	Drag Knob Screw
29	Q31118	Drag Retainer Spring
30	Q31119	Front Drag Washer
37	Q33001	Side Plate
44	Q35001	Rotor QMD20
	Q35001A	Rotor QMD20QC
45	Q35003	Bail Trip Lever (A)
46	Q35004	Bail Trip Lever (B)
47	Q75005	Bail Trip Lever Spring

Key No.	Part No.	Description
48	Q15006	Bail Bracket Screw
49	Q35007	Bail Hinge Screw QMD20
50	Q35010	Rotor Cover (A)
51	Q35011	Rotor Cover (B)
52	Q00105	Rotor Cover Screw (A)
53	Q00117	Rotor Cover Screw (B)
54	Q35012	Bail Assembly QMD20
	Q35012A	Bail Assembly QMD20QC
55	Q35014	Line Roller
56	Q35015	Line Roller Bushing
57	Q00104	Line Roller Screw
58	Q35016	Bail Hinge QMD20
	Q35016A	Bail Hinge QMD20QC
59	Q35017	Bail Tension Spring QMD20
59A	Q35017A	Bail Tension Spring QMD20QC
60	Q75018	Bail Trip Lever (B) Screw
61	Q35023A	Trigger QMD20QC
62	Q35024A	Trigger Spring QMD20QC
63	Q35025A	Trigger Shaft QMD20QC
64	Q35026A	Bail Hinge Sleeve QMD20QC
65	Q30307A	Trigger Pin QMD20QC
66	Q00601A	Trigger Shaft Retainer
67	Q35027	Bail Trip Lever (A) Washer
68	Q37001	Center Shaft Assembly
69	Q38001	Crank Gear
70	Q38002	Oscillator Gear
71	Q38005	Rotor Nut
72	Q38006	Oscillator Slide Block
73	Q38009	Crank Gear Washer
74	Q38014	Oscillator Block Retainer
78	Q38016	Rotor Nut Washer
79	Q01113	Side Plate Screw
80	Q00105	Oscillator Block Screw
81	Q34000	Spool Assembly
82	Q32000	Handle Assembly
83	Q38000	Handle Screw Assembly
84	Q3505WA	Spacer Plate Washer

TEBCO 4010™ 4020™ 4040™

Key No.	Description	4010 Part No.	4020 Part No.	4040 Part No.
1	Drag Knob	JA32	DA32	EA32
2	Spool Assembly	JA321	DA321	EA321
3	Spool Seat Washer	JA45	DA45	EA45
4	Click Gear	JA56	DA56	EA56
5	*Click Spring	CB67	CB67	CB67
6	*Clk. Sprng. Retainer	CB68	CB68	CB68
7	Bail Assembly	JA347	DA347	EA347
8	Line Roller	CB4	CB4	FB4
9	Line Roller Bushing	CB16	CB16	FB16
10	Bail Arm	JA7	DA7	EA7
11	Bail Screw	CB51	CB51	CB51
12	Bail Axle Washer	CB102	CB102	CB102
13	Bail Axle Screw	CB108	CB108	CB108
14	Center Shaft	JA315	DA315	EA315
15	Bail Cover Screw	CB85	DB85	CB80
16	Bail Spring Cover	JA87	DA87	EA87
17	Bail Spring	JA22	DA22	EA22
18	Bail Trip Lever	JA19	DA19	EA19
19	Bail Trip Spring	JA49	DA49	EA49
20	Rotor	JA9	DA9	EA9
21	Rotor Retainer	DA6	DA6	DA6
22	Handle Retainer	JA54	DA54	EA54
23	Handle Ret. Washer	CB105	CB105	CB105
24	Body	JA301	DA301	EA301
25	Anti-Reverse Knob	DA59	DA59	EA59
26	Anti-Rev. Knob Spring	DA69	DA69	EA69
27	Crank Gear	JA12	DA12	EA12
28	Oscillator Slider	JA25	DA25	EA25
29	Oscillator Slider Pin	JA62	DA62	EA62
30	Crank Gear Shim	JA73	DA73	EA73
31	Anti-Rev. Pawl Screw	FB80	FB80	FB80
32	Anti-Rev. Pawl Spring	CB61	CB61	EA61
33	Anti-Reverse Pawl	DA63	DA63	EA63
34	Side Plate Assembly	JA323	DA323	EA323
35	Side Plate Screw	CB57	CB57	CB57
36	Crank Handle Assembly	JA318	DA318	EA318

