

# QUANTUM<sup>®</sup> QMD20QC

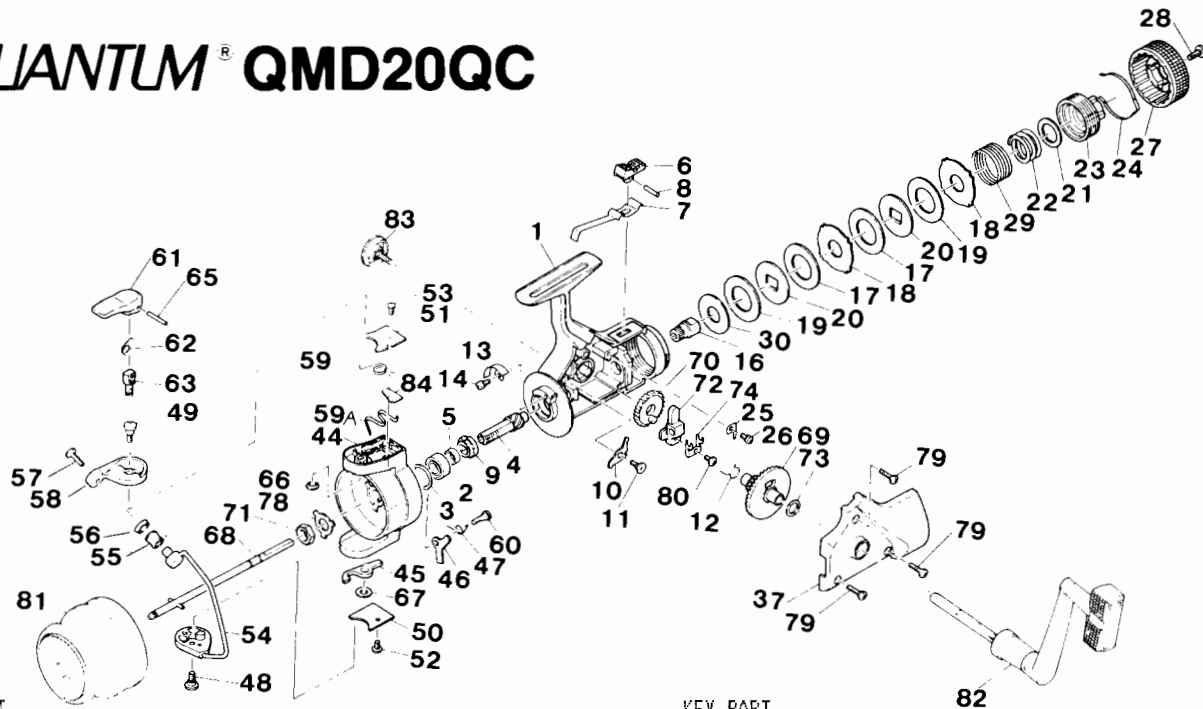

KEY PART  
NO. NO.

KEY PART NO. NO.	DESCRIPTION
1 Q31001	BODY ASSY
2 Q31002	ROTOR BEARING
3 Q00401	BEARING RETAINER
4 Q31004	PINION GEAR
5 Q31005	PINION SLEEVE
6 Q31006	ANTI-REV SWITCH KNOB
7 Q31007	ANTI-REV LEVER SPR
8 Q00308	SWITCH KNOB RETAN.PIN
9 Q31010A	ANTI-REV. RATCHET
10 Q31011	ANTI-REVERSE PAWL
11 Q31012	ANTI-REV. PAWL SCREW
12 Q31013	SILENT ANTI-REV SPRING
13 Q21015	ROTOR BRAKE
14 Q00108	SCREW
16 Q31101	DRAG SHAFT
17 Q31102	FIBER DRAG WASHER
18 Q31104	EARED DRAG WASHER
19 Q31105	TEFLON DRAG WASHER
20 Q31106	SHAFT DRAG WASHER
21 Q31108	DRAG SPRING WASHER
22 Q31109	MAIN DRAG SPRING
23 Q31110	DRAG SCREW
24 Q31112	DRAG KNOB REATINER
25 Q11115	CLICK PAWL
26 Q00108	SCREW
27 Q31117	DRAG KNOB
28 Q00123	DRAG KNOB SCREW
29 Q31118	DRAG RETAINER SPRING
30 Q31119	FRONT DRAG WASHER
37 Q33001	SIDE PLATE
44 Q35001A	ROTOR
45 Q35003	TRIP LEVER A
46 Q35004	TRIP LEVER B
47 Q75005	TRIP LEVER SPRING

KEY PART  
NO. NO.

KEY PART NO. NO.	DESCRIPTION
48 Q15006	BAIL BRACKET SCR
50 Q35010	ROTOR COVER A
51 Q35011	ROTOR COVER B
52 Q00105	ROTOR CVR OSC. SCREW A
53 Q00117	ROTOR COVER SCREW B
54 Q35012A	BAIL ASSEMBLY
55 Q35014	LINE ROLLER
56 Q35015	LINE ROLLER BUSHING
57 Q00104	LINE ROLLER SCREW
58 Q35016A	BAIL HINGE QMD20QC
59 A Q35017A	BAIL TENSION SPRING
60 Q75018	TRIP LEVER B SCREW
61 Q35023A	TRIGGER
62 Q35024A	TRIGGER SPRING
63 Q35025A	TRIGGER SHAFT
64 Q35026A	BAIL HINGE SLEEVE
65 Q30307A	TRIGGER PIN
66 Q00601A	TRIGGER SHAFT RETAINER
67 Q35027	TRIP LEVER A WASHER
68 Q37001	CENTER SHAFT ASSY
69 Q38001	CRANK GEAR
70 Q38002	OSCILLATOR GEAR
71 Q38005	ROTOR NUT
72 Q38006	OSCILLATOR SLIDE BLOCK
73 Q38009	ROTOR/CRANK GEAR WSHR
74 Q38014	OSC BLOCK RETAINER
78 Q38016	ROTOR NUT WASHER
79 Q01113	SIDE PLATE SCREW
80 Q00105	ROTOR CVR OSC. SCREW A
81 Q34000	SPOOL ASSY
82 Q32000	HANDLE ASS'Y
83 Q38000	HANDLE SCREW ASSY
84 Q3505WA	SPACER PLATE

WWW.REELDR.COM

Prices subject to change without notice. Prices do not include postage and handling.

**PLEASE ORDER BY PART NUMBER**

Rev. 9/88

Zebco Division Brunswick Corporation, Box 270, Tulsa, OK 74101 USA 918-836-5581

