

# QUANTUM QG200

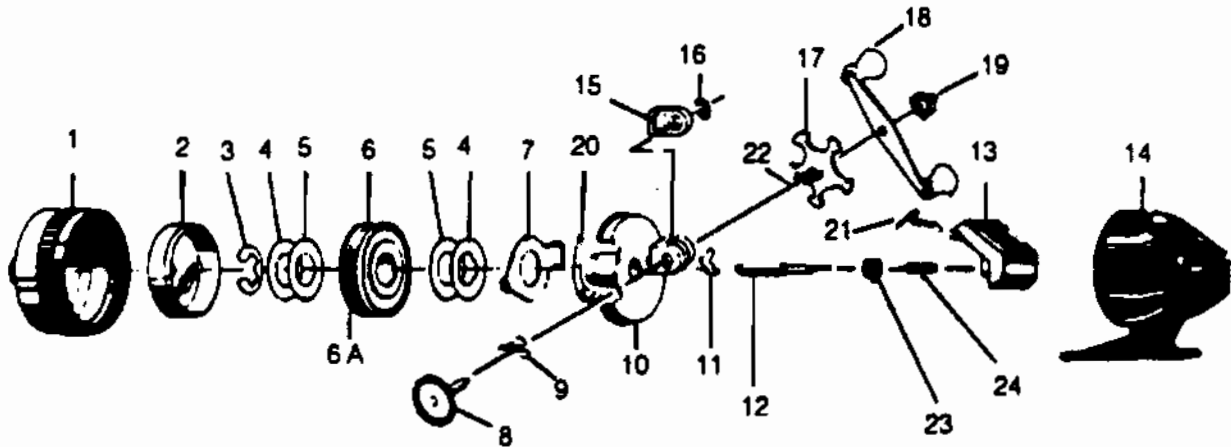

| Key No. | Part No. | Description             |
|---------|----------|-------------------------|
| 1       | JY324-13 | FRONT COVER             |
| 2       | JY310    | SPINNERHEAD             |
| 3       | JY034    | SPOOL CLIP              |
| 4       | JY040    | SPOOL WASHER            |
| 5       | JY108    | FLAT WASHER, DRAG       |
| 6       | JY321-8H | WOUND SPOOL 8# MONO HP  |
| 6A      |          |                         |
| 7       | NY027    | CLUTCH RING             |
| 8       | JY308    | CRANK GEAR SUB-ASSEMBLY |
| 9       | JY061    | PAWL ACTUATOR           |
| 10      | JY301-1  | BODY                    |
| 11      | JY060    | ANTI-REVERSE PAWL       |
| 12      | JY015-2  | CENTER SHAFT            |
| 13      | KY009    | THUMB STOP              |
| 14      | JY323-6  | BACK COVER              |
| 15      | JY054    | SLIDE DRAG ACTUATOR     |
| 16      | JY121    | RETAINER SLIP           |
| 17      | JY032-1  | DRAG STAR               |
| 18      | KZ318-2  | CRANK HANDLE S/A        |
| 19      | AZ003    | CRANK NUT               |
| 20      | RY033    | RATCHET SPRING          |
| 21      | QY038    | THUMB STOP SPRING       |
| 22      | WY026    | CRANK SHAFT BUSHING     |
| 23      | JY011    | PINION GEAR             |
| 24      | JY020-2  | CENTER SHAFT SPRING     |

WWW.REELDR.COM

Prices subject to change without notice. Prices do not include postage and handling.

**PLEASE ORDER BY PART NUMBER**

Rev. 5/93

Zebco Division Brunswick Corporation, Box 270, Tulsa, OK 74101 USA 918-836-5581

