

# QUANTUM QG100, QG200, QG300

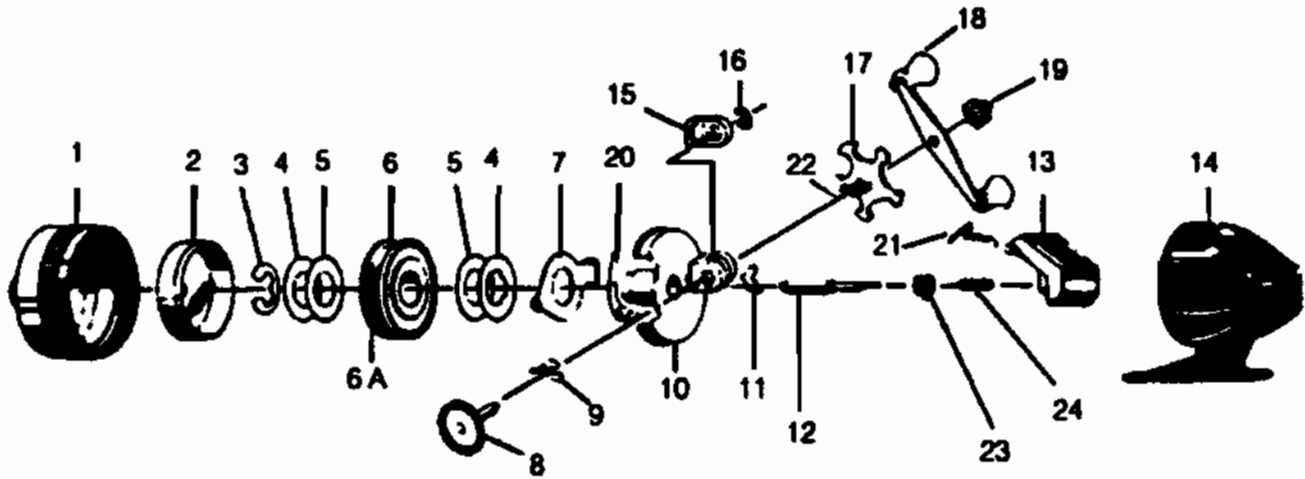

[WWW.REELDR.COM](http://WWW.REELDR.COM)

**Key**

- | No.  | Description           |
|------|-----------------------|
| 1    | Front Cover Assy      |
| 2    | Spinnerhead           |
| 3    | Spool Clip            |
| 4    | Spool Washer (Metal)  |
| 5    | Flat Washer           |
| *6A  | Spool Lip Washer      |
| 6    | Spool w/Hi-Perf. Line |
| 7    | Clutch Ring           |
| 8    | Crank Gear Assy       |
| 9    | Pawl Actuator         |
| 10   | Body Assembly         |
| 11   | Anti-Reverse Pawl     |
| **12 | Center Shaft          |
| 13   | Thumb Stop            |
| 14   | Back Cover Assy       |
| 15   | Slide Drag Actuator   |
| 16   | Retainer Clip         |
| 17   | Drag Star             |
| 18   | Handle Assy           |
| 19   | Crank Nut             |
| 20   | Ratchet Spring        |
| 21   | Thumb Stop Spring     |
| 22   | Crank Shaft Bushing   |
| 23   | Pinion Gear           |
| 24   | Center Shaft Spring   |

**Model**

- |              |
|--------------|
| <b>QG100</b> |
| QY324-6      |
| QY310        |
| XZ034        |
| BJ040        |
| BJ108        |
| QY036        |
| QY321-6H     |
| QY027        |
| QY308        |
| JY061        |
| QY301-1      |
| JY060        |
| QY315        |
| TY009        |
| QY323-6      |
| JY054        |
| JY121        |
| QY032-1      |
| SY318-2      |
| AZ003        |
| RY033        |
| QY038        |
| QY026-3      |
| —            |
| —            |

**Model**

- |              |
|--------------|
| <b>QG200</b> |
| JY324-13     |
| JY310        |
| JY034        |
| JY040        |
| JY108        |
| —            |
| JY321-8H     |
| NY027        |
| JY308        |
| JY061        |
| JY301-1      |
| JY060        |
| JY015-2      |
| KY009        |
| JY323-6      |
| JY054        |
| JY121        |
| JY032-1      |
| KZ318-2      |
| AZ003        |
| RY033        |
| QY038        |
| WY026        |
| JY011        |
| JY020-2      |

**Model**

- |              |
|--------------|
| <b>QG300</b> |
| KY324-6      |
| KY310-1      |
| GZ034-1      |
| CJ040-1      |
| CJ108-1      |
| —            |
| KY321-14H    |
| KY027-1      |
| KY308-1      |
| JY061        |
| KY301-1      |
| JY060        |
| KY015-2      |
| KY009        |
| KY323-7      |
| KY054-1      |
| JY121        |
| KY032-1      |
| KZ318-2      |
| AZ003        |
| —            |
| KY038        |
| KY026-5      |
| JY011        |
| JY020-2      |

\*QG100 only — Key 4 and 5 preceding 6 are replaced by Key 6A.

\*\*QG100 only — Key 12 is an assembly including the spring and pinion gear.

**PLEASE ORDER BY PART NUMBER**

Rev. 2/92

Zebco Division Brunswick Corporation, Box 270, Tulsa, OK 74101 USA 918-836-5581

