

QUANTUM QG100

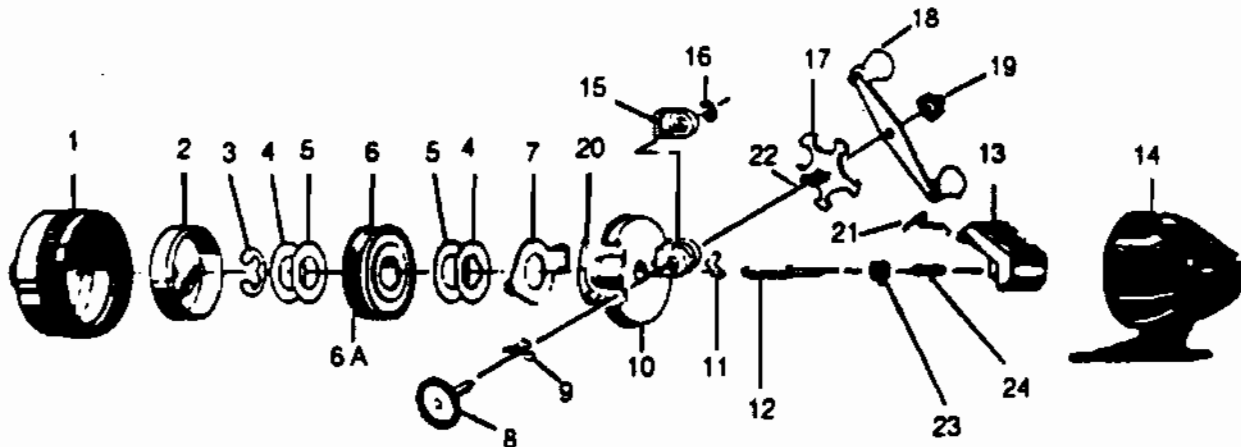

| Key No. | Part No. | Description |
|---------|----------|------------------------|
| 1 | QY324-6 | FRONT COVER ASSY |
| 2 | QY310 | SPINNER HEAD ASSEMBLY |
| 3 | XZ034 | SPOOL CLIP |
| 4 | BJ040 | SPOOL WASHER |
| 5 | BJ108 | FLAT WASHER |
| 6 | QY036 | SPOOL LIP WASHER |
| 6 | QY321-6H | WOUND SPOOL W/ LINE 6# |
| 7 | QY027 | CLUTCH RING |
| 8 | QY308 | CRANK SHAFT ASSEMBLY |
| 9 | JY061 | PAWL ACTUATOR |
| 10 | QY301-1 | BODY ASSEMBLY |
| 11 | JY060 | ANTI-REVERSE PAWL |
| 12 | QY315 | CENTERSHAFT ASSEMBLY |
| 13 | TY009 | THUMB STOP |
| 14 | QY323-6 | BACK COVER ASSY |
| 15 | JY054 | SLIDE DRAG ACTUATOR |
| 16 | JY121 | RETAINER CLIP |
| 17 | QY032-1 | DRAG STAR |
| 18 | SY318-2 | HANDLE ASSY. |
| 19 | AZ003 | CRANK NUT |
| 20 | RY033 | RATCHET SPRING |
| 21 | QY038 | THUMB STOP SPRING |
| 22 | QY026-3 | CRANK SHAFT BUSHING |

WWW.REELDR.COM

Prices subject to change without notice. Prices do not include postage and handling.

PLEASE ORDER BY PART NUMBER

Rev. 5/93

Zebco Division Brunswick Corporation, Box 270, Tulsa, OK 74101 USA 918-836-5581

