

# QUANTUM® QD1610

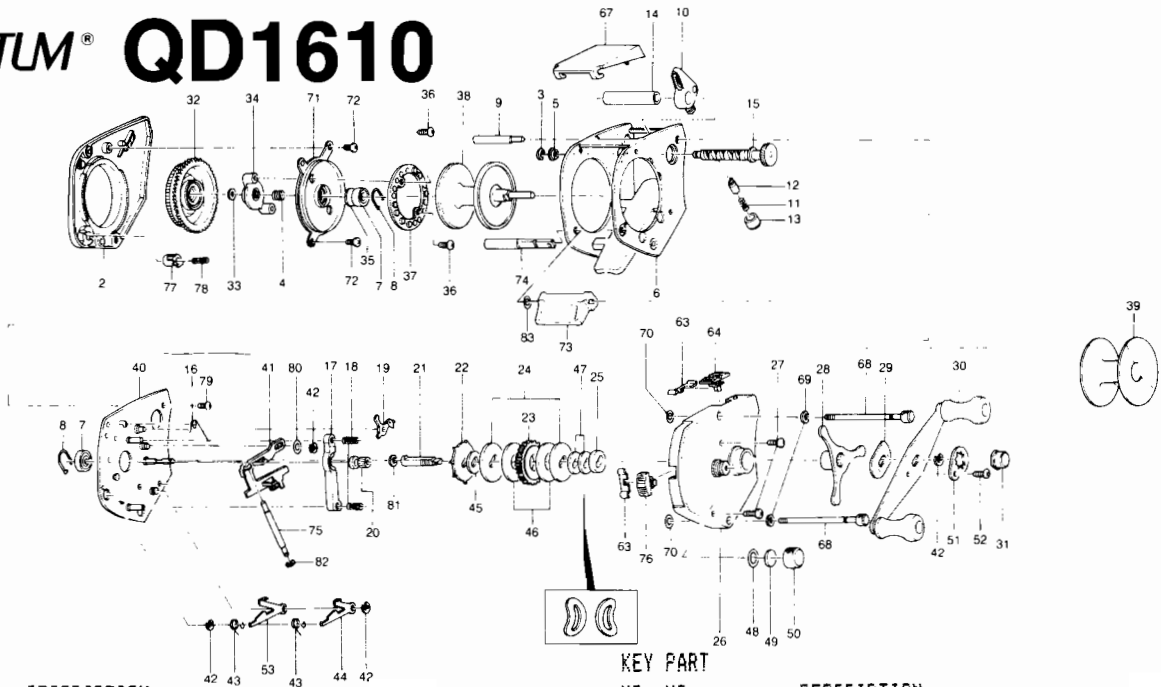

**KEY PART  
NO. NO.**

KEY PART NO. NO.	DESCRIPTION
2 KX4101	LEFT SIDE PLATE
3 CX4152	WORM SHAFT RETAINER
4 CX4301	MAGNET RET. SPRING
5 CX4156	WORM GUARD BUSHING
6 KX4051	FRAME
7 CX4252	SPOOL SHFT BEARING
8 CX4253	BEARING RETAINER
9 KX4159	FRAME POST
10 KX4201	LINE GUIDE
11 CX4203	LINE GUIDE PAWL SPRING
12 CX4202	LINE GUIDE PAWL
13 CX4204	PAWL CAP
14 CX4158	WORM SHAFT GUARD-BLK
15 KX4151	WORM SHAFT
16 KX4502	SPOOL REL. SPRING
17 KX4401	PINION YOKE
18 CX4403	PINION YOKE SPRING
19 CX4452	ANTI-REV. PAWL
20 CX4256	PINION GEAR
21 KX4652	DRIVE SHAFT
22 CX4451	ANTI-REV. RATCHET
23 CX4651	DRIVE GEAR
24 CX4659	DRAG WASHER B
25 CX4254	DRIVE SHFT BUSH
26 KX4103	RIGHT SIDE PLATE
27 CX4352	RIGHT SIDE COVER SCREW
28 CX4663	STAR DRAG
29 CX4660	HANDLE WASHER
30 CX4701	HANDLE
31 CX4702	HANDLE NUT
32 KX4303	MAG. CONTROL DIAL
33 CX4250	O RING
34 KX4261	MAGNET RET. SUPPORT
35 CX4255	SPOOL TENSION SHIM A
36 CX4602	MAGNET RETAINER SCREW
37 CX4257	MAGNET RETAINER
38 KX4251	SPOOL

**KEY PART  
NO. NO.**

KEY PART NO. NO.	DESCRIPTION
39 CX4260	U SPOOL CONVERTER
40 KX4351	SET PLATE
41 KX4402	SPOOL RELEASE PLATE
42 CX4656	RETAINER CLIP
43 KX4353	SET PLATE ACT. SPR.
44 KX4503	SET PLATE ACT. "B"
45 CX4658	BASE DRAG WASHER
46 CX4661	DRAG WASHER A
47 CX4662	DRIVE SHAFT SPR. WSHR
48 CX4258	O RING
49 CX4302	SPOOL TENSION SHIM B
50 CX4259	SPOOL TENSION KNOB
51 CX4703	HANDLE NUT LOCK
52 CX4704	HANDLE NUT LOCK SCREW
53 KX4501	SET PLATE ACT. "A"
63 FX4455	ANTI-REV. LVR. PLATE
64 FX4456	ANTI-REV. LEVER
67 KX4100	LEVEL WIND HOOD
68 KX4102	SIDE PLATE SCREW
69 KX4110	L-SIDE PLT. SCR. WSHR.
70 KX4264	O-RING
71 KX4107	SPOOL COVER B
72 KX4252	SPOOL COVER SCREW
73 KX4406	SPOOL REL. LEVER
74 KX4404	SPOOL RELEASE SHAFT
75 KX4405	TRIP ARM
76 KX4506	FLIPPIN LEVER
77 KX4305	DIAL LOCK BUTTON
78 KX4304	DIAL LOCK BUTTON SPR.
79 KX4052	FRAME POST SCREW
80 KX4408	SPOOL REL. PLT. WSHR.
81 KX4653	DRIVE SHAFT WSHR
82 KX4407	TRIP ARM RETAINER
83 KX4409	SPOOL REL. LVR. WSHR.
KX4000	SPARE PARTS KIT W/WRENCH

WWW.REELDR.COM

Prices subject to change without notice. Prices do not include postage and handling.

**PLEASE ORDER BY PART NUMBER**

Rev. 9/88

Zebco Division Brunswick Corporation, Box 270, Tulsa, OK 74101 USA 918-836-5581

