

# QUANTUM QD1420/QD420

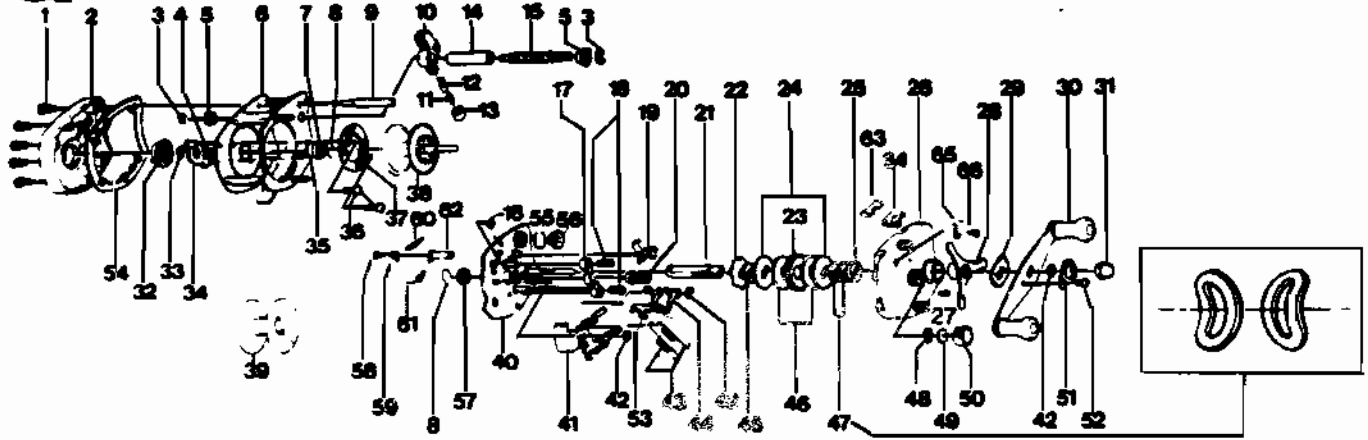

KEY PART		QD1420	
NO.	NO.	DESCRIPTION	
1	CX4102	LEFT SIDE PLATE SCREW	
2	CX4101	LEFT SIDE PLATE	
3	CX4152	WORM SHAFT RETAINER	
4	CX4301	MAGNET RET. SPRING	
5	CX4156	WORM GUARD BUSHING	
6	FX4051	FRAME	
7	CX4252	SPOOL SHFT BEARING	
8	CX4253	BEARING RETAINER	
9	FX4159	FRAME POST BLACK	
10	CX4201	LINE GUIDE	
11	CX4203	LINE GUIDE PAWL SPRING	
12	CX4202	LINE GUIDE PAWL	
13	CX4204	PAWL CAP	
14	FX4158	WORM SHAFT GUARD-BLK	
15	FX4151	WORM SHAFT	
16	CX4502	SPOOL RELEASE SPRING	
17	CX4401	PINION YOKE	
18	CX4403	PINION YOKE SPRING	
19	CX4452	ANTI-REV. PAWL	
20	NX4256	PINION GEAR	
21	CX4652	DRIVE SHAFT	
22	CX4451	ANTI-REV. RATCHET	
23	NX4651	DRIVE GEAR	
24	CX4659	DRAG WASHER B	
25	CX4254	DRIVE SHFT BUSH	
26	FX4103	RIGHT SIDE PLATE	
27	CX4352	RIGHT SIDE COVER SCREW	
28	CX4663	STAR DRAG	
29	CX4660	HANDLE WASHER	
30	CX4701	HANDLE	
31	CX4702	HANDLE NUT	
32	CX4303	MAGNETIC CONTROL DIAL	
33	CX4250	O RING	
34	CX4261	MAGNET RET. SUPPORT	
35	CX4255	SPOOL TENSION SHIM A	
36	CX4602	MAGNET RETAINER SCREW	
37	CX4257	MAGNET RETAINER	
38	FX4251	SPOOL	
39	FX4260	U SPOOL CONVERTER	
40	FX4351	SET PLATE	
41	CX4402	SPOOL RELEASE BUTTON	
42	CX4656	RETAINER CLIP	
43	FX4353	SET PLATE ACT SPRING	
44	FX4503	SET PLATE ACT. B	
45	CX4658	BASE DRAG WASHER	
46	CX4661	DRAG WASHER A	
47	CX4662	DRIVE SHAFT SPR. WSHR	
48	CX4258	O RING	
49	CX4302	SPOOL TENSION SHIM B	
50	CX4259	SPOOL TENSION KNOB	
51	CX4703	HANDLE NUT LOCK	
52	CX4704	HANDLE NUT LOCK SCREW	
53	FX4501	SET PLATE ACTUATOR	
54	CX4107	LEFT PLATE SPACER-WH.	
55	CX4153	GEAR RETAINING CLIP	
56	NX4150	WORM SHAFT GEAR	
57	CX4252	SPOOL SHFT BEARING	
58	FX4552	CLICK PAWL SCREW	
59	FX4551	CLICK PAWL	
60	FX4553	CLICK PAWL SPRING	
61	FX4556	CLICK CAM SPRING	
62	FX4557	CLICK CAM	
63	FX4455	ANTI-REV. LVR. PLATE	
64	FX4456	ANTI-REV. LEVER	
65	FX4558	BAIT CLICK LEVER	
66	FX4559	BAIT CLICK LEVER SCREW	

KEY PART		QD420	
NO.	NO.	DESCRIPTION	
	CX4000	SPARE PARTS W/WRENCH	
1	CX4102	LEFT SIDE PLATE SCREW	
2	CX4101	LEFT SIDE PLATE	
3	CX4152	WORM SHAFT RETAINER	
4	CX4301	MAGNET RET. SPRING	
5	CX4156	WORM GUARD BUSHING	
6	FX4051	FRAME	
7	BX4156	SPOOL SHAFT BUSHING	
8	CX4253	BEARING RETAINER	
9	EX4159	FRAME POST SILVER	
10	CX4201	LINE GUIDE	
11	CX4203	LINE GUIDE PAWL SPRING	
12	CX4202	LINE GUIDE PAWL	
13	CX4204	PAWL CAP	
14	EX4158	WORM SHFT GUARD-SILVER	
15	FX4151	WORM SHAFT	
16	CX4502	SPOOL RELEASE SPRING	
17	CX4401	PINION YOKE	
18	CX4403	PINION YOKE SPRING	
19	CX4452	ANTI-REV. PAWL	
20	NX4256	PINION GEAR	
21	CX4652	DRIVE SHAFT	
22	CX4451	ANTI-REV. RATCHET	
23	NX4651	DRIVE GEAR	
24	CX4659	DRAG WASHER B	
25	CX4254	DRIVE SHFT BUSH	
26	EX4103	RIGHT SIDE PLATE	
27	CX4352	RIGHT SIDE COVER SCREW	
28	CX4663	STAR DRAG	
29	CX4660	HANDLE WASHER	
30	CX4701	HANDLE	
31	CX4702	HANDLE NUT	
32	CX4303	MAGNETIC CONTROL DIAL	
33	CX4250	O RING	
34	CX4261	MAGNET RET. SUPPORT	
35	CX4255	SPOOL TENSION SHIM A	
36	CX4602	MAGNET RETAINER SCREW	
37	CX4257	MAGNET RETAINER	
38	FX4251	SPOOL	
39	FX4260	U SPOOL CONVERTER	
40	FX4351	SET PLATE	
41	CX4402	SPOOL RELEASE BUTTON	
42	CX4656	RETAINER CLIP	
43	FX4353	SET PLATE ACT SPRING	
44	FX4503	SET PLATE ACT. B	
45	CX4658	BASE DRAG WASHER	
46	CX4661	DRAG WASHER A	
47	CX4662	DRIVE SHAFT SPR. WSHR	
48	CX4258	O RING	
49	CX4302	SPOOL TENSION SHIM B	
50	CX4259	SPOOL TENSION KNOB	
51	CX4703	HANDLE NUT LOCK	
52	CX4704	HANDLE NUT LOCK SCREW	
53	FX4501	SET PLATE ACTUATOR	
54	BX4107	LEFT PLATE SPACER-RED	
55	CX4153	GEAR RETAINING CLIP	
56	NX4150	WORM SHAFT GEAR	
57	BX4157	SPOOL SHAFT BUSHING B	
58	FX4552	CLICK PAWL SCREW	
59	FX4551	CLICK PAWL	
60	FX4553	CLICK PAWL SPRING	
61	FX4556	CLICK CAM SPRING	
62	FX4557	CLICK CAM	
63	FX4455	ANTI-REV. LVR. PLATE	
64	FX4456	ANTI-REV. LEVER	
65	FX4558	BAIT CLICK LEVER	
66	FX4559	BAIT CLICK LEVER SCREW	

WWW.REELDR.COM

Prices subject to change without notice. Prices do not include postage and handling. **PLEASE ORDER BY PART NUMBER**

Rev. 11/90