

# QUANTUM QB6

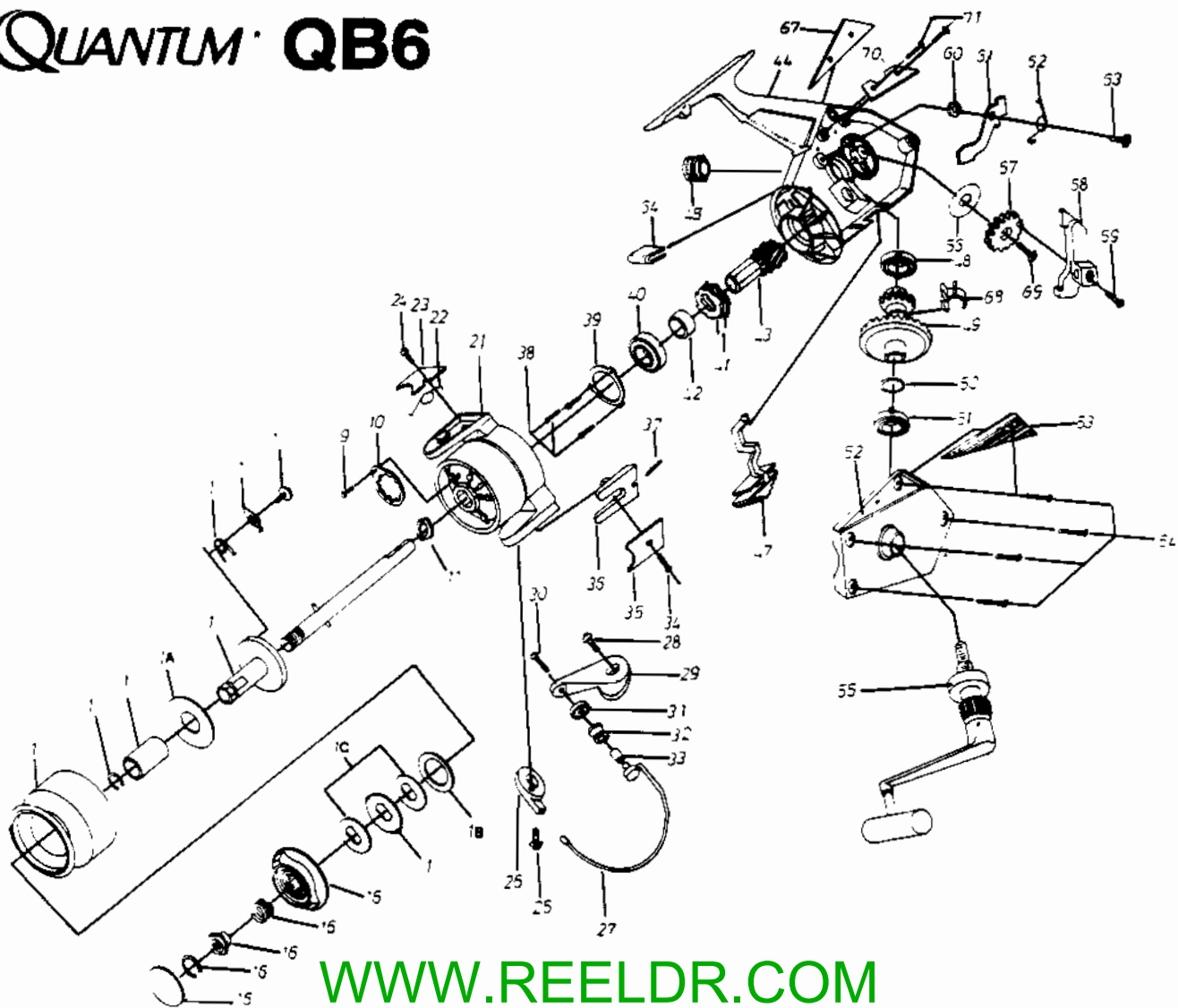

[WWW.REELDR.COM](http://WWW.REELDR.COM)

## KEY PART

NO.	NO.	DESCRIPTION
1C	WK039	DRAG WASHER 'B'
1B	WK046	DRAG WASHER 'C'
1A	WK163	SPOOL RETAINER BUSHING
1	XK321	SPOOL ASSY.
9	UK058	NUT RING SCREW
10	WK088	ROTOR NUT RING
11	WK006	ROTOR NUT
12	WK315	CENTER SHAFT
16	WK050	DRAG KNOB ASSY.
21	XK009	ROTOR
22	WK022	ARM LEVER SPRING
23	WK087	ARM LEVER COVER
24	UK085	ARM LEVER COVER SCREW
25	UK048	BAIL HOLDER SCREW
26	WK345	BAIL HOLDER
27	XK346	BAIL WIRE
28	UK051	ARM LEVER SCREW
29	WK007	ARM LEVER
30	UK108	LINE SLIDER SCREW
31	WK017	LINE SLIDER COLLAR
32	WK004	LINE ROLLER
33	UK016	LINE ROLLER BUSHING
34	UK037	BAIL HOLDER COVER SCREW
35	WK024	BAIL HOLDER COVER
36	WK019	KICK LEVER
37	UK049	KICK LEVER SPRING
38	UK080	BEARING COVER SCREW
39	WK040	BEARING COVER
40	WK028	PINION BEARING

## KEY PART

NO.	NO.	DESCRIPTION
41	WK060	STOPPER GEAR
42	WK126	PINION COLLAR
43	WK011	PINION
44	XK301	BODY
45	WK073	DUST COVER
47	WK059	ANTI-REVERSE SWITCH
48	WK013	BODY BUSHING
49	WK012	CRANK GEAR
50	WK026	CRANK GEAR WASHER
51	WK164	SIDE PLATE BUSHING
52	XK323	SIDE PLATE
53	WK324	GROOVE PART 'L'
54	WK057	SIDE PLATE SCREW
55	WK318	HANDLE ASSY.
56	WK165	OSC. GUIDE WASHER
57	WK053	OSCILLATOR GEAR
58	WK025	OSCILLATOR GUIDE
59	WK084	CENTER SHAFT SCREW
60	WK014	STOPPER SUPPORT BUSHING
61	WK063	STOPPER
62	WK061	STOPPER SPRING
63	UK089	STOPPER SCREW
64	UK166	STOPPER SUPPORT
67	WK325	GROOVE PART 'R'
68	WK086	SLIDING SPRING
69	WK078	OSC. GEAR SCREW
70	WK167	OSC. GUIDE SUPPORT
71	UK168	OSC. SUPPORT SCREW

Prices subject to change without notice. Prices do not include postage and handling.

**PLEASE ORDER BY PART NUMBER**

Rev. 11/90

Zebco Division Brunswick Corporation, Box 270, Tulsa, OK 74101 USA 918-836-5561

