

QUANTUM QB5

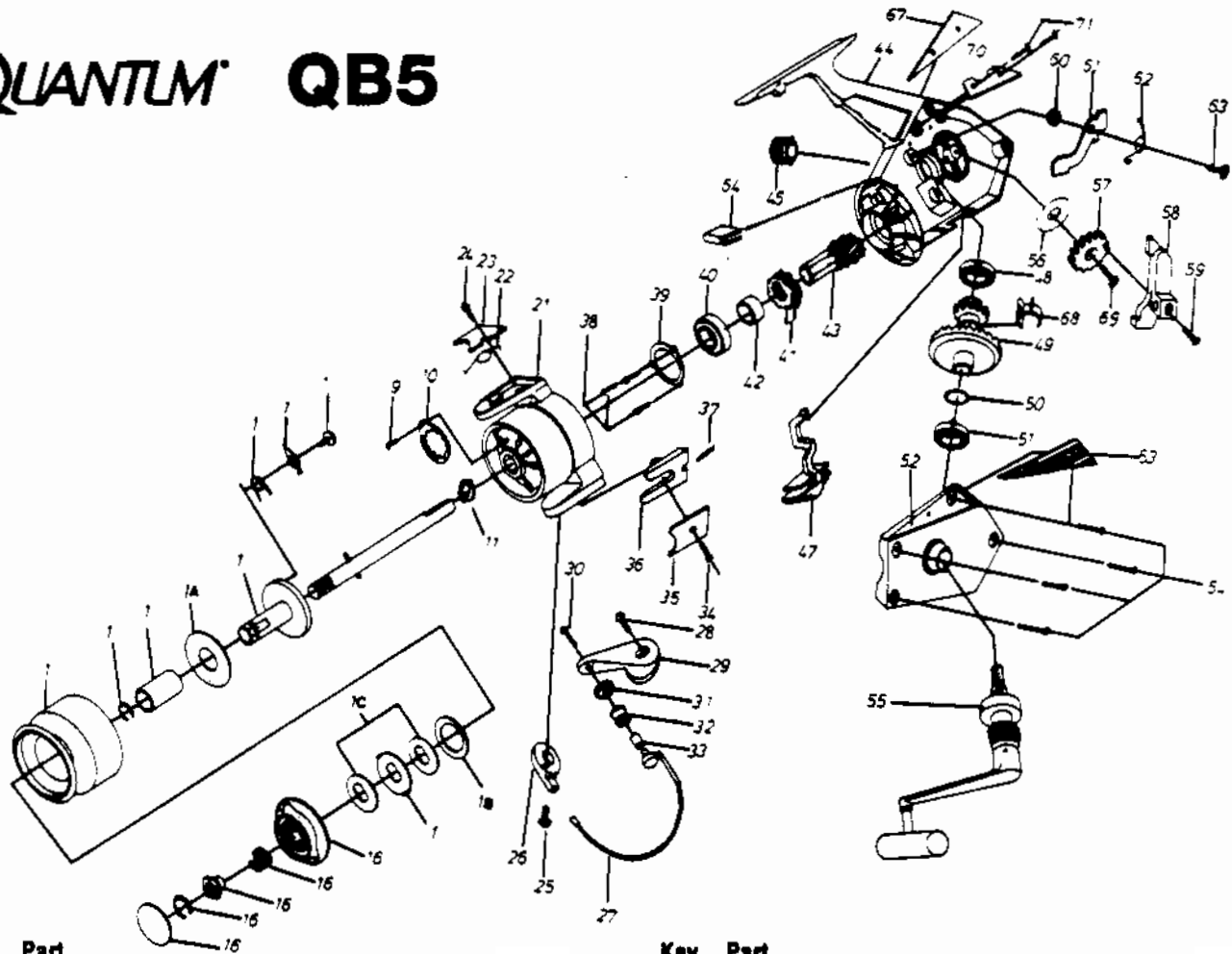

| Key No. | Part No. | Description |
|---------|----------|-------------------------|
| | WK039 | DRAG WASHER 'B' |
| | WK046 | DRAG WASHER 'C' |
| | WK163 | SPOOL RETAINER BUSHING |
| 1 | WK321 | SPOOL ASSY. |
| 9 | UK058 | NUT RING SCREW |
| 10 | WK088 | ROTOR NUT RING |
| 11 | WK006 | ROTOR NUT |
| 12 | WK315 | CENTER SHAFT |
| 16 | WK050 | DRAG KNOB ASSY. |
| 21 | WK009 | ROTOR |
| 22 | WK022 | ARM LEVER SPRING |
| 23 | WK087 | ARM LEVER COVER |
| 24 | UK084 | CENTER SHAFT SCREW |
| 25 | UK048 | BAIL HOLDER SCREW |
| 26 | WK345 | BAIL HOLDER |
| 27 | WK346 | BAIL WIRE |
| 28 | UK051 | ARM LEVER SCREW |
| 29 | WK007 | ARM LEVER |
| 30 | UK108 | LINE SLIDER SCREW |
| 31 | WK017 | LINE SLIDER COLLAR |
| 32 | WK004 | LINE ROLLER |
| 33 | UK016 | LINE ROLLER BUSHING |
| 34 | UK037 | BAIL HOLDER COVER SCREW |
| 35 | WK024 | BAIL HOLDER COVER |
| 36 | WK019 | KICK LEVER |
| 37 | UK049 | KICK LEVER SPRING |
| 38 | UK080 | BEARING COVER SCREW |
| 40 | WK028 | PINION BEARING |
| 41 | WK060 | STOPPER GEAR |

WWW.REELDR.COM

| Key No. | Part No. | Description |
|---------|----------|-------------------------|
| 42 | WK126 | PINION COLLAR |
| 43 | WK011 | PINION |
| 44 | WK301 | BODY |
| 45 | WK073 | DUST COVER |
| 47 | WK059 | ANTI-REVERSE SWITCH |
| 48 | WK013 | BODY BUSHING |
| 49 | WK012 | CRANK GEAR |
| 50 | WK026 | CRANK GEAR WASHER |
| 51 | WK164 | SIDE PLATE BUSHING |
| 52 | WK323 | SIDE PLATE |
| 53 | WK324 | GROOVE PART 'L' |
| 54 | WK057 | SIDE PLATE SCREW |
| 55 | WK318 | HANDLE ASSY. |
| 56 | WK165 | OSC. GUIDE WASHER |
| 57 | WK053 | OSCILLATOR GEAR |
| 58 | WK025 | OSCILLATOR GUIDE |
| 59 | WK084 | CENTER SHAFT SCREW |
| 60 | WK014 | STOPPER SUPPORT BUSHING |
| 61 | WK063 | STOPPER |
| 62 | WK061 | STOPPER SPRING |
| 63 | UK089 | STOPPER SCREW |
| 64 | UK166 | STOPPER SUPPORT |
| 67 | WK325 | GROOVE PART 'R' |
| 68 | WK086 | SLIDING SPRING |
| 69 | WK078 | OSC. GEAR SCREW |
| 70 | WK167 | OSC. GUIDE SUPPORT |
| 71 | UK168 | OSC. SUPPORT SCREW |

Prices subject to change without notice. Prices do not include postage and handling.

PLEASE ORDER BY PART NUMBER

Rev. 5/93

Zebco Division Brunswick Corporation, Box 270, Tulsa, OK 74101 USA 918-836-5581

