

QUANTUM LS2

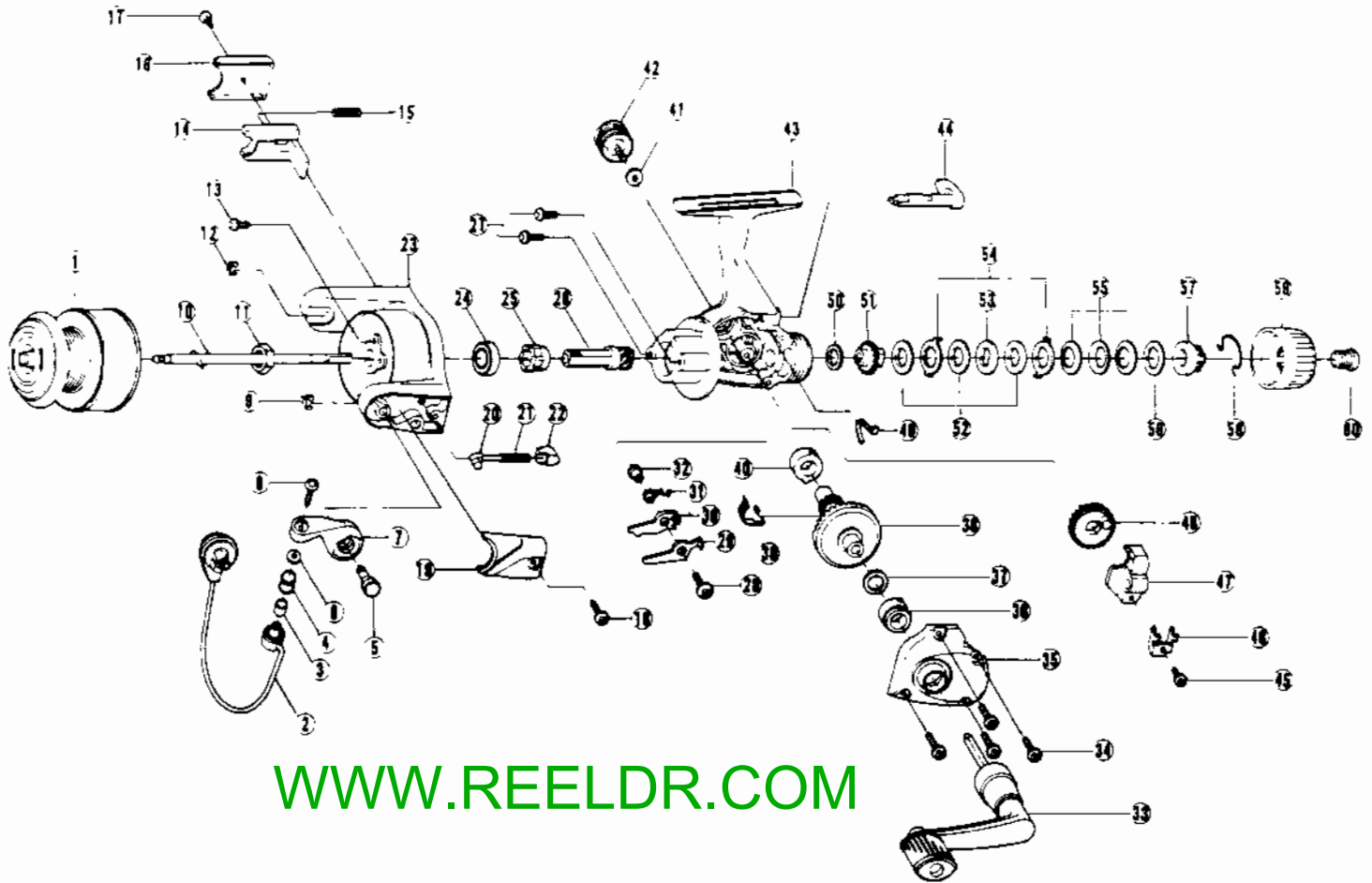

WWW.REELDR.COM

KEY NO.	PART NO.	DESCRIPTION	KEY NO.	PART NO.	DESCRIPTION	KEY NO.	PART NO.	DESCRIPTION
1	JU321-4	Spool Ass'y	21	KQ049-3	Arm Lever Spring	42	GU073	Handle Screw Cap
2	GU347-6	Bail Ass'y	22	QL020	Arm Lever Spring Holder	43	HU001-2	Body
3	MT016-2	Line Roller Bushing	23	HU009-2	Rotor	44	GU090	Stopper Lever
4	MT004	Line Roller	24	AQ028	Ball Bearing	45	JU100	Oscillator Retainer Screw
5	GU051-4	Arm Lever Pin	25	PL060	Ratchet Gear	46	HU078	Oscillator Slider Retainer
6	GU105-7	Line Roller Washer	26	GU011-2	Pinion Gear	47	HU025	Oscillator Slider
7	NU007	Arm Lever	27	GU077	Bearing Screw	48	HU053	Oscillation Gear
8	KQ108	Bail Screw	28	GU077-5	Stopper Screw	49	GU089	Stopper Lever Spring
9	KQ034	"E" Clip	29	GU063	Stopper "A"	50	GU105-22	Drag Friction Washer
10	JU315-2	Main Shaft Ass'y	30	GU074	Stopper "B"	51	HU075	Metal
11	GU006	Rotor Nut	31	GU061	Stopper Spring	52	GU105-23	Drag "B" Washer
12	KQ034	"E" Clip	32	GU091	Stopper Bushing	53	HU080	Drag "D" Washer
13	GU077-4	Rotor Nut Lock Screw	33	GU318-6	Handle Ass'y	54	HU081	Drag "A" Washer
14	MU019	Kick Lever	34	GU057	Body Cover Screw	55	HU043	Drag Spring
15	KQ049	Kick Lever Spring	35	HU023-2	Body Cover	56	GU105-24	Drag Adj. Washer
16	HU046	Kick Lever Cover	36	GU027	Body Cover Bushing	57	HU066	Drag Nut
17	GU077-2	Kick Lever Cover Screw	37	GU105-8	Drive Gear Adj. Washer	58	RL033	Drag Click Claw
18	GU077-2	Arm Lever Spring Cover Screw	38	GU012	Drive Gear	59	HU032	Drag Knob
19	MU087	Arm Lever Spring Cover	39	GU086	Silent Cam	60	HU101	Drag Knob Screw
20	NL031	Spring Shaft	40	GU027	Body Bushing			
			41	GU105	Handle Cap Washer			

PLEASE ORDER BY PART NUMBER

Rev. 7/92

Zebco Division Brunswick Corporation, Box 270, Tulsa, OK 74101 USA 918-836-5581

