

QUANTUM LS1

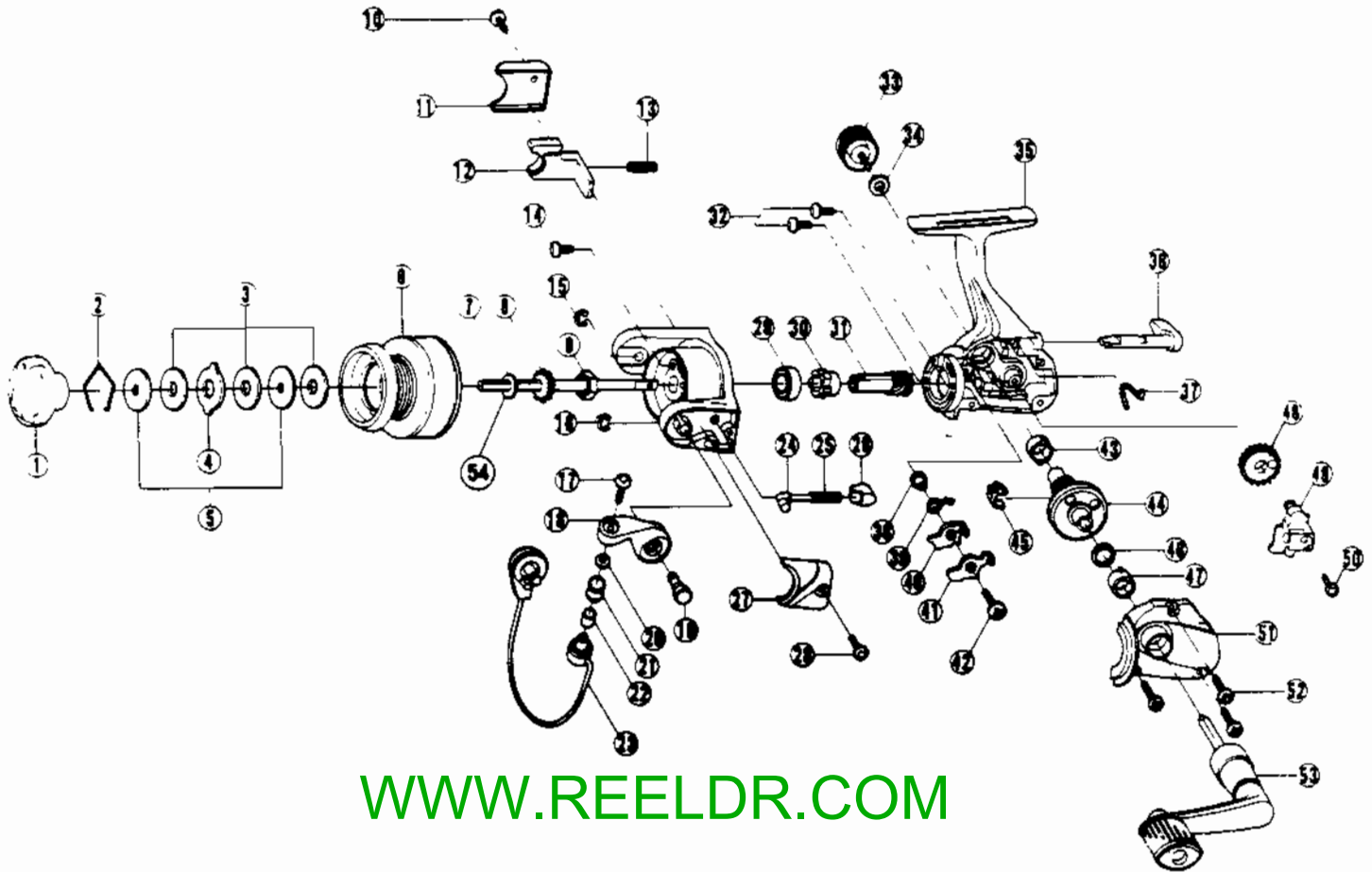

WWW.REELDR.COM

KEY NO.	PART NO.	DESCRIPTION	KEY NO.	PART NO.	DESCRIPTION	KEY NO.	PART NO.	DESCRIPTION
1	GU332-2	Drag Knob Ass'y	20	GU105-7	Line Roller Washer	38	GU091	Stopper Bushing
2	GU038	Drag Retainer	21	MT004	Line Roller	39	GU061	Stopper Spring
3	GU105-5	Spool Washer "B"	22	MT016-2	Line Roller Bushing	40	GU063	Stopper "A"
4	GU081	Spool Washer "A"	23	GU347-2	Bail Ass'y	41	GU074	Stopper "B"
5	GU080	Spool Washer "D"	24	KQ031	Spring Shaft	42	GU077-5	Stopper Screw
6	GU321-2	Spool Ass'y	25	KQ049-3	Arm Lever Spring	43	GU027	Body Bushing
7	GU105-6	Spool Washer	26	QL020	Spring Holder	44	GU012	Drive Gear
8	GU037	Spool Click Claw	27	LU087	Arm Lever Spring Cover	45	GU086	Silent Cam
9	GU006	Rotor Nut	28	GU077-2	Arm Lever Spring Cover Screw	46	GU105-8	Drive Gear Adj. Washer
10	GU077-2	Kick Lever Cover Screw	29	AQ028	Bail Bearing	47	GU027	Body Cover Bushing
11	GU046	Kick Lever Cover	30	PL060	Ratchet Gear	48	GU053	Oscillation Gear
12	GU019	Kick Lever	31	GU011	Pinion Gear	49	GU025	Oscillation Slider
13	KQ049	Kick Lever Spring	32	GU077	Bearing Screw	50	GU100	Main Shaft Screw
14	GU077-4	Rotor Nut Lock Screw	33	GU073	Handle Screw Cap	51	GU023-2	Body Cover
15	KQ034	"E"-Clip	34	GU105	Handle Cap Washer	52	GU057	Body Cover Screw
16	KQ034	"E"-Clip	35	GU001-2	Body	53	GU318-2	Handle Ass'y
17	KQ108	Bail Screw	36	GU090	Stopper Lever	54	GU015	Main Shaft
18	LU007	Arm Lever	37	GU089	Stopper Lever Spring			
19	GU051-2	Arm Lever Pin						

PLEASE ORDER BY PART NUMBER

Rev. 7/92

Zebco Division Brunswick Corporation, Box 270, Tulsa, OK 74101 USA 918-836-5581

