

# QUANTUM

# X400

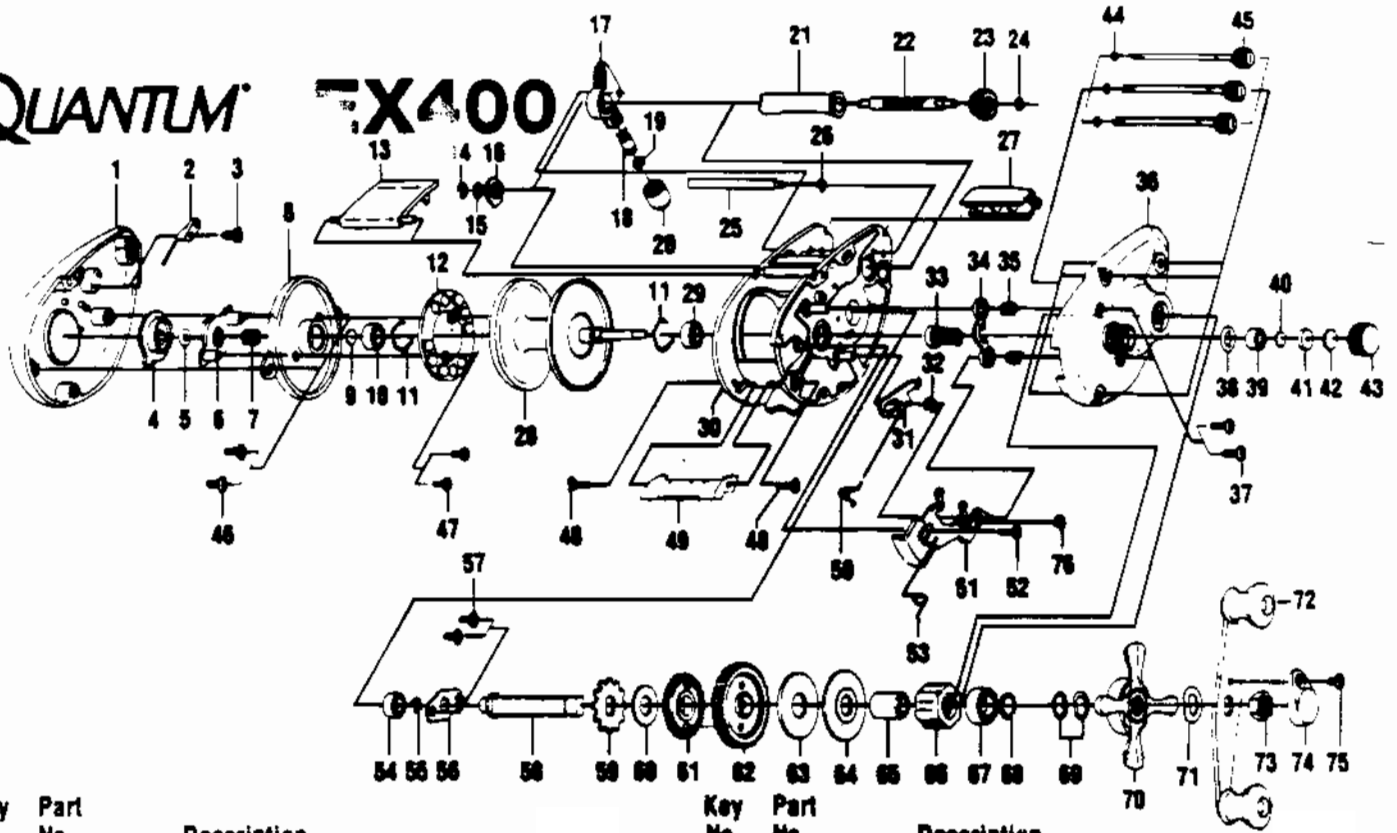

Key No.	Part No.	Description	Key No.	Part No.	Description
1	RW023	LEFT SIDE COVER	39	SW117	BEARING
2	QW108	CLICKER	40	QW032-1	SPOOL TENSION KNOB
3	QW125	SPOOL COVER SCREW	41	QW081	COLLAR
4	QW026	MAGNET CONTROL DIAL	42	QW082	SPOOL CUSHION WASHER
5	CX4250	O RING	43	QW033	SPOOL TENSION KNOB
6	QW028	SLIDE CAM	44	QW073	RING-THUMB SCREW RET.
7	CX4301	MAGNET RET. SPRING	45	QW374	THUMB SCREW
8	QW051	SPOOL COVER	46	QW125	SPOOL COVER SCREW
9	QW032-1	SPOOL TENSION KNOB	47	QW076	SCREW
10	SW017	CRANK SHAFT BEARING	48	QW050	THUMB REST SCREW
11	QW080	P RING	49	QW009	THUMB REST
12	QW330	MAGNET PLATE ASSY	50	QW097	KICK LEVER SPRING
13	RW027	WASHER	51	QW339	RELEASE SLIDER ASSY
14	ZX4657	RETAINER CLIP	52	QW057	RELEASE SLIDER SCREW
15	QW035-3	WASHER - WORM SHAFT	53	UW104	RELEASE SLIDER SPRING
16	QW067	WORM SHAFT BUSHING	54	QW017	CRANK SHAFT BEARING
17	QW347	LINE GUIDE CARRIER	55	CX4152	WORM SHAFT RETAINER
18	QW006	LINE GUIDE PAWL	56	QW002	CRANK SHAFT RETAINER
20	QW007	LINE GUIDE CARRIER SCREW	57	QW107	CRANK SHAFT RET. SCREW
21	QW016	WORM SHAFT GUIDE	58	QW008	CRANK SHAFT
22	QW072	WORM SHAFT	59	QW083	TRIP RATCHET
23	QW085	LEVEL WIND GEAR	60	QW111	WASHER
24	VX4243	E-CLIP	61	QW112	GEAR - L/W IDLER
25	QW061	STABILIZER BAR	62	QW012	DRIVE GEAR
26	VX4243	E-CLIP	63	QW059	DRAG DISC
27	RW099	FRONT SUPPORT	64	QW045	DRAG WASHER
28	QW321	SPOOL ASSY	65	QW052	CLUTCH SLEEVE
29	SW017	CRANK SHAFT BEARING	66	QW063	ANTI-REVERSE CLUTCH
30	QW001	FRAME	67	TW058	BEARING - CRANK SHAFT TOP
31	QW077	KICK LEVER	68	QW035	CRANK SHAFT WASHER
32	CX4152	WORM SHAFT RETAINER	69	CX4662	DRIVE SHAFT SPR. WSHR
33	QW311	PINION GEAR	70	QW055	DRAG STAR
34	QW025	PINION YOKE	71	CX4660	HANDLE WASHER
35	QW040	PINION YOKE SPRING	72	QW318	HANDLE ASSY
36	RW324	RIGHT SIDE COVER	73	QW003	HANDLE NUT
37	QW053-2	RIGHT SIDE COVER SCREW	74	QW034	HANDLE NUT CAP
38	CX4258	O RING	75	QW123	HANDLE NUT CAP SCREW

WWW.REELDR.COM

Prices subject to change without notice. Prices do not include postage and handling.

**PLEASE ORDER BY PART NUMBER**

Rev 5/93

Zebco Division Brunswick Corporation, Box 270, Tulsa, OK 74101 USA 918-836-5581

