

QUANTUM

EX200

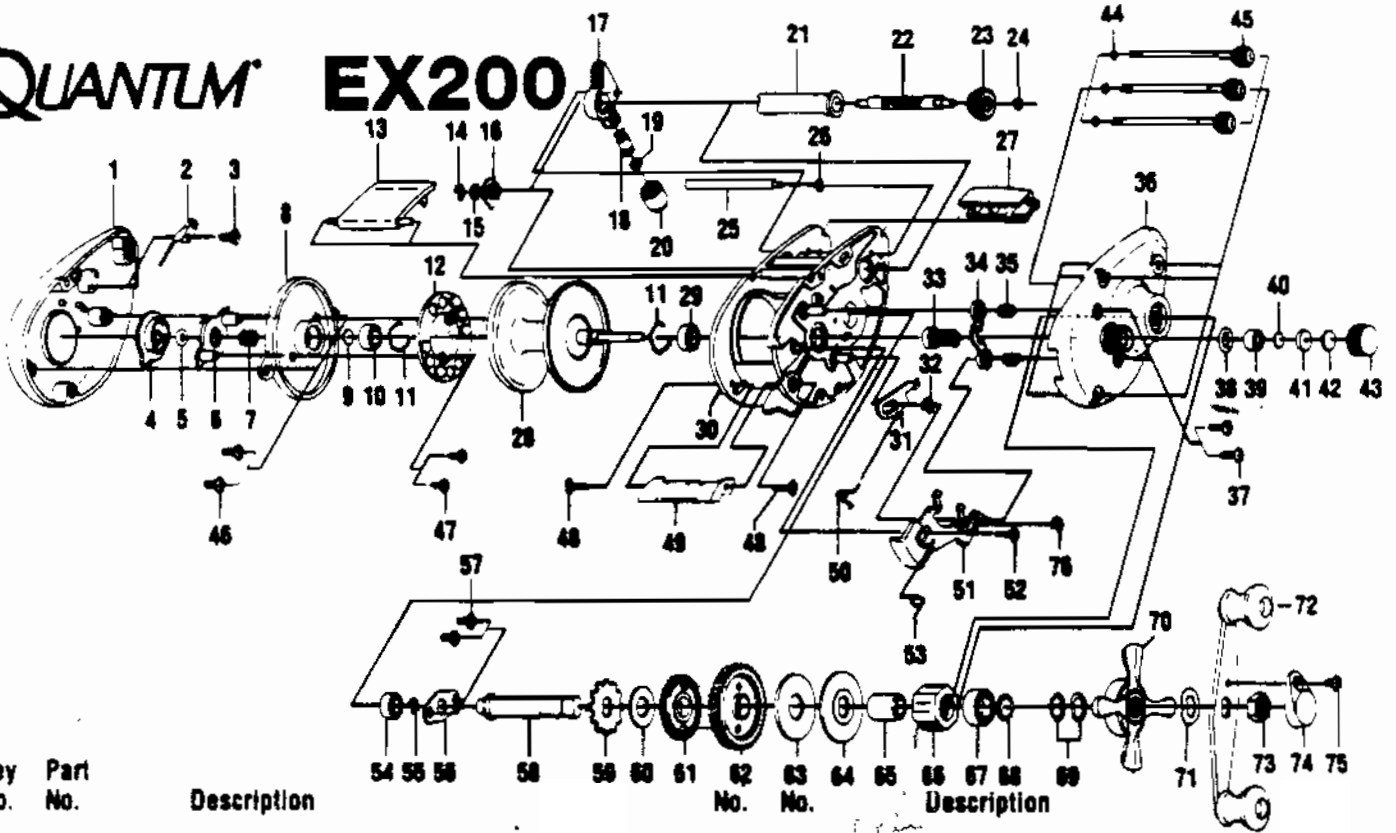

Key No.	Part No.	Description	No.	No.	Description
1	QW023	LEFT SIDE COVER	39	QW117	BEARING
2	QW108	CLICKER	40	QW032-1	SPOOL TENSION KNOB
3	QW125	SPOOL COVER SCREW	41	QW081	COLLAR
4	QW026	MAGNET CONTROL DIAL	42	QW082	SPOOL CUSHION WASHER
5	CX4250	O RING	43	QW033	SPOOL TENSION KNOB
6	QW028	SLIDE CAM	44	QW073	RING-THUMB SCREW RET.
7	CX4301	MAGNET RET. SPRING	45	QW374	THUMB SCREW
8	QW051	SPOOL COVER	46	QW125	SPOOL COVER SCREW
9	QW032-1	SPOOL TENSION KNOB	47	QW076	SCREW
10	QW017	CRANK SHAFT BEARING	48	QW050	THUMB REST SCREW
11	QW080	CLIP RING	49	QW009	THUMB REST
12	QW330	MAGNET PLATE ASSY	50	QW097	KICK LEVER SPRING
13	QW027	HOOD	51	QW339	RELEASE SLIDER ASSY
14	ZX4657	RETAINER CLIP	52	QW057	RELEASE SLIDER SCREW
15	QW035-3	WASHER - WORM SHAFT	53	QW104	RELEASE SLIDER SPRING (COIL)
16	QW067	WORM SHAFT BUSHING	54	QW017	CRANK SHAFT BEARING
17	QW347	LINE GUIDE CARRIER	55	CX4152	WORM SHAFT RETAINER
18	QW006	LINE GUIDE PAWL	56	QW002	CRANK SHAFT RETAINER
19	QW035-3	WASHER - WORM SHAFT	57	QW107	CRANK SHAFT RET. SCREW
20	QW007	LINE GUIDE CARRIER SCREW	58	QW008	CRANK SHAFT
21	QW016	WORM SHAFT GUIDE	59	QW083	TRIP RATCHET
22	QW072	WORM SHAFT	60	QW111	WASHER
23	QW085	LEVEL WIND GEAR	61	QW112	GEAR - LW IDLER
24	VX4243	E-CLIP	62	QW012	DRIVE GEAR
25	QW061	STABILIZER BAR	63	QW059	DRAG DISC
26	VX4243	E-CLIP	64	QW045	DRAG WASHER
27	QW099	FRONT SUPPORT	65	QW052	CLUTCH SLEEVE
28	QW321	SPOOL ASSY	66	QW063	ANTI-REVERSE CLUTCH
29	SW017	CRANK SHAFT BEARING	67	TW058	BEARING - CRANK SHAFT TOP
30	QW001	FRAME	68	QW035	CRANK SHAFT WASHER
31	QW077	KICK LEVER	69	CX4662	DRIVE SHAFT SPR. WSHR
32	CX4152	WORM SHAFT RETAINER	70	QW055	DRAG STAR
33	QW311	PINION GEAR	71	CX4660	HANDLE WASHER
34	QW025	PINION YOKE	72	QW318	HANDLE ASSY
35	QW040	PINION YOKE SPRING	73	QW003	HANDLE NUT
36	QW324	RIGHT SIDE COVER	74	QW034	HANDLE NUT CAP
37	QW053-2	RIGHT SIDE COVER SCREW	75	QW123	HANDLE NUT CAP SCREW
38	CX4258	O RING			

WWW.REELDR.COM

Prices subject to change without notice. Prices do not include postage and handling.

PLEASE ORDER BY PART NUMBER

Rev. 5/93

Zebco Division Brunswick Corporation, Box 270, Tulsa, OK 74101 USA 918-836-5581

