

QUANTUM 621

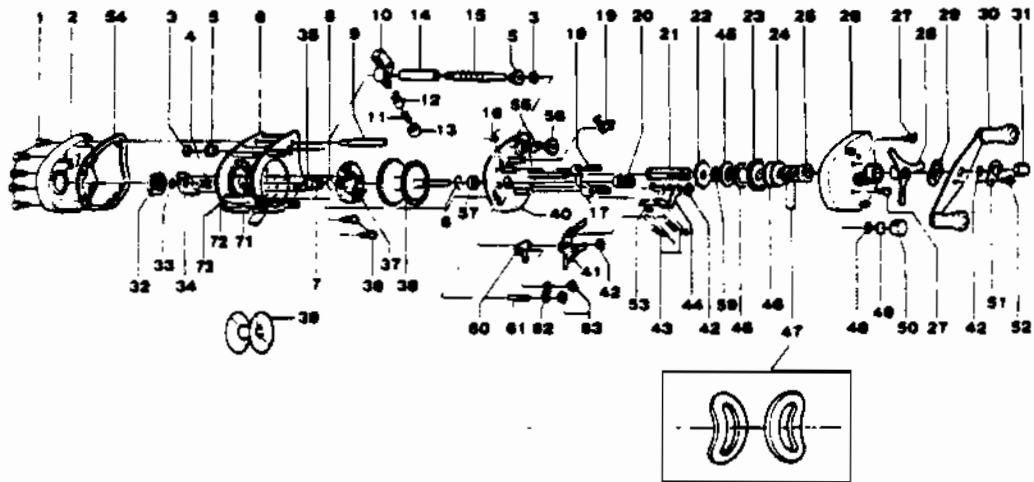

**KEY PART
NO. NO.**

| | |
|-------------|-------------------------|
| PX4100 | LEVEL WIND HOOD |
| ZX009B | THUMB BAR |
| ZX022 | THUMB BAR SPRING |
| ZX041 | THUMB BAR PIN |
| 1 CX4102 | LEFT SIDE PLATE SCREW |
| 2 BW4101 | LEFT SIDE PLATE |
| 3 CX4152 | WORM SHAFT RETAINER |
| 4 CX4301 | MAGNET RET. SPRING |
| 5 CX4156 | WORM GUARD BUSHING |
| 6 BW4051 | FRAME |
| 7 ZX4156 | SPOOL SHAFT BUSHING (L) |
| 8 CX4253 | BEARING RETAINER |
| 9 FX4159 | FRAME POST - BLACK |
| 10 CX4201-1 | LINE GUIDE |
| 11 CX4203 | LINE GUIDE PAWL SPRING |
| 12 CX4202 | LINE GUIDE PAWL |
| 13 CX4204 | PAWL CAP |
| 14 CX4158 | WORM SHAFT GUARD-BLK |
| 15 CX4151-1 | WORM SHAFT W/O GEAR |
| 16 CX4502 | SPOOL RELEASE SPRING |
| 17 CX4401 | PINION YOKE |
| 18 CX4403 | PINION YOKE SPRING |
| 19 CX4452-1 | DOUBLE ANTI-REV PAWL |
| 20 BW4256 | PINION GEAR |
| 21 ZX4652 | DRIVE SHAFT |
| 22 CX4451-1 | RELEASE RATCHET |
| 23 BW4651 | DRIVE GEAR |
| 24 CX4659 | DRAG WASHER B |
| 25 CX4254 | DRIVE SHFT BUSH |
| 26 BW4103 | RIGHT SIDE PLATE |
| 27 CX4352 | RIGHT SIDE COVER SCREW |
| 28 CX4663 | STAR DRAG |
| 29 CX4660 | HANDLE WASHER |
| 30 CX4701 | HANDLE |
| 31 CX4702 | HANDLE NUT |
| 32 NX4303 | MAGNETIC CONTROL DIAL |
| 33 CX4250 | O RING |

**KEY PART
NO. NO.**

| | |
|-------------|-------------------------|
| 34 CX4261 | MAGNET RET. SUPPORT |
| 35 CX4255 | SPOOL TENSION SHIM A |
| 36 CX4602 | MAGNET RETAINER SCREW |
| 37 CX4257 | MAGNET RETAINER |
| 38 BW4251 | SPOOL |
| 39 CX4260 | U SPOOL CONVERTER |
| 40 ZX4351 | SET PLATE |
| 41 ZX4402 | SPOOL RELEASE SLIDER |
| 42 CX4656 | RETAINER CLIP |
| 43 CX4353 | SET PLATE ACT. SPRING |
| 44 ZX4503 | SET PLATE ACTUATOR |
| 45 FX4658-1 | ANTI-REVERSE RATCHET |
| 46 CX4661 | DRAG WASHER A |
| 47 CX4662 | DRIVE SHAFT SPR. WSHR |
| 48 CX4258 | O RING |
| 49 CX4302 | SPOOL TENSION SHIM B |
| 50 CX4259 | SPOOL TENSION KNOB |
| 51 CX4703 | HANDLE NUT LOCK |
| 52 CX4704 | HANDLE NUT LOCK SCREW |
| 53 ZX4501 | SET PLATE ACTUATOR A |
| 54 BW4107 | LEFT SIDE PLATE SPACER |
| 55 CX4153 | GEAR RETAINING CLIP |
| 56 BW4150 | WORM SHAFT GEAR |
| 57 ZX4157 | SPOOL SHAFT BUSHING (R) |
| 58 FX4664 | DRAG WASHER C |
| 59 CX4450 | A/R RATCHET WASHER |
| 60 CX4406 | THUMB BAR CAM |
| 61 ZX4404 | THUMB BAR SHAFT |
| 62 ZX4405 | THUMB BAR LINK |
| 63 ZX4657 | RETAINER CLIP |
| 71 ZX009B | THUMB BAR |
| 72 ZX041 | THUMB BAR PIN |
| 73 ZX022 | THUMB BAR SPRING |

WWW.REELDR.COM

Prices subject to change without notice. Prices do not include postage and handling.

PLEASE ORDER BY PART NUMBER

Rev. 11/90

Zebco Division Brunswick Corporation, Box 270, Tulsa, OK 74101 USA 918-638-6581

