

QUANTUM® 441

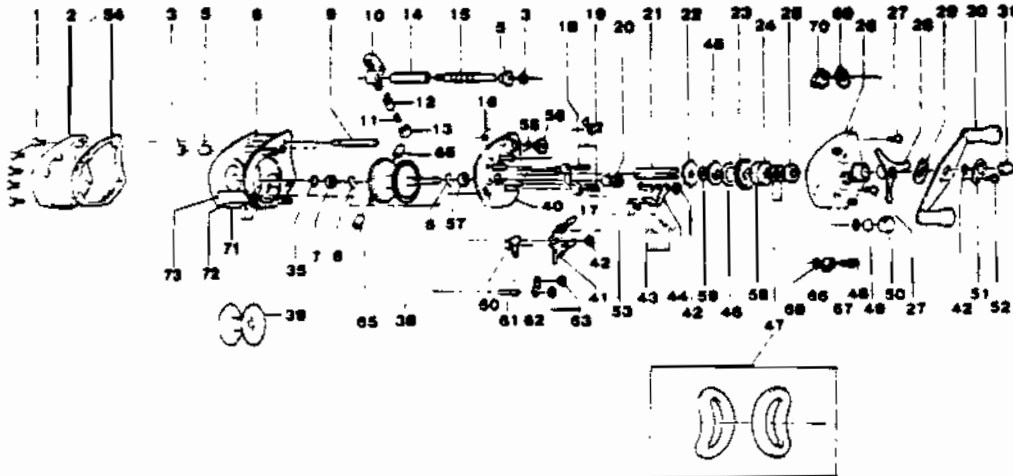

KEY PART NO.	DESCRIPTION
1	CX4102 LEFT SIDE PLATE SCREW
2	ZX4101 LEFT SIDE PLATE
3	CX4152 WORM SHAFT RETAINER
5	CX4158 WORM GUARD BUSHING
6	ZX4051 FRAME
7	ZX4156 SPOOL SHAFT BUSHING (L)
8	CX4253 BEARING RETAINER
9	KX4159 FRAME POST
10	CX4201-1 LINE GUIDE
11	CX4203 LINE GUIDE PAWL SPRING
12	CX4202 LINE GUIDE PAWL
13	CX4204 PAWL CAP
14	CX4158 WORM SHAFT GUARD-BLK
15	CX4151-1 WORM SHAFT W/O GEAR
16	CX4502 SPOOL RELEASE SPRING
17	CX4401 PINION YOKE
18	CX4403 PINION YOKE SPRING
19	CX4452-1 DOUBLE ANTI-REV PAWL
20	ZX4256 PINION GEAR
21	ZX4652 DRIVE SHAFT
22	CX4451-1 RELEASE RATCHET
23	ZX4651 DRIVE GEAR
24	PX4659 DRAG WASHER B
25	CX4254 DRIVE SHFT BUSH
26	ZX4103 RIGHT SIDE PLATE
27	CX4352 RIGHT SIDE COVER SCREW
28	CX4663 STAR DRAG
29	CX4660 HANDLE WASHER
30	PX4701 HANDLE
31	CX4702 HANDLE NUT
35	CX4255 SPOOL TENSION SHIM A

KEY PART NO.	DESCRIPTION
38	ZX4251 SPOOL
39	CX4260 U SPOOL CONVERTER
40	ZX4351 SET PLATE
41	ZX4402 SPOOL RELEASE SLIDER
42	CX4656 RETAINER CLIP
43	CX4353 SET PLATE ACT. SPRING
44	ZX4503 SET PLATE ACTUATOR
45	PX4658-1 ANTI-REVERSE RATCHET
46	PX4661 DRAG WASHER A
47	CX4662 DRIVE SHAFT SPR. WSKR
48	CX4258 O RING
49	CX4302 SPOOL TENSION SHIM B
50	CX4259 SPOOL TENSION KNOB
51	CX4703 HANDLE NUT LOCK
52	CX4704 HANDLE NUT LOCK SCREW
53	ZX4501 SET PLATE ACTUATOR A
54	ZX4107 LEFT SIDE PLATE SPACER
55	CX4153 GEAR RETAINING CLIP
56	ZX4150 WORM SHAFT GEAR
57	ZX4157 SPOOL SHAFT BUSHING (R)
58	PX4664 DRAG WASHER C
59	CX4450 A/R RATCHET WASHER
60	CX4406 THUMB BAR CAM
61	ZX4404 THUMB BAR SHAFT
62	ZX4405 THUMB BAR LINK
63	ZX4657 RETAINER CLIP
65	VX4603 CENTRIFUGAL BRAKE SHOE
66	WX4506 FLIPP'N LEVER
67	WX4510 FLIPP'N LEVER SCREW
68	ZX4508 SPRING - FLIPP'N LEVER
69	ZX4509 FLIPP'N SPRING SUPPORT
70	ZX4507 FLIPP'N ARM
71	ZX0098 THUMB BAR
72	ZX041 THUMB BAR PIN
73	ZX022 THUMB BAR SPRING

WWW.REELDR.COM

Prices subject to change without notice. Prices do not include postage and handling.

PLEASE ORDER BY PART NUMBER

Rev. 11/90

Zabco Division Brunswick Corporation, Box 270, Tulsa, OK 74101 USA 918-636-5581

