

ZEBCO PS50

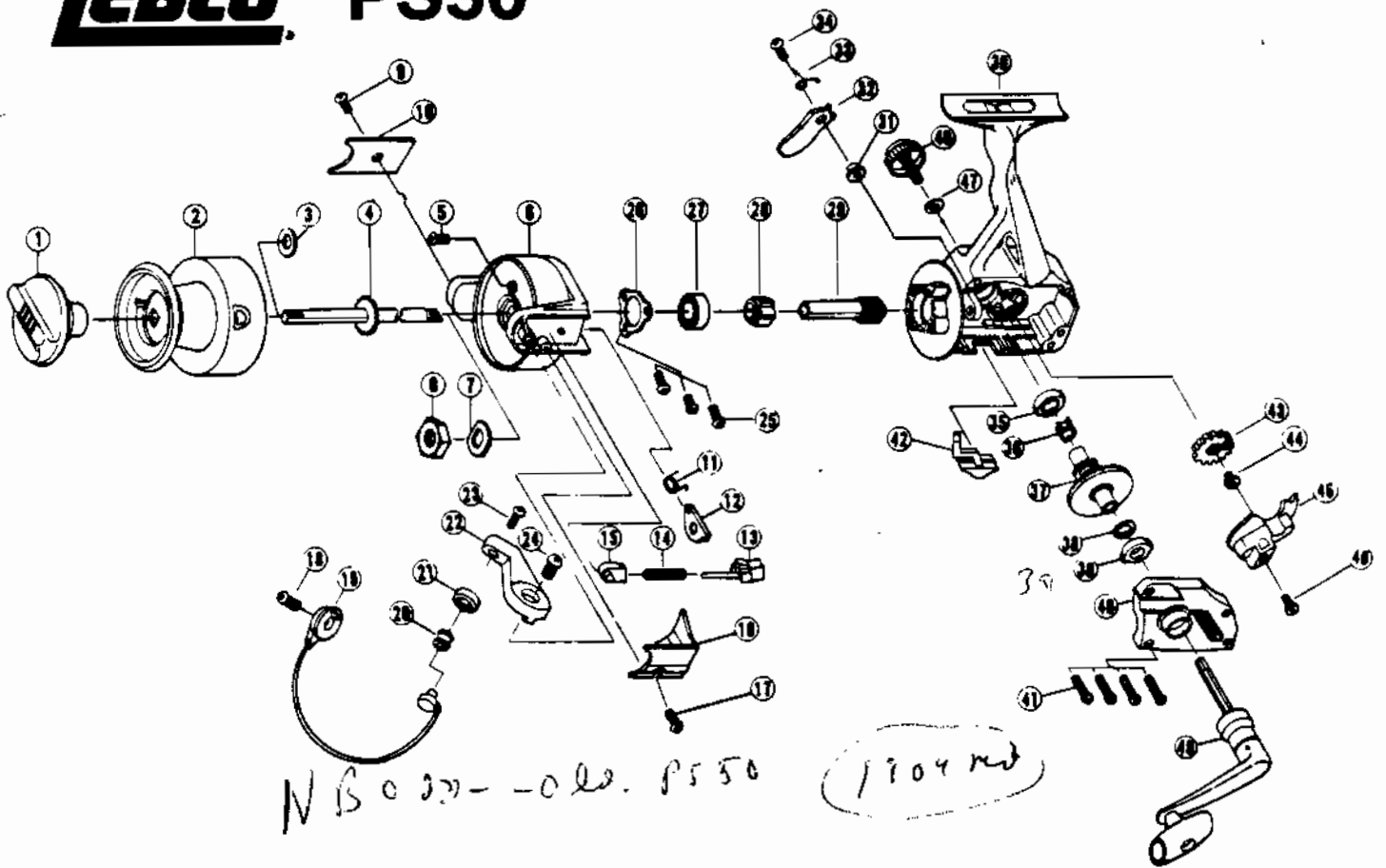

KEY PART

NO. NO.	DESCRIPTION
1 UL332	DRAG KNOB ASSY.
2 UL321	SPOOL ASSY.
3 UL046	SPOOL ADJ. WASHER
4 UL315	MAIN SHAFT ASSY.
5 UL094	ROTOR NUT LOCK SCREW
6 UL006	ROTOR NUT
7 UL065	ROTOR RETAINER WASHER
8 UL009	ROTOR
9 UL085	KICK LEVER COVER SCREW
10 UL024	KICK LEVER COVER
11 UL049	KICK LEVER SPRING
12 UL019	KICK LEVER
13 UL031	SPRING SHAFT
14 UL022	BAIL SPRING
15 UL020	SPRING HOLDER
16 UL087	BAIL SPRING COVER
17 UL085	KICK LEVER COVER SCREW
18 UL051	BAIL HOLDER SCREW
19 UL347	BAIL ASSY.
20 UL004	LINE ROLLER
21 UL017	BAIL COLLAR
22 UL007	ARM LEVER
23 UL108	BAIL SCREW P.B. 107, CA 107
24 UL107	ARM LEVER SCREW
25 UL080	BEARING PLATE SCREW

KEY PART

NO. NO.	DESCRIPTION
26 UL040	BEARING PLATE
27 UL028	BALL BEARING
28 UL060	RATCHET
29 UL011	PINION GEAR
30 UL001	BODY
31 UL091	STOPPER BUSHING
32 UL063	STOPPER
33 UL061	STOPPER SPRING
34 UL083	STOPPER SCREW
35 UL013	BODY BUSHING
36 UL086	SILENT CAM
37 UL012	DRIVE GEAR
38 UL026	DRIVE GEAR ADJ. WASHER
39 UL013	BODY BUSHING
40 UL023	BODY COVER
41 UL057	BODY COVER SCREW
42 UL059	STOPPER LEVER
43 UL053	OSCILLATING GEAR
44 UL035	O/S GEAR SCREW
45 UL081	O/S
46 UL161	O/S SCREW
47 UL076	HANDLE CAP WASHER
48 UL073	HANDLE SCREW CAP
49 UL318	HANDLE ASSY.

WWW.REELDR.COM

Prices subject to change without notice. Prices do not include postage and handling.

PLEASE ORDER BY PART NUMBER

Rev. 11/90

Zebco Division Brunswick Corporation, Box 270, Tulsa, OK 74101 USA 918-836-5581