

# TEBCO PS220

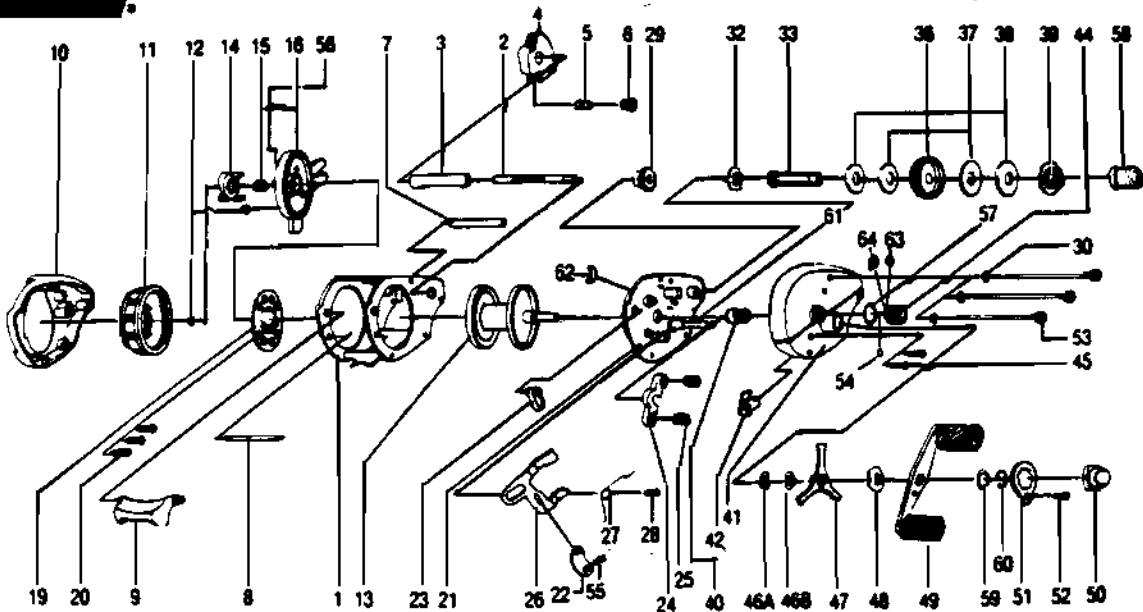

KEY PART		PS220	
NO.	NO.	DESCRIPTION	
1	HW001	FRAME	
2	GX4151	WORM SHAFT	
3	GX4158	WORM GEAR GUARD	
4	HW347	LINE GUARD	
5	GX4202	LINE GUIDE PAWL	
6	GX4204	LINE GUIDE CARRIER SCR.	
7	GX4159	CARRIER GUIDE	
8	GX4160	FRAME FIXED PIN	
9	HW009	THUMB BAR	
10	HW323	LEFT SIDE COVER ASSY.	
11	HW026	CONTROL DIAL	
12	GX4250	DIAL FRICTION RING	
13	HW321	SPOOL ASSY.	
14	GX4261	MAGNET RETAINER SUPPORT	
15	GX4301	MAGNET RETAINER SPRING	
16	GX4108	SPOOL COVER ASSY	
19	GX4257	MAGNET PLATE ASSY	
20	GX4602	MAGNET PLATE SCREW	
21	HW310	SET PLATE	
22	GX4405	LINK	
23	GX4406	THUMB BAR CAM	
24	GX4401	PINION YOKE	
25	GX4403	PINION YOKE SPR	
26	GX4402	RELEASE SLIDER	
27	GX4502	SPOOL REL. SPRING	
28	GX4656	RELEASE SLIDER SCREW	
29	GX4150	OSCILLATOR GEAR	
30	GX4109	FRAME SCREW WSHR	
32	GX4659	CONTROL ELEMENT	
33	GX4652	CRANK SHAFT	
36	GX4651	DRIVE GEAR	
37	GX4659	DRAG WASHER "B"	
38	GX4653	DRAG WASHER "D"	
39	GX4451	ANTI-REVERSE	
40	GX4256	PINION GEAR ASSY	
41	HW024	RIGHT SIDE COVER	
42	GX4452	ANTI-REVERSE PAWL	
44	GX4259	SPOOL TENSION KN. ASSY	
45	GX4352	RIGHT SIDE CVR SCR	
A46	GX4662A	THICK WAVE WASHER	
B46	GX4662B	THIN WAVE WASHER	
47	GX4663	STAR DRAG	
48	GX4660	HANDLE WASHER	
49	HW318	HANDLE ASSY.	
50	GX4702	HANDLE NUT	
51	GX4703	HANDLE NUT LOCK	
52	GX4704	HANDLE NUT LOCK SCR	
53	GX4104	FRAME SCREW	
54	GX4302	SPOOL TNSN. KN. WSHR. (FL)	
55	GX4506	LINK SCREW	
56	GX4556	CLICK CLAM	
57	GX4258	SPOOL TENSION KN. RING	
58	GX4254	RIGHT SIDE CVR BUSHING	
59	GX4105	SET PLATE SHAFT WSHR	
60	GX4657	CRANK SHAFT E-CLIP	
61	GX4664	SET PLATE SHAFT	
62	GX4665	SHAFT CLIP-E	
63	GX4305	SPOOL TEN. KN. WSHR (RB)	
64	GX4304	SPOOL TEN. KN. WSHR (SQ)	

KEY PART		PS220J	
NO.	NO.	DESCRIPTION	
1	JW001	FRAME	
2	JW072	WORM SHAFT	
3	JW016	WORM SHAFT GUARD	
4	JW347	LINE GUARD	
5	JW006	LINE GUIDE PAWL	
6	JW007	LINE GUIDE PAWL SCREW	
7	JW061	STABILIZER BAR	
8	JW094	FRAME FIXED PIN	
9	JW009	THUMB BAR	
10	JW323	LEFT SIDE COVER ASSY.	
11	JW026	CONTROL DIAL	
12	JW101	O-RING CAST CONTROL	
13	JW321	SPOOL ASSY.	
14	JW028	SLIDE CAM	
15	JW071	SLIDE CAM SPRING	
16	JW351	SPOOL COVER	
19	JW330	MAGNET PLATE ASSY.	
20	JW076	MAGNET PLATE SCREW	
21	JW310	SET PLATE	
22	JW036	LINK	
23	JW050	THUMB BAR CAM	
24	JW025	PINION YOKE	
25	JW040	PINION YOKE SPRING	
26	JW039	RELEASE SLIDER	
27	JW102	TRIP SPRING	
28	JW057	RELEASE SLIDER SCREW	
29	JW085	LEVEL WIND GEAR	
30	GX109	WASHER-THUMB SCREW	
32	JW083	TRIP RATCHET	
33	JW008	DRIVE SHAFT	
36	JW012	DRIVE GEAR	
37	JW059	DRAG DISC	
38	JW045	DRAG WASHER	
39	JW091	ANTI-REVERSE RATCHET	
40	JW311	PINION GEAR ASSY.	
41	JW024	RIGHT SIDE COVER	
42	JW363	ANTI-REVERSE PAWL	
44	JW333	CAST CONTROL CAP ASSY.	
45	GX4352	RIGHT SIDE CVR SCR	
A46	JW046A	THICK WAVE WASHER	
B46	JW046B	THIN WAVE WASHER	
47	JW355	DRAG KNOB ASSY.	
48	GX4660	HANDLE WASHER	
49	JW318	HANDLE ASSY.	
50	GX4702	HANDLE NUT	
51	GX4703	HANDLE NUT LOCK	
52	GX4704	HANDLE NUT LOCK SCR	
53	JW374	THUMB SCREW ASSY.	
54	JW032	SPOOL TENSION KNOB	
55	JW100	LINK SCREW	
56	JW108	CLICK CLAM	
57	JW105	TENSION KNOB O-RING	
58	JW058	CRANK SHAFT BUSHING	
59	JW084	SHIM CRANKSHAFT	
60	GX4657	CRANK SHAFT E-CLIP	
61	JW002	SET PLATE SHAFT	
62	GX4665	SHAFT CLIP-E	
63	JW082	CAST CONTROL CUSHION	
64	JW038	SPOOL TN. KN. WSHR.-SQ.	

WWW.REELDR.COM