

# TEBCO PRO STAFF 2010N, 2020N, 2030N

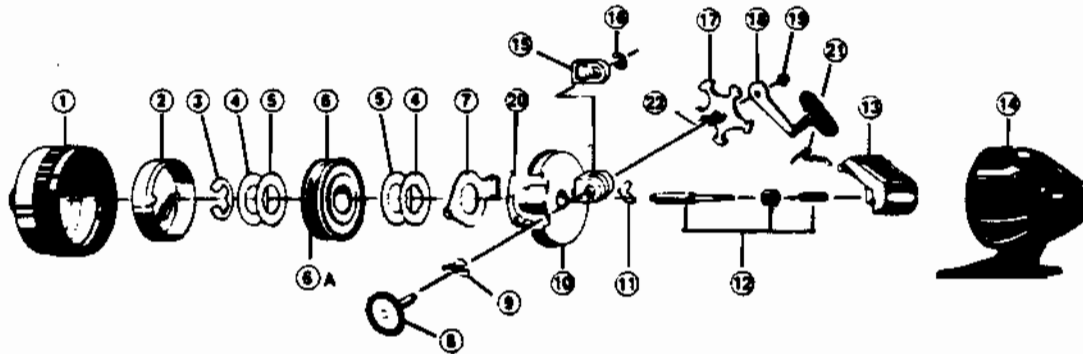

KEY PART NO. NO.	2010N DESCRIPTION
1 QY324-5	FRONT COVER S/A
2 QY310	SPINNER HEAD ASSEMBLY
3 XZ034	SPOOL CLIP
4 BJ040	SPOOL WASHER
5 BJ108	FLAT WASHER
6 QY021	SPOOL
6 QY036	SPOOL LIP WASHER
6 QY321-6H	WOUND SPOOL W/ LINE 6#
7 QY027	CLUTCH RING
8 QY308	CRANK SHAFT ASSEMBLY
9 JY061	PAWL ACTUATOR
10 QY301	BODY ASSEMBLY
11 JY060	ANTI-REVERSE PAWL
12 QY315	CENTERSHAFT ASSEMBLY
13 TY009	THUMB STOP
14 QY323-5	BACK COVER ASSY.
15 JY054	SLIDE DRAG ACTUATOR
16 JY121	RETAINER CLIP
17 QY032-1	DRAG STAR
18 QY318-5	HANDLE ASSY.
19 AZ003	CRANK NUT
20 RY033	RATCHET SPRING
21 QY038	THUMB STOP SPRING
22 QY026-3	CRANK SHAFT BUSHING

KEY PART NO. NO.	2020N DESCRIPTION
1 JY324-12	FRONT COVER S/A
2 JY310	SPINNERHEAD
3 JY034	SPOOL CLIP
4 JY040	SPOOL WASHER
5 JY108	FLAT WASHER, DRAG
6 JY021	SPOOL
6 JY321-8M	WOUND SPOOL 8# MONO HP
7 NY027	CLUTCH RING
8 JY308	CRANK GEAR SUB-ASSEMBLY
9 JY061	PAWL ACTUATOR
10 JY301	BODY SUB-ASSEM
11 JY060	ANTI-REVERSE PAWL
12 JY315	CENTER SHAFT S/A
13 KY009	THUMB STOP
14 JY323-5	BACK COVER S/A
15 JY054	SLIDE DRAG ACTUATOR
16 JY121	RETAINER CLIP
17 JY032-1	DRAG STAR
18 JY318-5	HANDLE ASSY.
19 AZ003	CRANK NUT
20 RY033	RATCHET SPRING
21 QY038	THUMB STOP SPRING
22 WY026	CRANK SHAFT BUSHING

[WWW.REELDR.COM](http://WWW.REELDR.COM)

KEY PART NO. NO.	2030N DESCRIPTION
1 KY324-5	FRONT COVER ASSY.
2 KY310-1	SPINNERHEAD S/A
3 GZ034-1	SPOOL RETAINER CLIP
4 CJ040-1	SPOOL WASHER (METAL)
5 CJ108-1	FLAT WASHER
6 KY021	SPOOL
6 KY321-14H	SPOOL W/14# HI PERF LINE
7 KY027-1	CLUTCH RING
8 KY308-1	CRANK SHAFT S/A
9 JY061	PAWL ACTUATOR
10 KY301	BODY ASSEMBLY 2030
11 JY060	ANTI-REVERSE PAWL
12 KY315	CENTER SHAFT SUB-ASSEMBLY
13 KY009	THUMB STOP
14 KY323-6	BACK COVER S/A
15 KY054-1	SLIDE DRAG ACTUATOR
16 JY121	RETAINER CLIP
17 KY032-1	DRAG STAR
18 KY318-3	HANDLE ASSY.
19 AZ003	CRANK NUT
21 KY038	THUMB STOP SPRING
22 KY026-5	CRANK BUSHING

*Drive -*

*Pinion -*

*CS OK?*  
*QY032*  
*Spring*

Prices subject to change without notice. Prices do not include postage and handling.

**PLEASE ORDER BY PART NUMBER**

Rev. 11/90

Zebco Division Brunswick Corporation, Box 270, Tulsa, OK 74101 USA 918-836-5581