

TEBCO pro staff™ 20/10™, 20/20™, 20/30™

weight	10.4 oz./296g			8.7 oz./247g			6.0 oz./170g		
pound test	12	14	17	6	8	10	4	6	8
yards	100	90	75	180	100	85	125	100	85

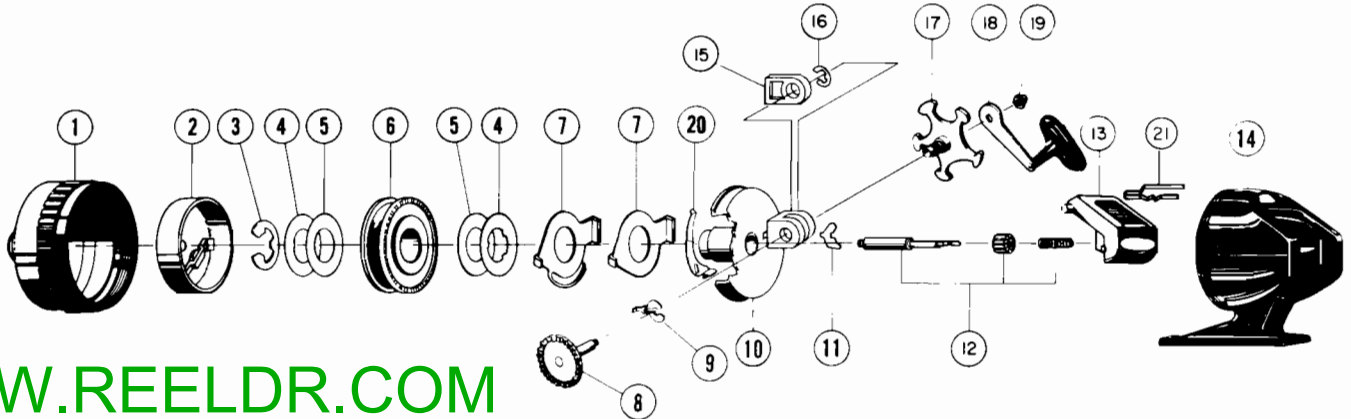

WWW.REELDR.COM

Key No.	Description	20/10 Part No.	20/20 Part No.	20/30 Part No.
1	Front Cover Assy. (Pro Staff)	QY324-2	JY324-2	KY324-2
	Front Cover Assy. (Silver Model)	-----Use Pro Staff Front Cover Assy.-----		
2	Spinnerhead Assembly	QY310	JY310	KY310
3	Spool Clip	XZ034	JY034	GZ034
4	Metal Spool Washer	BJ040	**JY040	CJ040
5	Drag Washer	BJ108	**JY108	CJ108
6	Spool (Empty)	QY021	JY021	KY021
	Spool w/Std. Wt. High Perf. Line	QY321-6H	JY321-8H	KY321-14H
	Spool w/4# High Perf. Line	QY321-4H	-----	-----
7	Clutch Ring	QY027	NY027	-----
7a	Clutch Ring	-----	*JY027	KY027
8	Crank Shaft Assembly	QY308	JY308	KY308
9	Pawl Actuator	JY061	JY061	JY061
10	Body Assembly	QY301	JY301	KY301
11	Anti-Reverse Pawl	JY060	JY060	JY060
12	Center Shaft Assembly	QY315	JY315	KY315
13	Thumb Brake (Pro Staff)	QY009-2	JY009-2	JY009-2
14	Back Cover w/Th Brake (Pro Staff)	QY323-2	JY323-2	KY323-2
	Back Cover w/Th Brk (Silver Model)	-----Use Pro Staff Back Cover w/Th. Brake-----		
15	Slide Drag Actuator	JY054	JY054	KY054
16	Retainer Clip	JY121	JY121	JY121
17	Crank Bushing (Star Drag)	QY026	JY026	KY026
18	Handle Assy. (Pro Staff)	QY318-2	JY318-2	KY318-2
	Handle Assy. (Silver Model)	QY318	JY318	KY318
19	Crank Nut (Locking)	AZ003	AZ003	AZ003
20	Spool Click Spring	RY033	RY033	-----
21	Thumb Brake Spring	QY038	QY038	KY038

NOTE: Should the anti-reverse pawl (11) drop out while changing spool, be sure to place it back into body assembly with largest flange pointing toward base of reel as shown in diagram. Make sure the arm of the pawl actuator (9) rests in the center of the anti-reverse pawl to reassemble.

*Model 20/20's produced prior to 1983 use part number JY027 in place of part number NY027 and NY033.

**Model 20/20's produced after March 1985 use Part Number NY040 in place of Part Numbers JY040 and JY108.