

# ← **TEBCO** Crossfire™ 30

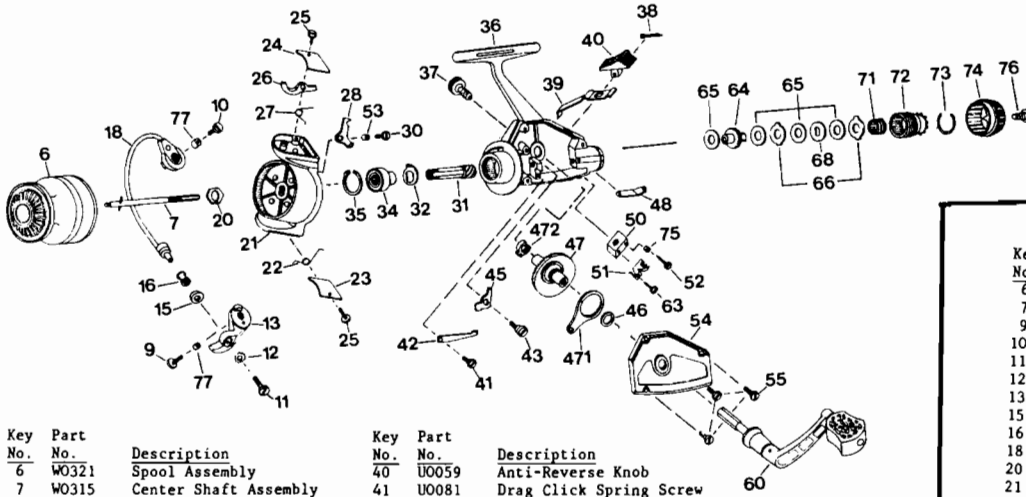

Key No.	Part No.	Description
6	W0321	Spool Assembly
7	W0315	Center Shaft Assembly
9	U0051	Bail Screw A
10	U0051	Bail Screw B
11	U0108	Bail Axle Screw
12	U0048	Bail Axle Screw Washer
13	W0007	Bail Arm
15	U0016	Line Roller Bushing
16	U0004	Line Roller
18	W0347	Bail Assembly
20	W0006	Rotor Nut
21	W0309	Rotor
22	W0022	Bail Spring
23	W0025	Bail Spring Cover
24	W0024	Bail Trip Cover
25	U0085	Bail Cover Screw
26	W0019	Bail Trip Lever A
27	W0049	Bail Trip Spring
28	W0020	Bail Trip Lever B
30	W0111	Trip Lever Retainer
31	W0011	Pinion Gear
32	W0060	Anti-Reverse Ratchet
34	W0028	Pinion Bearing
35	W0040	Bearing Retainer
36	W0301	Body Assembly
37	U0054	Handle Retainer
38	U0071	Anti-Reverse Knob Retainer
39	W0069	Anti-Reverse Knob Spring

Key No.	Part No.	Description
40	U0059	Anti-Reverse Knob
41	U0081	Drag Click Spring Screw
42	W0068	Drag Click Spring
43	U0080	Anti-Reverse Pawl Screw
45	W0063	Anti-Reverse Pawl
46	W0026	Crank Gear Shim
47	W0012	Crank Gear
48	U0033	Drag Knob Click Spring
50	W0044	Oscillator Slider Link
51	W0009	Oscillator Retainer
52	U0100	Oscillator Slider Screw
53	W0109	Trip Lever Bushing
54	W0323	Side Plate Assembly
55	U0057	Side Plate Screw
60	W0318	Handle Assembly
63	U0110	Shaft Retainer (Screw)
64	W0038	Drag Sleeve
65	W0039	Drag Washer
66	W0066	Drag Drive
68	W0030	Keyed Drag Washer
71	U0031	Drag Spring
72	W0034	Drag Screw
73	W0070	Drag Screw Spring
74	W0032	Drag Knob
75	U0050	Drag Knob Retainer Screw
76	U0046	Oscillator Screw Bushing
77	U0013	Bail Axle Screw Bushing
471	W0043	Oscillator Slider
472	W0027	Anti-Reverse Actuator

Key No.	Part No.	Description
65	X0315	Center Shaft Assembly
66	X0007	Bail Arm
67	X0007	Bail Arm
68	X0006	Rotor Nut
69	X0006	Rotor Nut
70	X0006	Rotor Nut
71	X0011	Pinion Gear
72	X0011	Pinion Gear
73	X0011	Pinion Gear
74	X0011	Pinion Gear
75	X0011	Pinion Gear
76	X0011	Pinion Gear

# **TEBCO** Crossfire™ 50

[WWW.REELDR.COM](http://WWW.REELDR.COM)

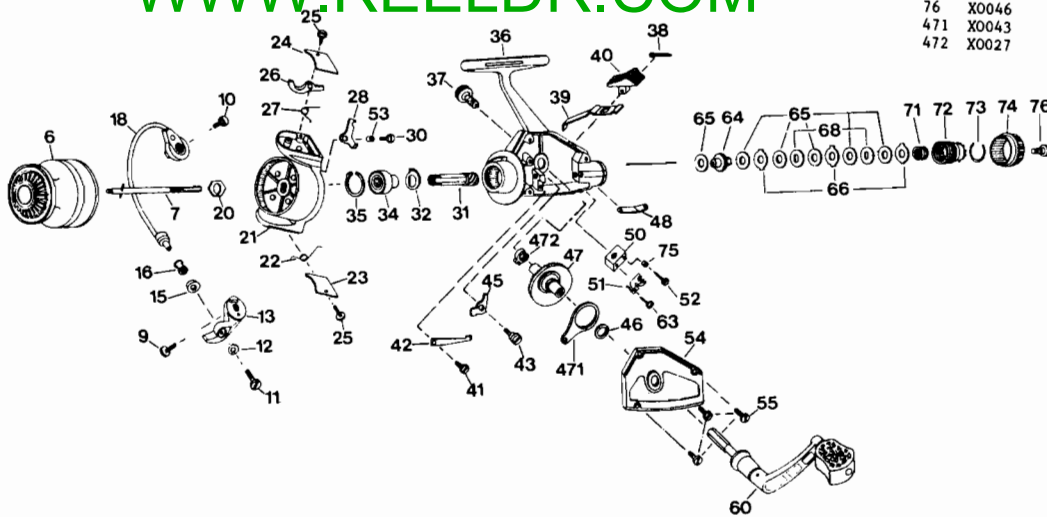

Key No.	Part No.	Description
40	U0059	Anti-Reverse Knob
41	U0081	Drag Click Spring Screw
42	W0068	Drag Click Spring
43	U0080	Anti-Reverse Pawl Screw
45	W0063	Anti-Reverse Pawl
46	X0026	Crank Gear Shim
47	X0012	Crank Gear
48	U0033	Drag Knob Click Spring
50	X0044	Oscillator Slider Link
51	X0009	Oscillator Retainer
52	U0100	Oscillator Slider Screw
53	W0109	Trip Lever Bushing
54	X0323	Side Plate Assembly
55	U0057	Side Plate Screw
60	X0318	Handle Assembly
63	X0110	Shaft Retainer (Screw)
64	W0038	Drag Sleeve
65	W0039	Drag Washer
66	W0066	Drag Drive
68	W0030	Keyed Drag Washer
71	U0031	Drag Spring
72	W0034	Drag Screw
73	W0070	Drag Screw Spring
74	W0032	Drag Knob
75	U0050	Drag Knob Retainer Screw
76	X0046	Oscillator Screw Bushing
471	X0043	Oscillator Slider
472	X0027	Anti-Reverse Actuator