

# ZEBCO 888™

weight	13.5 oz./383 g
pound test	17 20 25
yards	140 100 75
meters	128 91 69

[WWW.REELDR.COM](http://WWW.REELDR.COM)

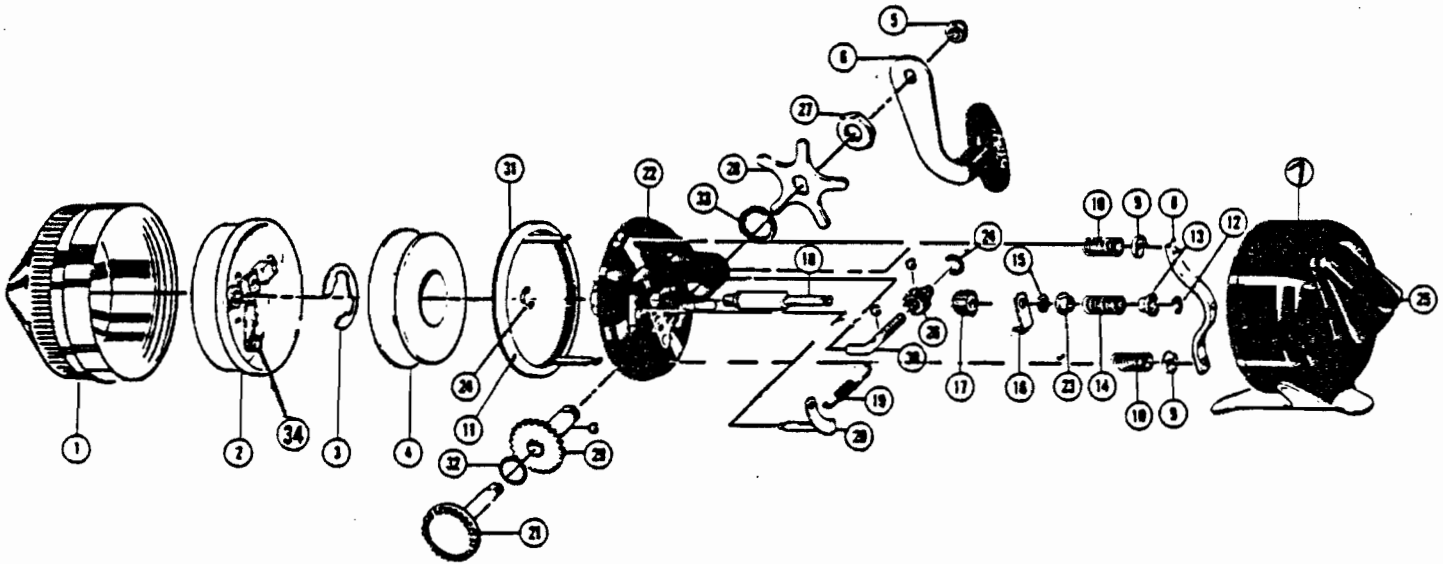

KEY No.	PART No.	DESCRIPTION	PRICE	KEY No.	PART No.	DESCRIPTION	PRICE
1	PZ24//SA	FRONT COVER ASSY.	\$3.05	19	MZ85-A/1	CLUTCH SPRING	\$ .45
2	PZ10//SA	SPINNER HEAD ASSY.	.3.60	20	PZ7-A//SA	CLUTCH SHAFT ASSY.	.65
3	GZ34//THT	SPOOL CLIP	.30	21	PZ8-A//SA	CRANK SHAFT	3.05
4	PZ21//SA	SPOOL (EMPTY)	3.40	22	PZ1-A//SA	BODY ASSEMBLY	8.50
5	QZ3//TP	CRANK NUT	.30	23	PZ84//CP	*SHAFT SPACER (BOTTOM)	.35
6	PZ18-A//SA	CRANK HANDLE	2.10	24	PZ30/0	CENTER SHAFT RET. CLIP	.35
7	PZ23-A//SA	BACK COVER ASSY.	3.05	25	PZ9-A/0	THUMB STOP	.40
8	PZ31//TP	BRAKE BAR	.90	26	MZ86-A/0	CLUTCH PINION	.45
9	PZ74//CP	BRAKE RING CAP	.35	27	PZ87-A/1	CRANK BEARING NUT	.45
10	PZ73/0	BRAKE RING SPRING	.35	28	PZ59-A//TP	STAR DRAG	.45
11	PZ46//SA	BRAKE RING ASSY.	2.40	29	PZ26-A//SA	CRANK SHAFT BEARING	1.20
12	QZ22/0	*CENTER SHAFT CLIP	.25	30	MZ32-A//TMP	CLUTCH SCREW	.45
13	PZ78//CP	*SHAFT SPACER (TOP)	.35	31	PZ53//TP	BRAKE RING (GASKET)	.35
14	PZ20/1	*CENTER SHAFT SPRING	.45	32	PZ88-A//TP	CRANK SHAFT WASHER	.25
15	PZ68/0	*CENTER SHAFT WASHER	.25	33	MZ88-A/0	O-RING	.20
16	PZ52//SA	*ANTI-REVERSE DRAG	.45	34	PZ49/1	SPINNER HEAD SPRING	.35
17	PZ11//TP	*PINION GEAR	1.85				
18	PZ15/5	*CENTER SHAFT	1.85				
						*AVAILABLE AS ONE UNIT, PZ15//SA CENTER SHAFT ASSY.	5.15

PLEASE ORDER BY PART NUMBER

Zebco Division Brunswick Corporation, Box 270, Tulsa OK 74101 USA 918-336-5581

