

ZEBCO 84™

| | | |
|------------|------------------|---------|
| weight | 11.5 oz. / 326 g | |
| pound test | 6 | 8* 10 |
| yards | 330 | 220 165 |
| meters | 302 | 201 151 |

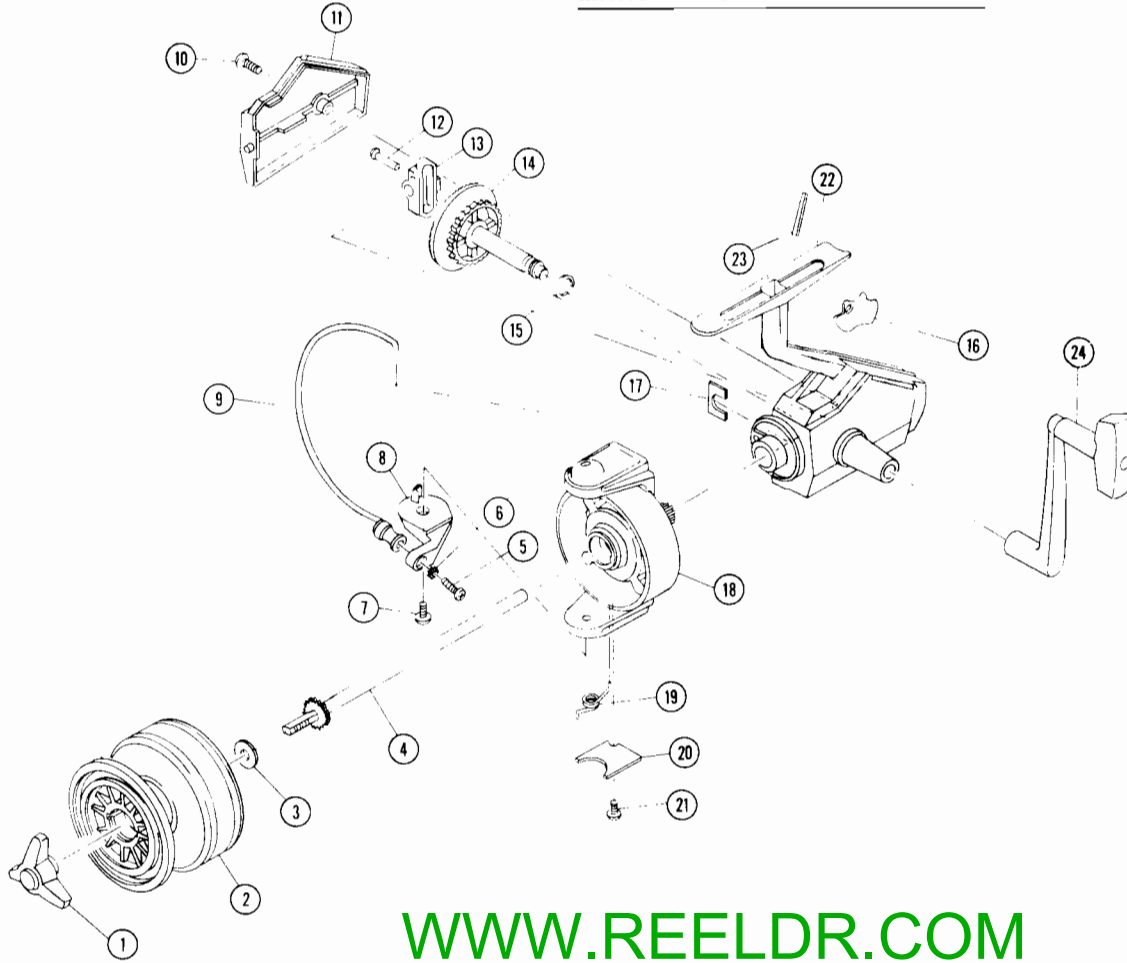

WWW.REELDR.COM

MODEL 84

| Key No. | Part No. | Description | Key No. | Part No. | Description |
|---------|----------|-----------------------|---------|----------|------------------------|
| 1 | KA32 | Drag Knob | 13 | KA53 | Oscillator Slider |
| 2 | KA321 | Spool Assembly | 14 | KA12 | Crank Gear |
| 3 | JA45 | Center Shaft Washer | 15 | KA27 | Crank Gear Shim |
| 4 | JA315 | Center Shaft | 16 | KA59 | Anti-Reverse Lever |
| 5 | CB108 | Bail Axle Screw | 17 | DA6 | Rotor Retainer |
| 6 | CB102 | Bail Axle Screw Wshr. | 18 | KA9 | Rotor |
| 7 | CB51 | Bail Screw | 19 | KA22 | Bail Spring |
| 8 | HB3 | Bail Arm | 20 | KA87 | Bail Spring Cover |
| 9 | KA347 | Bail Assembly | 21 | HB50 | Bail Cover Screw |
| 10 | KA57 | Side Plate Screw | 22 | KA301 | Body |
| 11 | KA323 | Side Plate Assembly | 23 | KA61 | Anti-Rev. Lever Spring |
| 12 | KA62 | Oscillator Pin | 24 | KA318 | Crank Handle Assy. |

PLEASE ORDER BY PART NUMBER

Zebco Division Brunswick Corporation, Box 270, Tulsa OK 74101 USA 918 836 5581