

ZEBCO 802™

weight	9 oz./256g			
pound-test	10	12	14	17
yards	65	55	50	45
meters	59	50	46	41

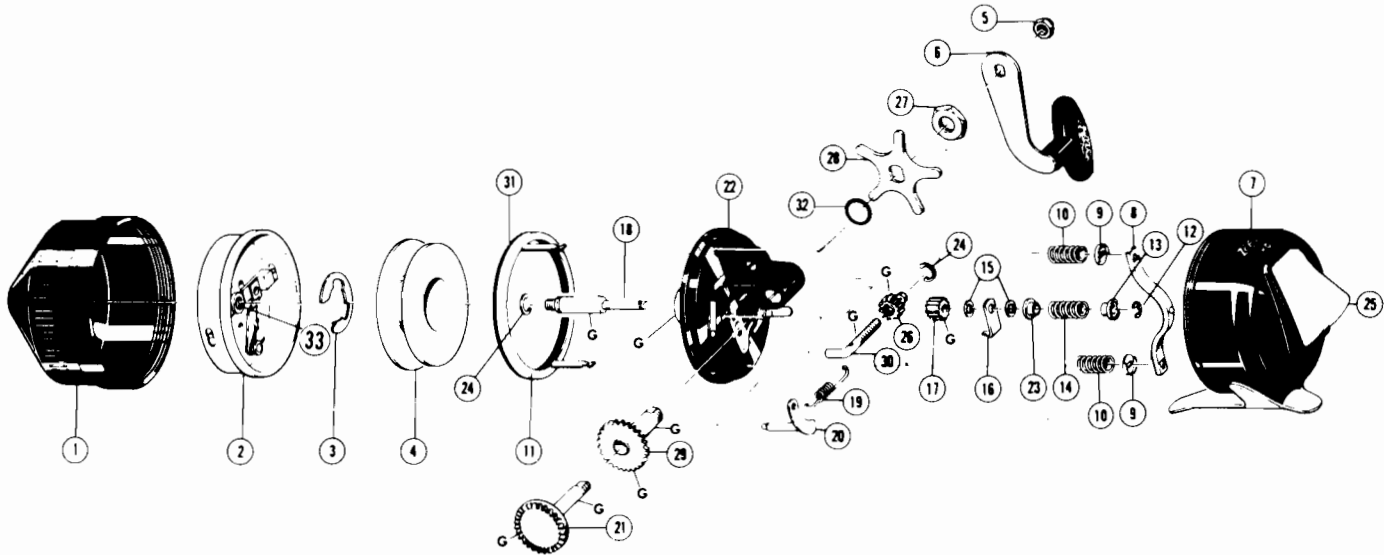

WWW.REELDR.COM

MODEL 802

Key No.	Part No.	Description	Key No.	Part No.	Description
1	MZ24-A//SA	Front Cover Assy.	17	JZ11//TP	*Pinion Gear
2	MZ10//SA	Spinner Head Assy.	18	MZ15/3	*Center Shaft
3	GZ034	Spool Clip	19	MZ085	Clutch Spring
4	MZ21//CMP	Spool (Empty)	20	MZ7-A//SA	Clutch Shaft
	MZ321-12T	Spool w/12# Trilene	21	MZ8-A//SA	Crank Shaft
5	XZ003-1	Crank Nut	22	MZ1-A//SA	Body Assy.
6	MZ18-A//SA	Crank Handle	23	MZ84//CP	*Shaft Spacer (Bottom)
7	MZ23-A//SA	Back Cover w/Th. Brk.	24	PZ30/0	Center Shaft Ret. Clip
8	MZ31//TP	Brake Bar	25	PZ9/1	Thumb Stop
9	PZ074	Brake Ring Cap	26	MZ086	Clutch Pinion
10	PZ073	Brake Ring Spring	27	MZ87-A//CP	Crank Bearing Nut
11	MZ46//SA	Brake Ring Assy.	28	MZ59-A//CP	Star Drag
12	WZ22/0	*Center Shaft Clip	29	MZ26-A//SA	Clutch Gear
13	MZ78//CP	*Shaft Spacer (Top)	30	MZ32-A//TMP	Clutch Screw
14	PZ073	*Brake Ring Spring	31	MZ053	Brake Ring Gasket
15	LZ054	*Nylon Washer	32	MZ088	O-Ring
16	GZ52//TP	*Anti-Reverse Drag	33	PZ49/1	Spinner Head Spring

*Available as One Unit,
MZ15//SA Center Shaft Assy.

PLEASE ORDER BY PART NUMBER

Zebco Division Brunswick Corporation, Box 270, Tulsa OK 74101 USA 918 836-5581