

# ZEBCO 6070

weight	23.7 oz./672 g
pound test	17 20* 25
yards	300 235 185
meters	274 215 169
gear ratio	4.7:1

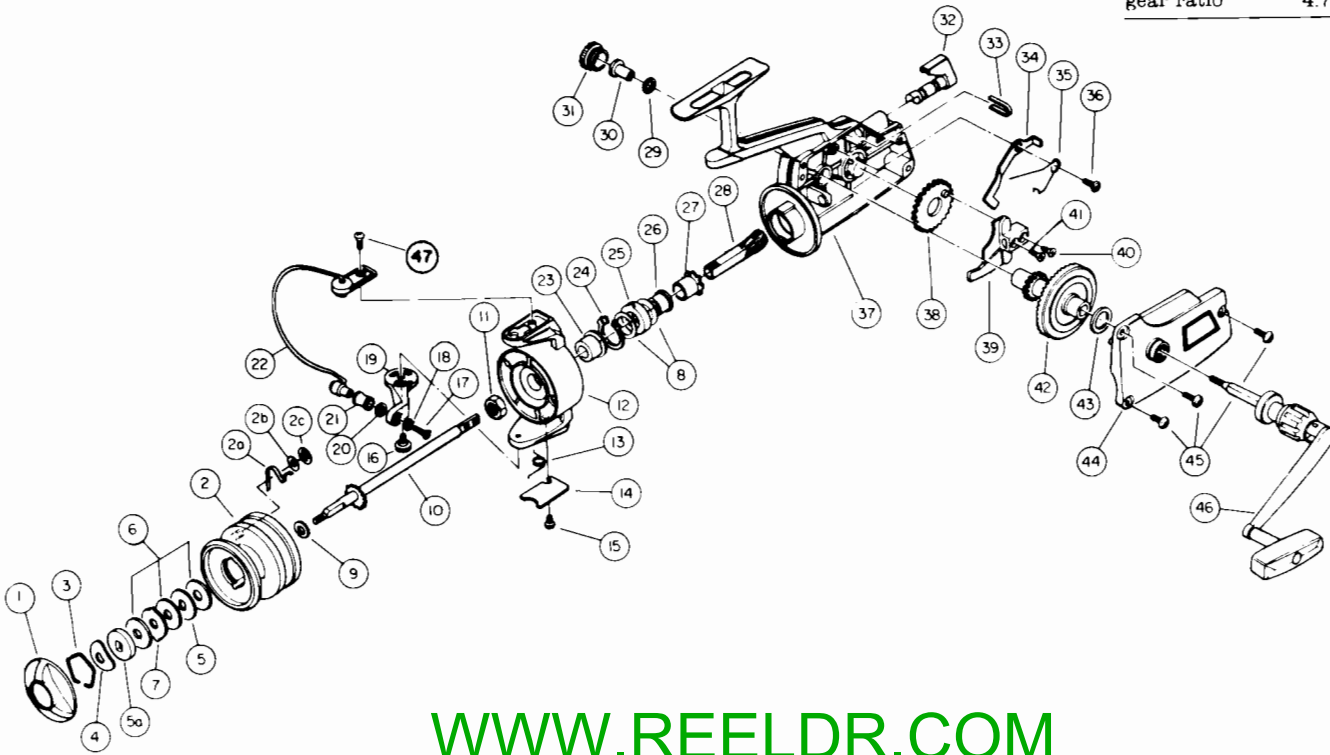

[WWW.REELDR.COM](http://WWW.REELDR.COM)

Key No.	Part No.	Description	Key No.	Part No.	Description
1	GB32	Drag Knob	22	GB310	Bail Assembly
2	GB21	*Spool (Incomplete) (See Assy)	23	GB81	Front Pinion Spacer
2A	GB67	*Click Spring	24	GB40	Bearing Retainer
2B	GB65	*Click Spring Washer	25	GB28	Pinion Bearing
2C	CB68	*Click Spring Retainer	26	GB113	Rear Pinion Spacer
3	GB36	*Drag Retainer Clip	27	GB60	Anti-Reverse Ratchet
4	GB31	*Spring Washer	28	GB11	Pinion
5	GB30	*Drag Washer A	29	GB105	Handle Retainer Washer
5A	GB26	*Drag Washer C	30	GB54	Handle Retainer Cover
6	GB39	*Drag Washer B	31	EB73	Handle Screw Cover
7	GB66	*Drag Drive	32	GB59	Anti-Reverse Knob
8	GB86	Bearing Washer	33	GB69	Anti-Rev. Knob Spring
9	GB56	Center Shaft Washer	34	GB63	Anti-Reverse Pawl
10	GB315	Center Shaft Assy.	35	FB61	Anti-Rev. Pawl Spring
11	GB6	Rotor Nut	36	FB80	Anti-Rev. Pawl Screw
12	GB309	Rotor	37	GB301	Body Assembly
13	GB22	Bail Spring	38	GB53	Oscillator Gear
14	GB87	Bail Spring Cover	39	GB25	Oscillator Slider
15	EB85	Bail Spring Cover Screw	40	FB100	Osc. Slider Screw A
16	GB51	Bail Screw A	41	GB80	Osc. Slider Screw B
17	GB108	Bail Axle Screw	42	GB12	Crank Gear
18	GB102	Bail Axle Washer	43	GB92	Crank Gear Shim
19	GB7	Bail Arm A	44	GB23	Side Plate
20	FB16	Line Roller Bushing	45	CB57	Side Plate Screw
21	FB4	Line Roler	46	GB318	Crank Handle Assy.
			47	GB84	Bail Screw B

\*Available As One Unit,  
GB321 Spool Assembly

PLEASE ORDER BY PART NUMBER