

TEBCO 6050

weight	18.3 oz./519 g
pound test	14 17* 20
yards	280 250 180
meters	256 229 165
gear ratio	4:1

WWW.REELDR.COM

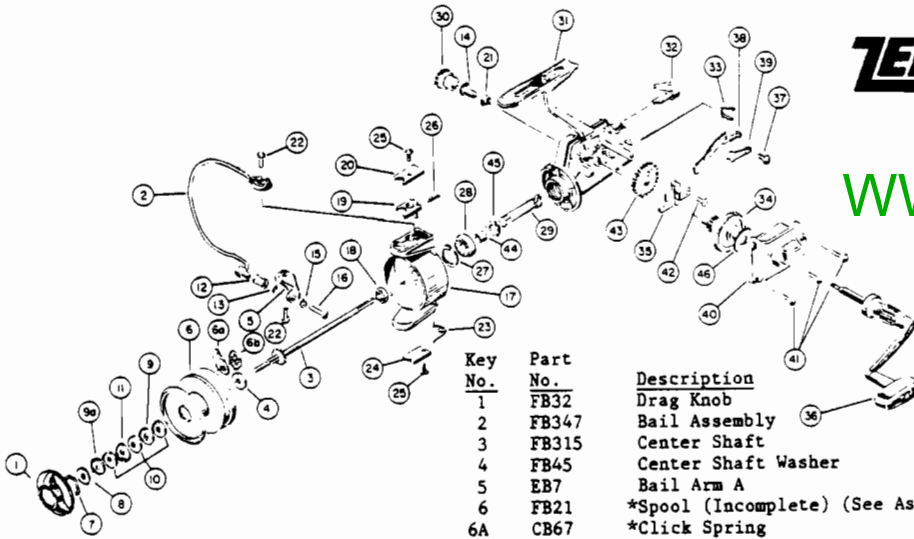

Key No.	Part No.	Description
1	FB32	Drag Knob
2	FB347	Bail Assembly
3	FB315	Center Shaft
4	FB45	Center Shaft Washer
5	EB7	Bail Arm A
6	FB21	*Spool (Incomplete) (See Assy)
6A	CB67	*Click Spring
6B	CB68	*Click Spring Retainer
7	FB36	*Drag Retainer Clip
8	FB31	*Spring Washer
9	FB30	*Drag Washer A
9A	FB26	*Drag Washer C
10	FB39	*Drag Washer B
11	FB66	*Drag Drive
12	FB4	Line Roller
13	FB16	Line Roller Bushing
14	FB55	Handle Retainer Screw
15	CB102	Bail Axle Washer
16	CB108	Bail Axle Screw
17	FB9	Rotor
18	DB6	Rotor Nut
19	FB19	Bail Trip Lever
20	FB24	Bail Trip Cover
21	FB56	Handle Retainer Washer

Key No.	Part No.	Description
22	EB51	Bail Screw
23	FB22	Bail Spring
24	FB87	Bail Spring Cover
25	EB85	Bail Spring Cover Screw
26	CB49	Bail Trip Spring
27	DB40	Bearing Retainer
28	DB28	Pinion Bearing
29	FB11	Pinion Gear
30	EB73	Handle Retainer Cover
31	FB301	Body
32	FB59	Anti-Reverse Knob
33	FB69	Anti-Rev. Knob Spring
34	FB12	Crank Gear
35	FB25	Oscillator Slider
36	FB318	Crank Handle Assy.
37	FB80	Anti-Rev. Pawl Screw
38	FB63	Anti-Reverse Pawl
39	FB61	Anti-Rev. Pawl Spring
40	FB323	Side Plate
41	CB57	Side Plate Screw
42	FB100	Osc. Slider Screw A
43	FB53	Oscillator Gear
44	FB81	Spacer
45	FB60	Anti-Reverse Ratchet
46	FB92	Crank Gear Shim

*Available As One Unit,
FB321 Spool Assembly

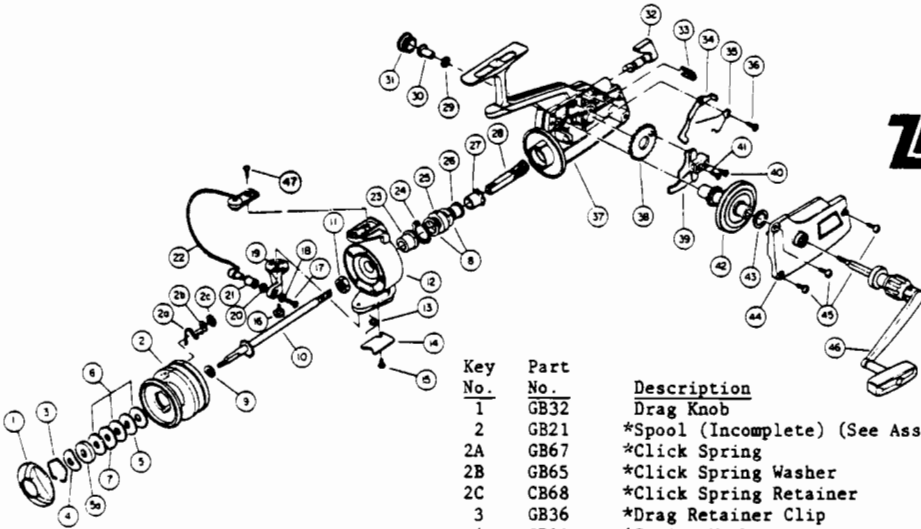

Key No.	Part No.	Description
1	GB32	Drag Knob
2	GB21	*Spool (Incomplete) (See Assy)
2A	GB67	*Click Spring
2B	GB65	*Click Spring Washer
2C	CB68	*Click Spring Retainer
3	GB36	*Drag Retainer Clip
4	GB31	*Spring Washer
5	GB30	*Drag Washer A
5A	GB26	*Drag Washer C
6	GB39	*Drag Washer B
7	GB66	*Drag Drive
8	GB86	Bearing Washer
9	GB56	Center Shaft Washer
10	GB315	Center Shaft Assy.
11	GB6	Rotor Nut
12	GB309	Rotor
13	GB22	Bail Spring
14	GB87	Bail Spring Cover
15	EB85	Bail Spring Cover Screw
16	GB51	Bail Screw A
17	GB108	Bail Axle Screw
18	GB102	Bail Axle Washer
19	GB7	Bail Arm A
20	FB16	Line Roller Bushing
21	FB4	Line Roller

Key No.	Part No.	Description
22	GB310	Bail Assembly
23	GB81	Front Pinion Spacer
24	GB40	Bearing Retainer
25	GB28	Pinion Bearing
26	GB113	Rear Pinion Spacer
27	GB60	Anti-Reverse Ratchet
28	GB11	Pinion
29	GB105	Handle Retainer Washer
30	GB54	Handle Retainer Cover
31	EB73	Handle Screw Cover
32	GB59	Anti-Reverse Knob
33	GB69	Anti-Rev. Knob Spring
34	GB63	Anti-Reverse Pawl
35	FB61	Anti-Rev. Pawl Spring
36	FB80	Anti-Rev. Pawl Screw
37	GB301	Body Assembly
38	GB53	Oscillator Gear
39	GB25	Oscillator Slider
40	FB100	Osc. Slider Screw A
41	GB80	Osc. Slider Screw B
42	GB12	Crank Gear
43	GB92	Crank Gear Shim
44	GB23	Side Plate
45	CB57	Side Plate Screw
46	GB318	Crank Handle Assy.
47	GB84	Bail Screw B

*Available As One Unit,
GB321 Spool Assembly

TEBCO 6070

weight	23.7 oz./672 g
pound test	17 20* 25
yards	300 235 185
meters	274 215 169
gear ratio	4.7:1