

# ZEBCO 6040

weight	13.9 oz./394 g
pound test	8 10* 12
yards	315 240 190
meters	288 220 174
gear ratio	4:1

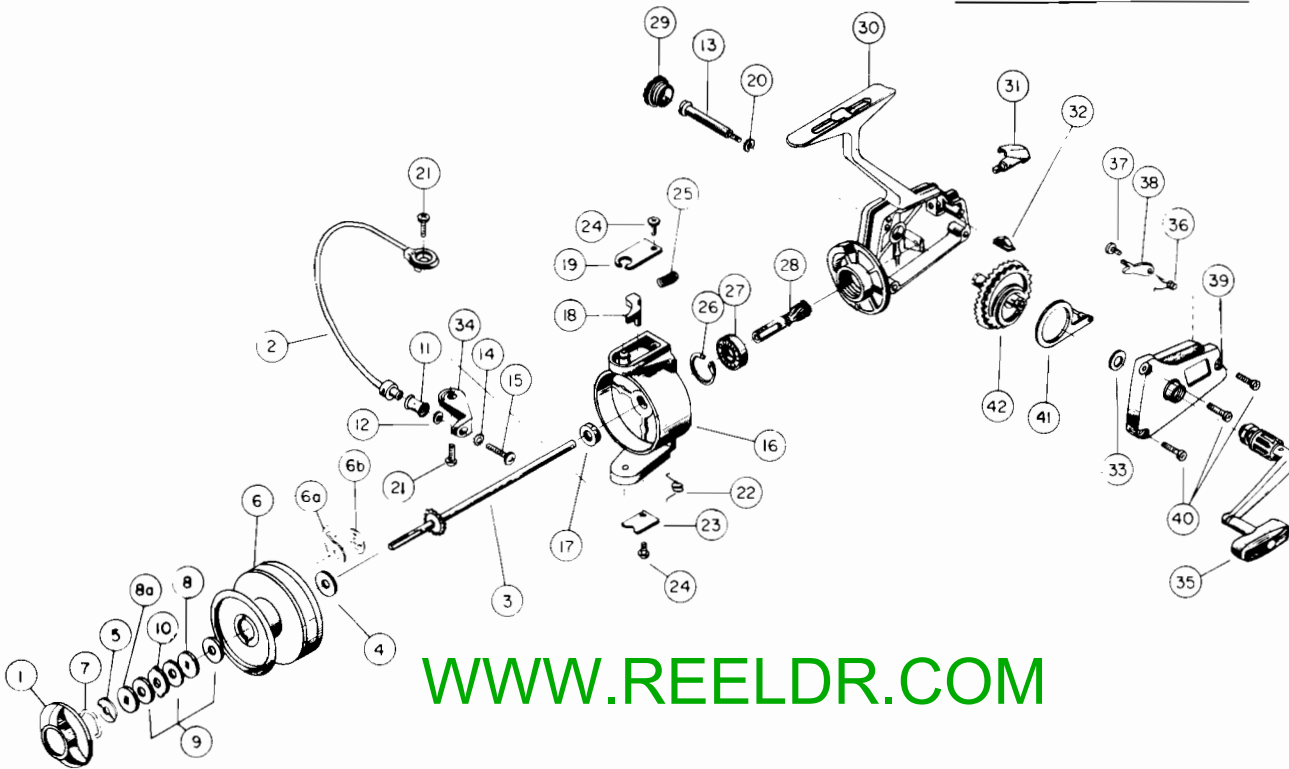

[WWW.REELDR.COM](http://WWW.REELDR.COM)

Key No.	Part No.	Description	Key No.	Part No.	Description
1	EB32	Drag Knob Assy.	21	EB51	Bail Screw
2	EB347	Bail Assembly	22	EB22	Bail Spring
3	EB315	Center Shaft Assy.	23	EB87	Bail Spring Cover
4	EB45	Center Shaft Washer	24	EB85	Bail Cover Screw
5	DB109	Spring Washer	25	EB49	Bail Trip Spring
6	EB21	*Spool (Incomplete) (See Assy)	26	DB40	Bearing Retainer
6A	CB67	*Click Spring	27	DB28	Pinion Bearing
6B	CB68	*Click Spring Retainer	28	EB11	Pinion
7	DB36	*Drag Retainer Clip	29	EB73	Handle Retainer Cover
8	DB30	*Drag Washer A	30	EB301	Body Assembly
8A	DB26	*Drag Washer C	31	EB59	Anti-Reverse Knob
9	DB39	*Drag Washer B	32	EB69	Anti-Rev. Knob Spring
10	DB66	Drag Drive	33	EB27	Crank Gear Shim
11	CB4	Line Roller	34	EB7	Bail Arm A
12	CB16	Line Roller Bushing	35	EB318	Crank Handle Assy.
13	EB54	Handle Retainer Screw	36	EB61	Anti-Rev. Pawl Spring
14	CB102	Bail Axle Washer	37	EB80	Ant-Rev. Pawl Screw
15	CB108	Bail Axle Screw	38	EB63	Anti-Reverse Pawl
16	EB9	Rotor	39	EB323	Side Plate Assy.
17	DB6	Rotor Nut	40	CB57	Side Plate Screw
18	EB19	Bail Trip Lever	41	EB25	Oscillator Slider
19	EB24	Bail Trip Cover	42	EB12	Crank Gear
20	EB105	Handle Retainer Washer			

\*Available As One Unit,  
EB321 Spool Assembly

PLEASE ORDER BY PART NUMBER