

TEBCO 6020

weight	11.4 oz./323 g
pound-test	8 8" 10
yards	330 220 165
meters	302 201 151
gear ratio	4.7:1

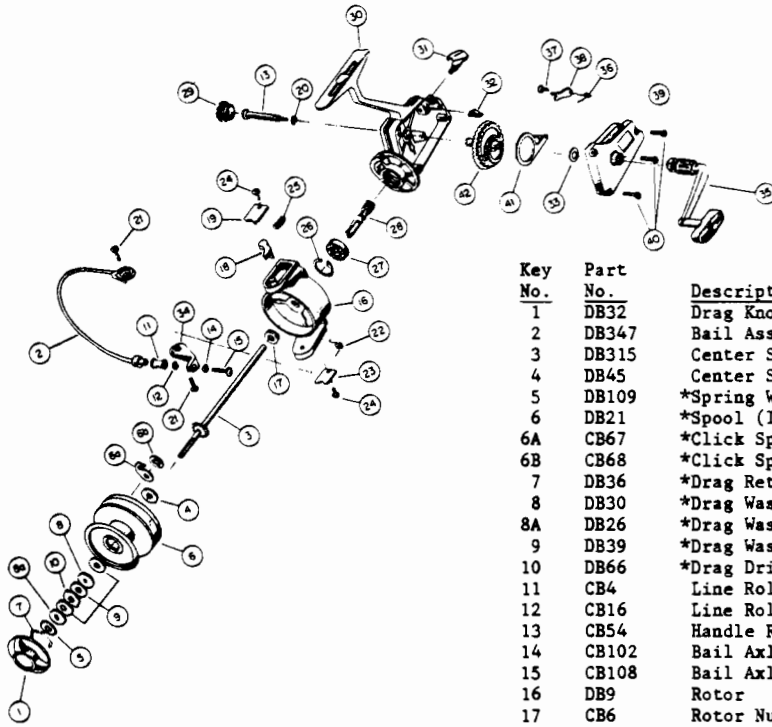

Key No.	Part No.	Description
1	DB32	Drag Knob
2	DB347	Bail Assembly
3	DB315	Center Shaft Assy.
4	DB45	Center Shaft Washer
5	DB109	*Spring Washer
6	DB21	*Spool (Incomplete) (See Assy)
6A	CB67	*Click Spring
6B	CB68	*Click Spring Retainer
7	DB36	*Drag Retainer Clip
8	DB30	*Drag Washer A
8A	DB26	*Drag Washer C
9	DB39	*Drag Washer B
10	DB66	*Drag Drive
11	CB4	Line Roller
12	CB16	Line Roller Bushing
13	CB54	Handle Retainer Screw
14	CB102	Bail Axle Washer
15	CB108	Bail Axle Screw
16	DB9	Rotor
17	CB6	Rotor Nut
18	DB19	Bail Trip Lever
19	DB24	Bail Trip Cover
20	CB105	Handle Retainer Washer

Key No.	Part No.	Description
21	CB51	Bail Screw
22	DB22	Bail Spring
23	DB87	Bail Spring Cover
24	DB85	Bail Cover Screw
25	DB49	Bail Trip Spring
26	DB40	Bearing Retainer
27	DB28	Pinion Bearing
28	DB11	Pinion
29	CB73	Handle Screw Cover
30	DB301	Body Assembly
31	CB59	Anti-Reverse Knob
32	CB69	Anti-Rev. Knob Spring
33	CB27	Crank Gear Shim
34	DB7	Bail Arm A
35	DB318	Crank Handle Assy.
36	CB61	Anti-Rev. Pawl Spring
37	CB80	Anti-Rev. Pawl Screw
38	CB63	Anti-Reverse Pawl
39	DB323	Side Plate Assy.
40	CB57	Side Plate Screw
41	DB25	Oscillator Slider
42	DB12	Crank Gear

*Available As One Unit,
DB321 Spool Assembly

WWW.REELDR.COM

TEBCO 6040

weight	13.9 oz./394 g
pound test	8 10" 12
yards	315 240 190
meters	288 220 174
gear ratio	4:1

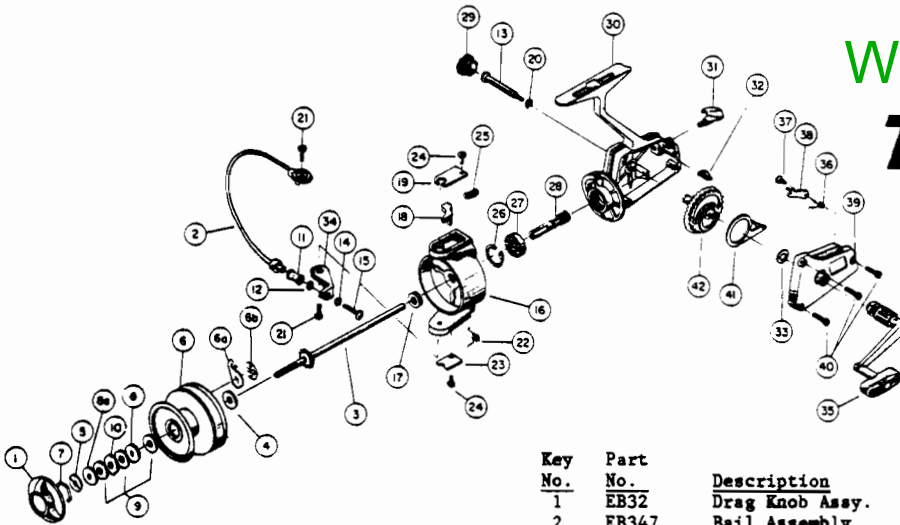

Key No.	Part No.	Description
1	EB32	Drag Knob Assy.
2	EB347	Bail Assembly
3	EB315	Center Shaft Assy.
4	EB45	Center Shaft Washer
5	DB109	Spring Washer
6	EB21	*Spool (Incomplete) (See Assy)
6A	CB67	*Click Spring
6B	CB68	*Click Spring Retainer
7	DB36	*Drag Retainer Clip
8	DB30	*Drag Washer A
8A	DB26	*Drag Washer C
9	DB39	*Drag Washer B
10	DB66	Drag Drive
11	CB4	Line Roller
12	CB16	Line Roller Bushing
13	EB54	Handle Retainer Screw
14	CB102	Bail Axle Washer
15	CB108	Bail Axle Screw
16	EB9	Rotor
17	DB6	Rotor Nut
18	EB19	Bail Trip Lever
19	EB24	Bail Trip Cover
20	EB105	Handle Retainer Washer

Key No.	Part No.	Description
21	EB51	Bail Screw
22	EB22	Bail Spring
23	EB87	Bail Spring Cover
24	EB85	Bail Cover Screw
25	EB49	Bail Trip Spring
26	DB40	Bearing Retainer
27	DB28	Pinion Bearing
28	EB11	Pinion
29	EB73	Handle Retainer Cover
30	EB301	Body Assembly
31	EB59	Anti-Reverse Knob
32	EB69	Anti-Rev. Knob Spring
33	EB27	Crank Gear Shim
34	EB7	Bail Arm A
35	EB318	Crank Handle Assy.
36	EB61	Anti-Rev. Pawl Spring
37	EB80	Anti-Rev. Pawl Screw
38	EB63	Anti-Reverse Pawl
39	EB323	Side Plate Assy.
40	CB57	Side Plate Screw
41	EB25	Oscillator Slider
42	EB12	Crank Gear

*Available As One Unit,
EB321 Spool Assembly