

ZEBCO 6020

weight	11.4 oz./323 g
pound-test	6 8* 10
yards	330 220 166
meters	302 201 151
gear ratio	4.7:1

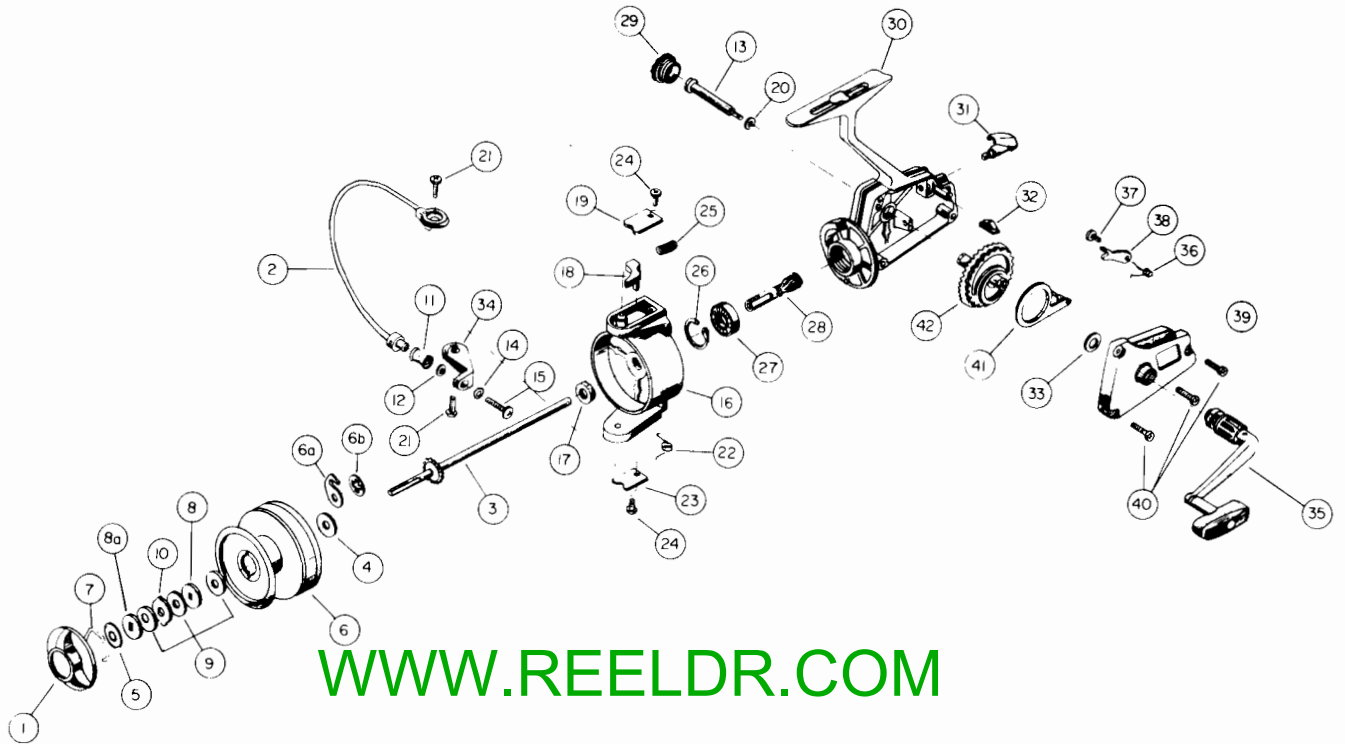

WWW.REELDR.COM

Key No.	Part No.	Description	Key No.	Part No.	Description
1	DB32	Drag Knob	21	CB51	Bail Screw
2	DB347	Bail Assembly	22	DB22	Bail Spring
3	DB315	Center Shaft Assy.	23	DB87	Bail Spring Cover
4	DB45	Center Shaft Washer	24	DB85	Bail Cover Screw
5	DB109	*Spring Washer	25	DB49	Bail Trip Spring
6	DB21	*Spool (Incomplete) (See Assy)	26	DB40	Bearing Retainer
6A	CB67	*Click Spring	27	DB28	Pinion Bearing
6B	CB68	*Click Spring Retainer	28	DB11	Pinion
7	DB36	*Drag Retainer Clip	29	CB73	Handle Screw Cover
8	DB30	*Drag Washer A	30	DB301	Body Assembly
8A	DB26	*Drag Washer C	31	CB59	Anti-Reverse Knob
9	DB39	*Drag Washer B	32	CB69	Anti-Rev. Knob Spring
10	DB66	*Drag Drive	33	CB27	Crank Gear Shim
11	CB4	Line Roller	34	DB7	Bail Arm A
12	CB16	Line Roller Bushing	35	DB318	Crank Handle Assy.
13	CB54	Handle Retainer Screw	36	CB61	Anti-Rev. Pawl Spring
14	CB102	Bail Axle Washer	37	CB80	Anti-Rev. Pawl Screw
15	CB108	Bail Axle Screw	38	CB63	Anti-Reverse Pawl
16	DB9	Rotor	39	DB323	Side Plate Assy.
17	CB6	Rotor Nut	40	CB57	Side Plate Screw
18	DB19	Bail Trip Lever	41	DB25	Oscillator Slider
19	DB24	Bail Trip Cover	42	DB12	Crank Gear
20	CB105	Handle Retainer Washer			

*Available As One Unit,
DB321 Spool Assembly

PLEASE ORDER BY PART NUMBER