

# ZEBCO 6020

weight	11.4 oz./323 g		
pound-test	6	8	10
yards	330	220	165
meters	302	201	151
gear ratio	4.7:1		

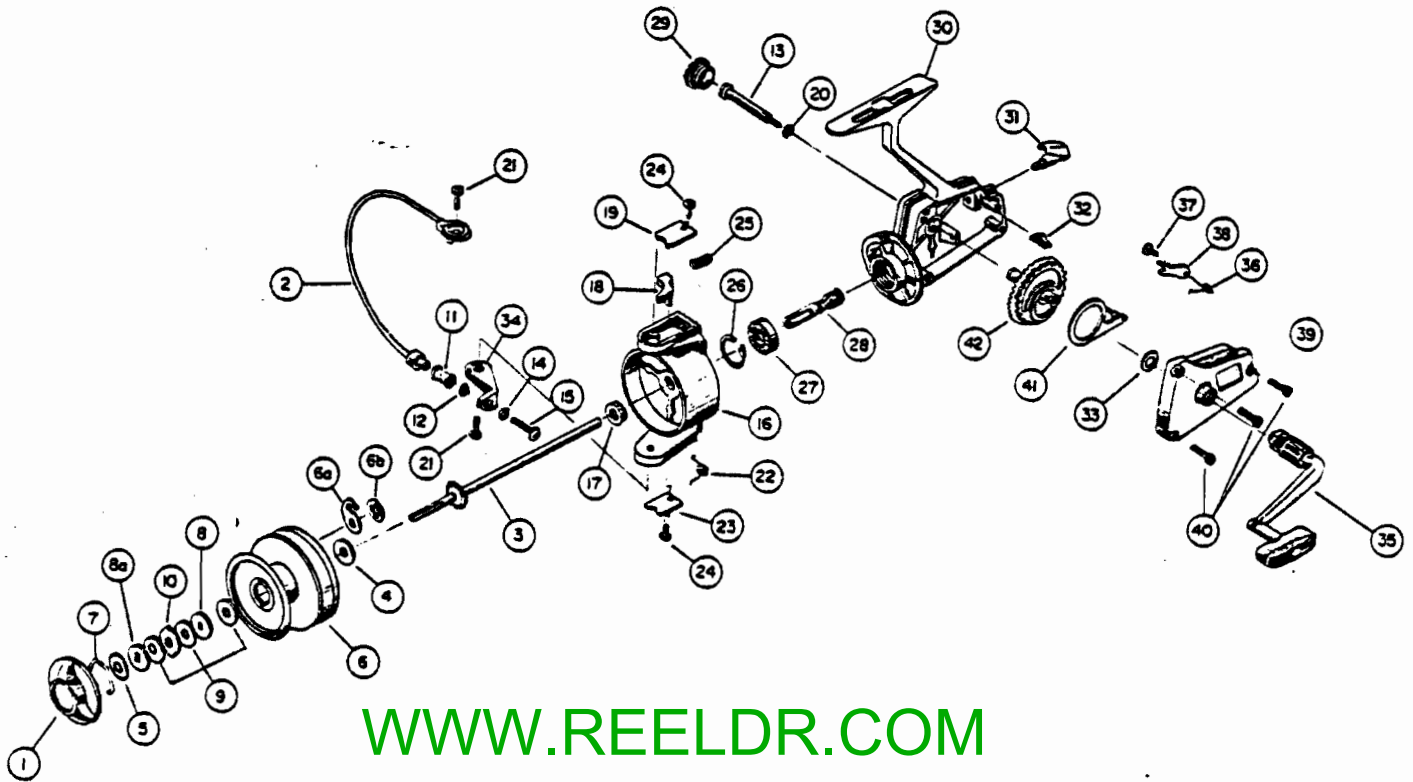

[WWW.REELDR.COM](http://WWW.REELDR.COM)

KEY No.	PART No.	NEW PART No.	DESCRIPTION	PRICE	KEY No.	PART No.	NEW PART No.	DESCRIPTION	PRICE
1	DB32		DRAG KNOB	\$1.75	21	DB51	CB51	BAIL SCREW	\$ .25
2	DB347		BAIL ASSY.	2.95	22	DB22		BAIL SPRING	.25
3	DB315		CENTER SHAFT ASSY.	1.75	23	DB87		BAIL SPRING COVER	.45
4	DB45		CENTER SHAFT WASHER	.25	24	DB85		BAIL COVER SCREW	.25
5	DB109		SPRING WASHER	.40	25	DB49		BAIL TRIP SPRING	.25
6	DB21		SPOOL (INCOMPLETE)	5.45	26	DB40		BEARING RETAINER	.25
6A	DB67	CB67	CLICK SPRING	.25	27	DB28		PINION BEARING	4.75
6B	DB68	CB68	CLICK SPRING RETAINER	.25	28	DB11		PINION	1.95
7	DB36		DRAG RETAINER CLIP	.25	29	DB73	CB73	HANDLE SCREW COVER	.45
8	DB30		DRAG WASHER A	.25	30	DB301		BODY ASSY.	6.75
8A	DB26		DRAG WASHER C	.25	31	DB59	CB59	ANTI-REVERSE KNOB	.85
9	DB39		DRAG WASHER B	.25	32	DB69	CB69	ANTI-REVERSE KNOB SPRING	.35
10	DB66		DRAG DRIVE	.25	33	DB27	CB27	CRANK GEAR SHIM	.25
11	DB4	CB4	LINE ROLLER	.55	34	DB7		BAIL ARM A	1.05
12	DB16	CB16	LINE ROLLER BUSHING	.45	35	DB318		CRANK HANDLE ASSY.	4.95
13	DB54	CB54	HANDLE RETAINER SCREW	.55	36	DB61	CB61	ANTI-REVERSE PAWL SPRING	.25
14	DB102	CB102	BAIL AXLE WASHER	.25	37	DB80	CB80	ANTI-REVERSE PAWL SCREW	.25
15	DB108	CB108	BAIL AXLE SCREW	.25	38	DB63	CB63	ANTI-REVERSE PAWL	.55
16	DB9		ROTOR	4.85	39	DB323		SIDE PLATE ASSY.	3.95
17	DB6		ROTOR NUT	.25	40	DB57	CB57	SIDE PLATE SCREW	.25
18	DB19		BAIL TRIP LEVER	.65	41	DB25		OSCILLATOR SLIDER	.75
19	DB24		BAIL TRIP COVER	.45	42	DB12		CRANK GEAR	2.45
20	DB105	CB105	HANDLE RETAINER WASHER	.25	*AVAILABLE AS ONE UNIT, DB321 SPOOL ASSY.				7.00

PLEASE ORDER BY NEW PART NUMBER WHEN APPLICABLE

Zebco Division Brunswick Corporation, Box 270, Tulsa OK 74101 USA 918-336-5581

