

ZEBCO 6010

weight	9.3 oz./264 g
pound test	4 6* 8
yards	260 185 125
meters	238 169 114
gear ratio	5.1:1

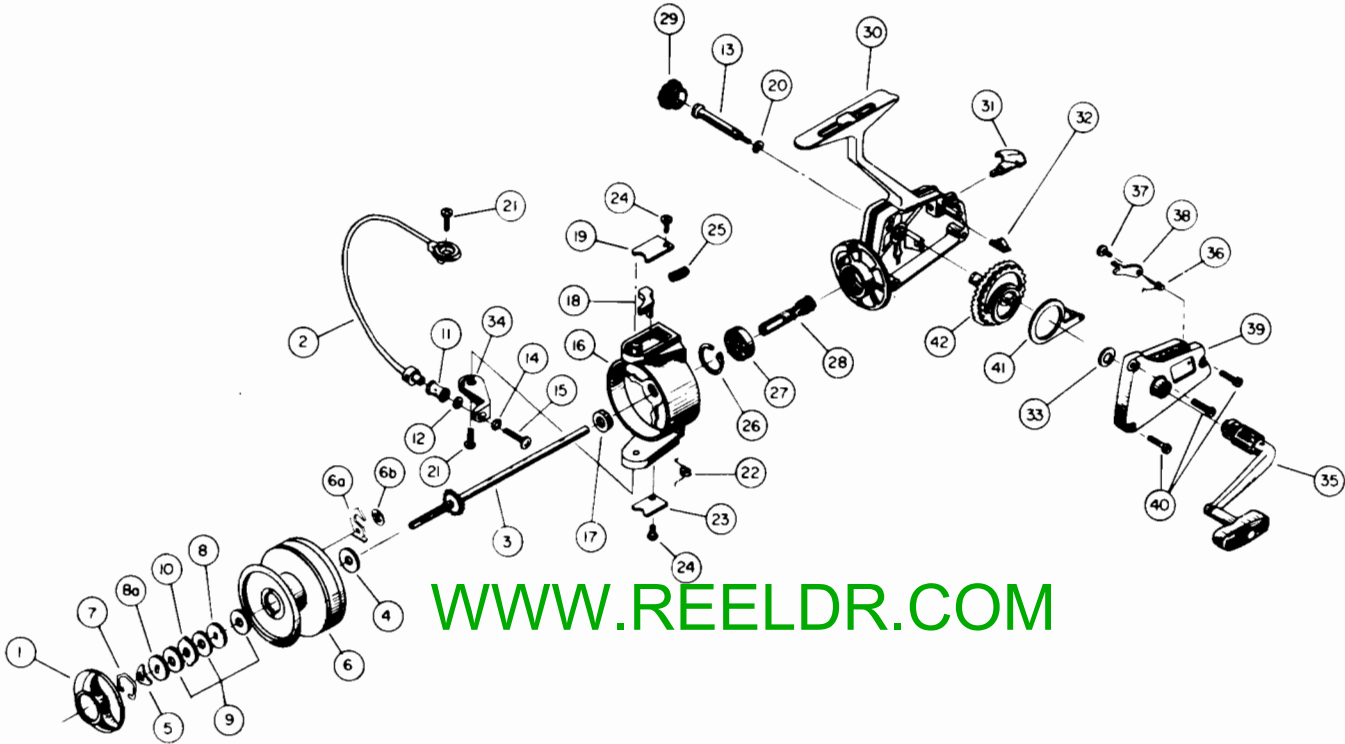

WWW.REELDR.COM

Key No.	Part No.	Description	Key No.	Part No.	Description
1	CB32	Drag Knob Assy.	21	CB51	Bail Screw
2	CB347	Bail Assembly	22	CB22	Bail Spring
3	CB315	Center Shaft Assy.	23	CB87	Bail Spring Cover
4	CB45	Center Shaft Washer	24	CB85	Bail Cover Screw
5	CB109	*Spring Washer	25	CB49	Bail Trip Spring
6	CB21	*Spool (Incomplete) (See Assy)	26	CB40	Bearing Retainer
6A	CB67	*Click Spring	27	CB28	Pinion Bearing
6B	CB68	*Click Spring Retainer	28	CB11	Pinion Gear
7	CB36	*Drag Retainer Clip	29	CB73	Handle Retainer Cover
8	CB30	*Drag Washer "A"	30	CB301	Body Assembly
8A	CB26	*Drag Washer "C"	31	CB59	Anti-Reverse Knob
9	CB39	*Drag Washer "B"	32	CB69	Anti-Rev. Knob Spring
10	CB66	*Drag Drive	33	CB27	Crank Gear Shim
11	CB4	Line Roller	34	CB7	Bail Arm A
12	CB16	Line Roller Bushing	35	CB318	Crank Handle Assy.
13	CB54	Handle Retainer	36	CB61	Anti-Rev. Pawl Spring
14	CB102	Bail Axle Washer	37	CB80	Anti-Rev. Pawl Screw
15	CB108	Bail Axle Screw	38	CB63	Anti-Reverse Pawl
16	CB9	Rotor	39	CB323	Side Plate Assy.
17	CB6	Rotor Nut	40	CB57	Side Plate Screw
18	CB19	Bail Trip Lever	41	CB25	Oscillator Slider
19	CB24	Bail Trip Cover	42	CB12	Crank Gear
20	CB105	Handle Retainer Washer			

*Available As One Unit,
CB321 Spool Assembly

PLEASE ORDER BY PART NUMBER