

ZEBCO 600™

weight	7.5 oz/213 g
pound test	6 6 10 12
yards	155 110 75 70
meters	142 101 69 64

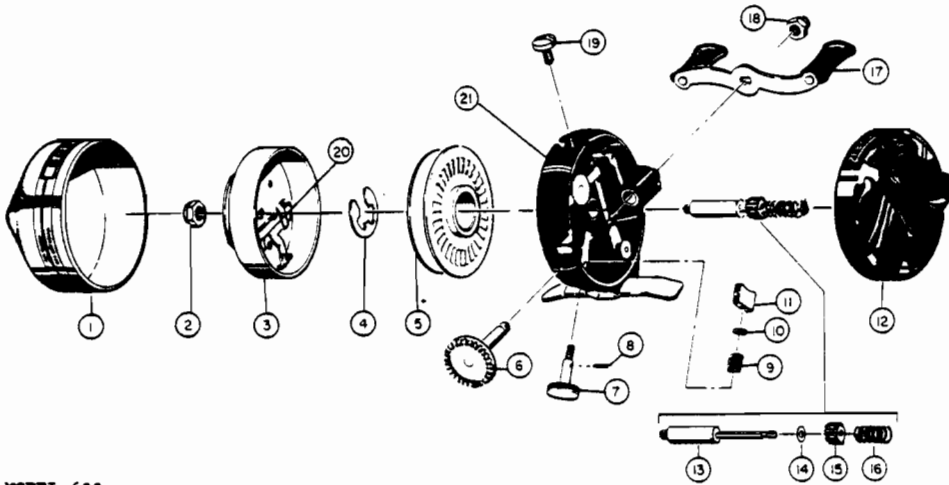

MODEL 600

Key No.	Part No.	Description	Key No.	Part No.	Description
1	UZ324	Front Cover Assy.	12	UZ323	Back Cover Assy.
2	UZ006	Spinner Head Nut	13	UZ015	*Center Shaft
3	UZ310	Spinner Head Assy.	14	UZ077	*Washer
4	XZ034	Spool Clip	15	JZ011	*Pinion Gear
5	UZ021	Spool (Empty)	16	XZ020	*Center Shaft Spring
	UZ321-10M	Spool w/10# Zebco Line	17	LZ318	Crank Handle Assy.
6	OZ308	Crank Shaft	18	XZ003-1	Crank Nut
7	UZ032	Adj. Screw	19	UZ055	Cover Lock Screw
8	OZ029	Retainer Pin	20	PZ049	Spinner Head Spring
9	UZ039	Adj. Screw Spring	21	UZ301	Body Assy.
10	UZ030	Adj. Screw Washer			
11	UZ052	Brake Shoe			

*Available As One Unit,
UZ315 Center Shaft Assy.

WWW.REELDR.COM

ZEBCO 700™

weight	11 oz/312 g
pound test	20
yards	80
meters	73

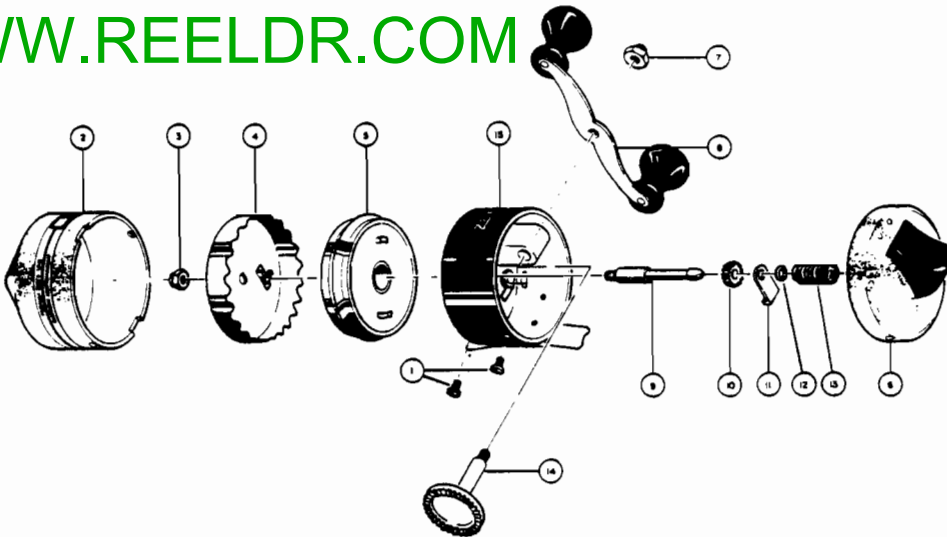

MODEL 700

Key No.	Part No.	Description	Key No.	Part No.	Description
1	SZ055	Cover Lock Screw	9	SZ015	*Center Shaft
2	SZ324	Front Cover Assembly	10	SZ011	*Pinion Gear
3	JZ006	Spinner Head Nut	11	SZ014	*Anti-Reverse Drag
4	EZ310	Spinner Head Assembly	12	AZ106	*Brass Washer
5	SZ021	Spool (Empty)	13	SZ020	*Center Shaft Spring
	SZ321-20M	Spool w/20# Zebco Line	14	SZ308	Crank Shaft Assembly
6	SZ323	Back Cover Assembly	15	SZ301	Body Assembly
7	QZ003	Crank Nut (or QZ003-B)			
8	PZ318	Crank Handle Assembly			

*Available as One Unit,
SZ315 Center Shaft Assembly