

ZEBCO 6000

weight	7.6 oz./216 g
pound test	2 4 8
yards	210 130 90
meters	192 119 82
gear ratio	4.4:1

WWW.REELDR.COM

Key No.	Part No.	Description
1	HB37	Drag Knob
2	HB347	Bail Assembly
3	HB315	Center Shaft
4	HB16	Center Shaft Washer
5	CB39	*Drag Washer B
6	HB21	*Spool (Incomplete) (See Assy)
6A	HB55	*Click Spring
6B	CB68	*Click Spring Retainer
7	CB30	*Drag Washer A
8	HB32	*Drag Drive
9	CB26	*Drag Washer C
10	CB109	*Spring Washer
11	CB36	*Drag Retainer Clip
12	CB4	Line Roller
13	CB16	Line Roller Bushing
14	HB3	Bail Arm A
15	CB102	Bail Axle Washer
16	HB7	Bail Axle Screw
17	HB8	Bail Screw A
18	HB10	Bail Screw B
19	CB6	Rotor Nut
20	HB9	Rotor
21	HB22	Bail Spring
22	HB25	Bail Spring Cover
23	HB50	Bail Cover Screw
24	HB20	Bail Trip Spring

Key No.	Part No.	Description
25	HB19	Bail Trip Lever
26	HB24	Bail Trip Cover
27	HB50	Bail Cover Screw
29	CB40	Bearing Retainer
30	HB28	Pinion Bearing
31	HB29	Pinion Spacer
32	HB40	Anti-Rev. Ratchet
33	HB11	Pinion Gear
34	HB301	Body Assembly
35	HB41	Anti-Reverse Pawl
36	HB42	Anti-Rev. Pawl Spring
37	HB49	Anti-Reverse Screw
38	HB38	Anti-Reverse Knob
39	CB69	Anti-Rev. Knob Spring
40	HB44	Oscillator Slider Link
41	HB12	Crank Gear
42	HB43	Oscillator Slider
43	CB27	Crank Gear Shim
44	HB323	Side Plate Assy.
45	HB48	Side Plate Screw
46	HB318	Crank Handle Assy.
47	CB105	Handle Retainer Washer
48	HB52	Handle Retainer
49	CB73	Handle Screw Cover

*Available As One Unit, HB321 Spool Assy.

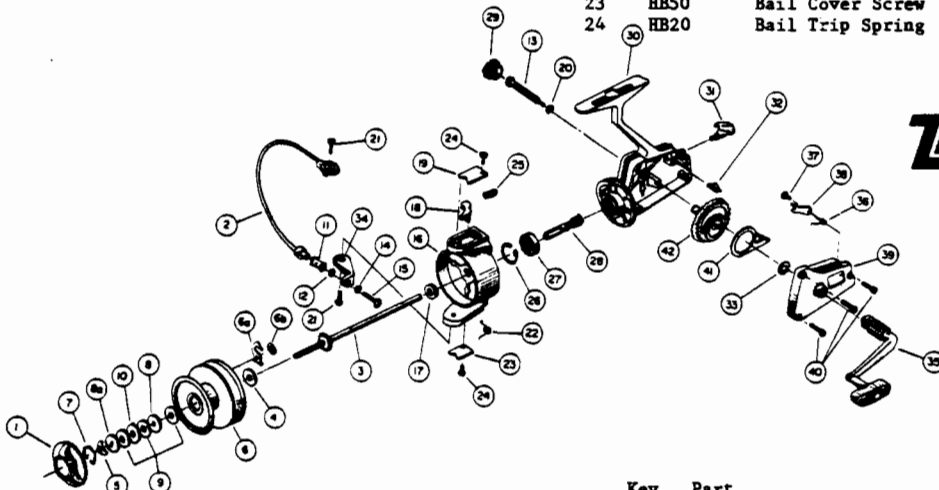

ZEBCO 6010

weight	9.3 oz./264 g
pound test	4 8 8
yards	280 185 125
meters	238 169 114
gear ratio	5.1:1

Key No.	Part No.	Description
1	CB32	Drag Knob Assy.
2	CB347	Bail Assembly
3	CB315	Center Shaft Assy.
4	CB45	Center Shaft Washer
5	CB109	*Spring Washer
6	CB21	*Spool (Incomplete) (See Assy)
6A	CB67	*Click Spring
6B	CB68	*Click Spring Retainer
7	CB36	*Drag Retainer Clip
8	CB30	*Drag Washer "A"
8A	CB26	*Drag Washer "C"

Key No.	Part No.	Description
9	CB39	*Drag Washer "B"
10	CB66	*Drag Drive
11	CB4	Line Roller
12	CB16	Line Roller Bushing
13	CB54	Handle Retainer
14	CB102	Bail Axle Washer
15	CB108	Bail Axle Screw
16	CB9	Rotor
17	CB6	Rotor Nut
18	CB19	Bail Trip Lever
19	CB24	Bail Trip Cover
20	CB105	Handle Retainer Washer

Key No.	Part No.	Description
21	CB51	Bail Screw
22	CB22	Bail Spring
23	CB87	Bail Spring Cover
24	CB85	Bail Cover Screw
25	CB49	Bail Trip Spring
26	CB40	Bearing Retainer
27	CB28	Pinion Bearing
28	CB11	Pinion Gear
29	CB73	Handle Retainer Cover
30	CB301	Body Assembly
31	CB59	Anti-Reverse Knob
32	CB69	Anti-Rev. Knob Spring
33	CB27	Crank Gear Shim
34	CB7	Bail Arm A
35	CB318	Crank Handle Assy.
36	CB61	Anti-Rev. Pawl Spring
37	CB80	Anti-Rev. Pawl Screw
38	CB63	Anti-Reverse Pawl
39	CB323	Side Plate Assy.
40	CB57	Side Plate Screw
41	CB25	Oscillator Slider
42	CB12	Crank Gear

*Available As One Unit, CB321 Spool Assembly