

# ZEBCO 404™

weight	7.5 oz./213 g			
pound test	8	10	12	15
yards	115	85	80	75
meters	105	78	73	69

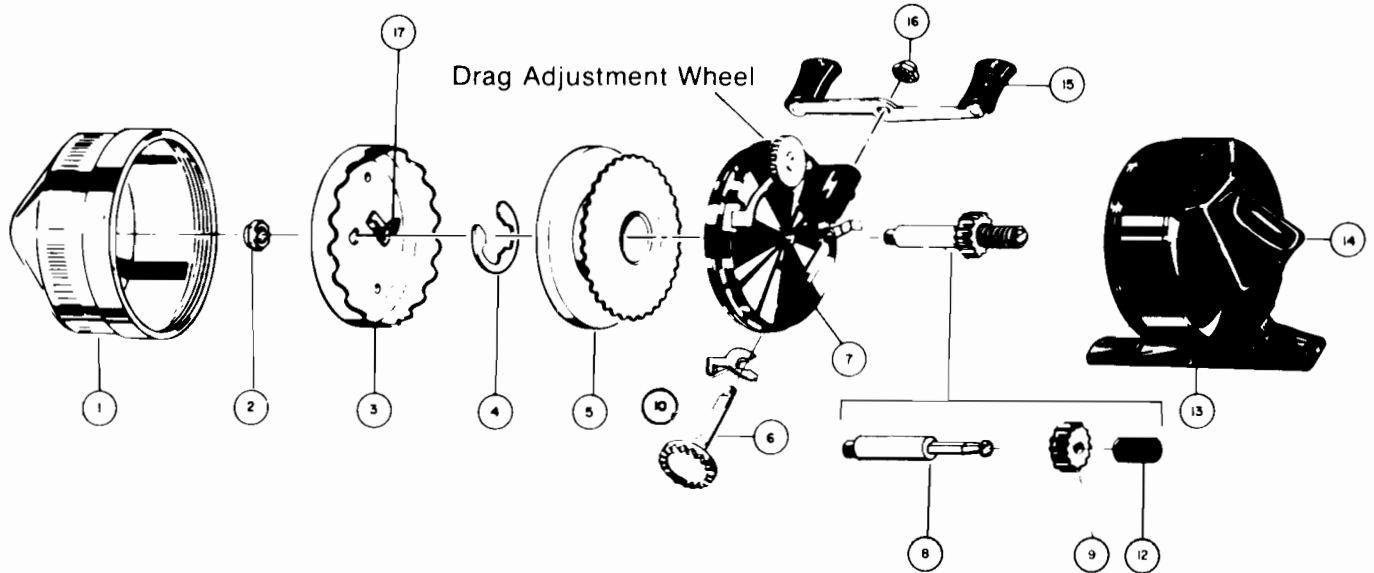

MODEL 404

[WWW.REELDR.COM](http://WWW.REELDR.COM)

Key No.	Part No.	Description	Key No.	Part No.	Description
1	EZ324	Front Cover Assy.	9	JZ011	*Pinion
2	JZ006	Spinner Head Nut	10	EZ014	Anti-Rev. Actuator
3	EZ310	Spinner Head	12	XZ020	*Center Shaft Spring
4	XZ034	Spool Clip	13	EZ323	Back Cover w/Th. Brk.
5	EZ021	Spool (Empty)	14	XZ009-1	Thumb Brake
	EZ321-15T	Spool w/15# Trilene	15	EZ318-1	Crank Handle Assy.
6	EZ308	Crank Shaft	16	XZ003-1	Crank Nut
7	EZ301	Body Assembly	17	EZ027	Spinner Head Spring
8	*EZ015	Center Shaft Assy.			

\*Available As One Unit,  
EZ315 Center Shaft Assy.

**NOTE:** Model 404 reels manufactured prior to May 1, 1982 use the following parts:

EZ301-B	Body Assembly (B)	
EZ308-B	Crank Shaft Assy. (B)	
EZ315-B	Center Shaft Assy. (B)	
EZ014	Anti-Rev. Actuator	Not Used

PLEASE ORDER BY PART NUMBER

Zebco Division Brunswick Corporation, Box 270, Tulsa OK 74101 USA 918 836 5581