

ZEBCO 20/10™

weight	6.0 oz./170 g		
pound test	4	6	8
yards	125	100	85
meters	114	91	78

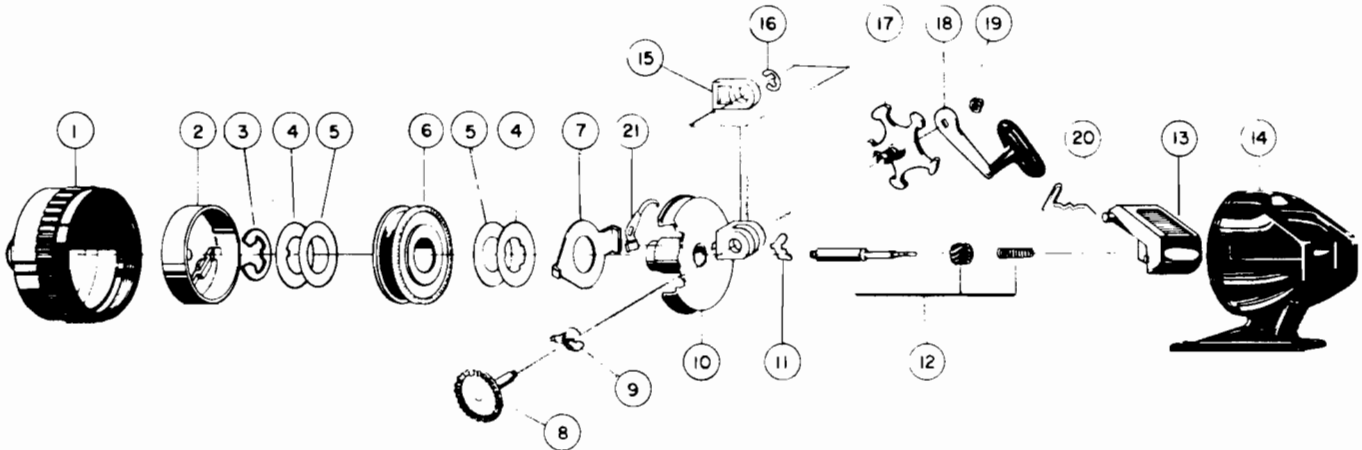

WWW.REELDR.COM

NOTE: Should the anti-reverse pawl (11) drop out while changing spool, be sure to put into body subassembly with largest flange pointing toward base of reel as shown in schematic. Make sure the arm of the pawl actuator (9) rests in the center of the anti-reverse pawl to reassemble.

MODEL 2010

Key No.	Part No.	Description
1	QY324	Front Cover Assembly
2	QY310	Spinner Head Assy.
3	XZ034	Spool Clip
4	BJ040	Spool Washer (Metal)
5	BJ108	Drag Washer (Plastic)
6	QY021	Spool (Empty)
	QY321-6T	Spool w/6# Trilene
	QY321-4T	Spool w/4# Trilene
7	QY027	Clutch Ring
8	QY308	Crank Shaft Assy.
9	JY061	Anti-Rev. Pawl Actuator
10	QY301	Body Assembly

Key No.	Part No.	Description
11	JY060	Anti-Reverse Pawl
12	QY315	Center Shaft Assembly
13	QY009	*Thumb Brake
14	QY323	Back Cover w/Th. Brk.
15	JY054	Slide Drag Actuator
16	JY121	Retainer Clip
17	QY026	Crank Bushing (Star Dr.)
18	QY318	Crank Handle Assy.
19	AZ003	Crank Nut (Locking)
20	QY038	*Thumb Brake Spring
21	NY033	Spool Click Spring

*Available Separate Or With Back Cover Assembly.

PLEASE ORDER BY PART NUMBER

Zebco Division Brunswick Corporation, Box 270, Tulsa, OK 74101 USA 918-836-5581