

# ZEBCO 202™

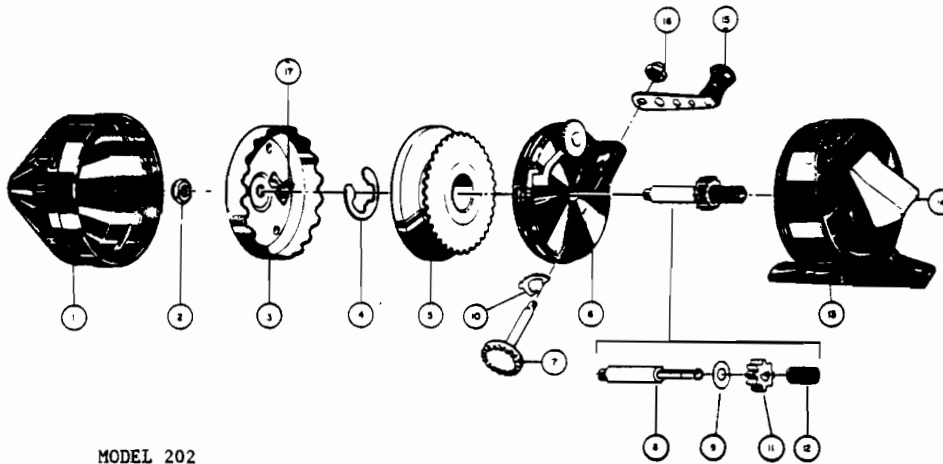

weight	6 oz./170 g			
pound test	6	8	10	12
yards	125	90	70	50
meters	114	82	64	55

## MODEL 202

Key No.	Part No.	Description
1	XZ324	Front Cover Assy.
2	JZ006	Spinner Head Nut
3	XZ310	Spinner Head
4	XZ034	Spool Retainer Clip
5	XZ021	Spool (Empty)
	XZ321-10M	Spool w/10# Zebco Line
6	XZ301	Body Assembly
7	XZ308	Crank Shaft
8	XZ015	*Center Shaft
9	UZ077	*Washer

Key No.	Part No.	Description
10	XZ063	Anti-Reverse Pawl
11	JZ011	*Pinion
12	XZ020	*Center Shaft Spring
13	XZ323	Back Cover (Thmb. Brk.)
14	XZ009-1	Thumb Brake
15	XZ318	Crank Handle Assy.
16	XZ003-1	Crank Nut
17	EZ027	Spinner Head Spring

\*Available As One Unit,  
XZ315 Center Shaft Assy.

**NOTE:** Model 202 reels manufactured prior to August 1, 1981, use the following parts:

XZ301-B	Body Assy. (B)
XZ315-B	Center Shaft Assy. (B)
XZ063	Anti-Rev. Pawl

[WWW.REELDR.COM](http://WWW.REELDR.COM)



# ZEBCO 802™

weight	9 oz./255g			
pound-test	10	12	14	17
yards	85	55	50	45
meters	59	50	46	41

## MODEL 802

Key No.	Part No.	Description
1	MZ24-A//SA	Front Cover Assy.
2	MZ10//SA	Spinner Head Assy.
3	GZ034	Spool Clip
4	MZ21//CMP	Spool (Empty)
	MZ321-12T	Spool w/12# Trilene
5	XZ003-1	Crank Nut
6	MZ18-A//SA	Crank Handle
7	MZ23-A//SA	Back Cover w/Th. Brk.
8	MZ31//TP	Brake Bar
9	PZ074	Brake Ring Cap
10	PZ073	Brake Ring Spring
11	MZ46//SA	Brake Ring Assy.
12	WZ22/0	*Center Shaft Clip
13	MZ78//CP	*Shaft Spacer (Top)
14	PZ073	*Brake Ring Spring
15	LZ054	*Nylon Washer
16	GZ52//TP	*Anti-Reverse Drag

Key No.	Part No.	Description
17	JZ11//TP	*Pinion Gear
18	MZ15/3	*Center Shaft
19	MZ085	Clutch Spring
20	MZ7-A//SA	Clutch Shaft
21	MZ8-A//SA	Crank Shaft
22	MZ1-A//SA	Body Assy.
23	MZ84//CP	*Shaft Spacer (Bottom)
24	PZ30/0	Center Shaft Ret. Clip
25	PZ9/1	Thumb Stop
26	MZ086	Clutch Pinion
27	MZ87-A//CP	Crank Bearing Nut
28	MZ59-A//CP	Star Drag
29	MZ26-A//SA	Clutch Gear
30	MZ32-A//TMP	Clutch Screw
31	MZ053	Brake Ring Gasket
32	MZ088	O-Ring
33	PZ49/1	Spinner Head Spring

\*Available as One Unit,  
MZ15//SA Center Shaft Assy.