

# ZEBCO 164™ (Silver)

## CLOSED-FACE SPINNING REEL

|            |                |     |     |
|------------|----------------|-----|-----|
| weight     | 15.5 oz./440 g |     |     |
| pound test | 12             | 14  | 17  |
| yards      | 180            | 165 | 125 |
| meters     | 165            | 151 | 114 |
| gear ratio | 3.5:1          |     |     |

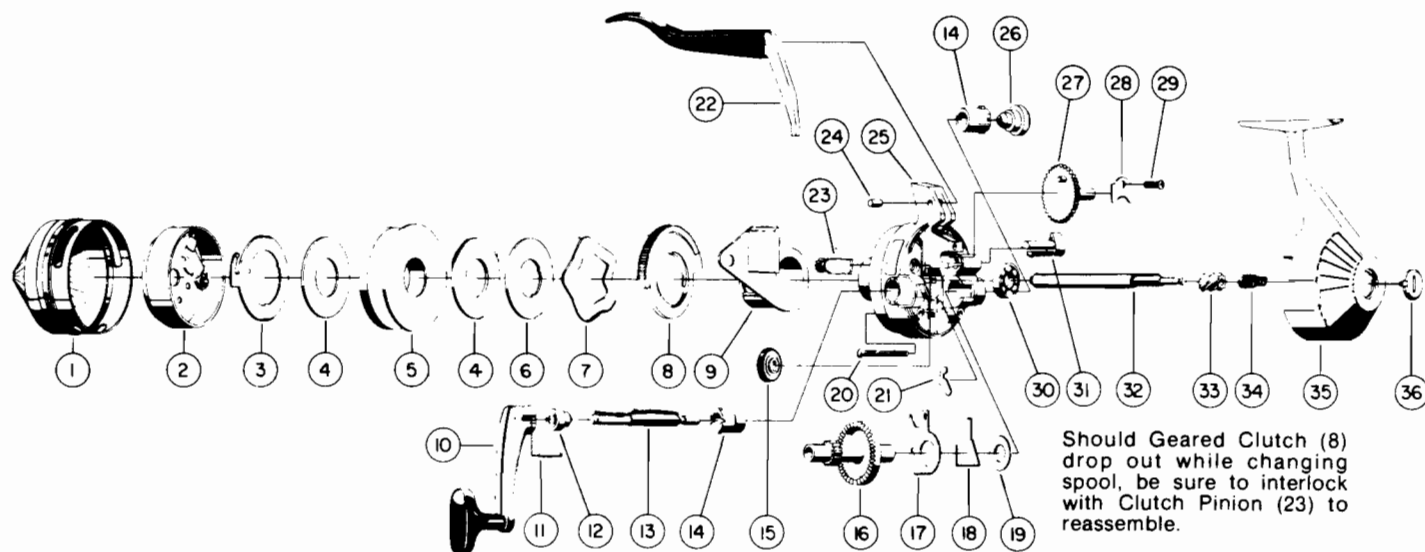

[WWW.REELDR.COM](http://WWW.REELDR.COM)

MODEL 164 (Silver)

| Key No. | Part No.  | Description            | Key No. | Part No. | Description            |
|---------|-----------|------------------------|---------|----------|------------------------|
| 1       | D324-1    | Front Cover (Silver)   | 18      | CJ061    | Anti-Rev. Pawl Sprg.   |
|         | DJ324-2   | Front Cover (Black)    | 19      | CJ106    | Pawl Spring Washer     |
| 2       | DJ310     | Spinner Head Assy.     | 20      | DJ126    | Machine Screw          |
| 3       | DJ034     | Spool Clip             | 21      | DJ060    | Anti-Reverse Pawl      |
| 4       | DJ108     | Flat Washer            | 22      | DJ350    | Finger Brake Assy.     |
| 5       | DJ021     | Spool (Empty)          | 23      | DJ054    | Clutch Pinion          |
|         | DJ321-17T | Spool w/17# Trilene    | 24      | CJ172    | Finger Brake Pin       |
| 6       | DJ040     | Spool Washer           | 25      | DJ301-1  | Body Assy (S)w/bearing |
| 7       | DJ027     | Clutch Ring            | 26      | DJ069    | Crank Rod Nut          |
| 8       | DJ197     | Geared Clutch          | 27      | DJ190    | Oscillator Gear        |
| 9       | DJ189     | Spool Carrier          | 28      | DJ199    | Oscillator Gear Ret.   |
| 10      | DJ318-1   | Crank Handle Assy. (S) | 29      | AJ057    | Retainer Screw         |
| 11      | CJ171     | Crank Handle Pin       | 30      | AZ028    | Ball Bearing           |
| 12      | DJ068     | Crank Handle Spacer    | 31      | DJ002    | Anti-Rev. Actuator     |
| 13      | DJ067     | Crank Rod              | 32      | DJ015    | *Center Shaft          |
| 14      | CJ026     | Crank Bearing          | 33      | CJ011    | *Pinion Gear           |
| 15      | DJ032     | Clutch Wheel           | 34      | DJ020    | *Center Shaft Spring   |
| 16      | DJ012     | Crank Gear             | 35      | DJ023    | Back Cover Assembly    |
| 17      | CJ014     | Anti-Reverse Drag      | 36      | DJ075    | Back Cap               |

\*Available as one unit,  
DJ315 Center Shaft Assy.

PLEASE ORDER BY PART NUMBER

Zebco Division Brunswick Corporation, Box 270, Tulsa, OK 74101 USA 918-836-5581

