

# ZEBCO 164™ (Gold)

## CLOSED-FACE SPINNING REEL

weight	15.5 oz./440 g		
pound test	12	14	17
yards	180	165	125
meters	165	151	114
gear ratio	3.5:1		

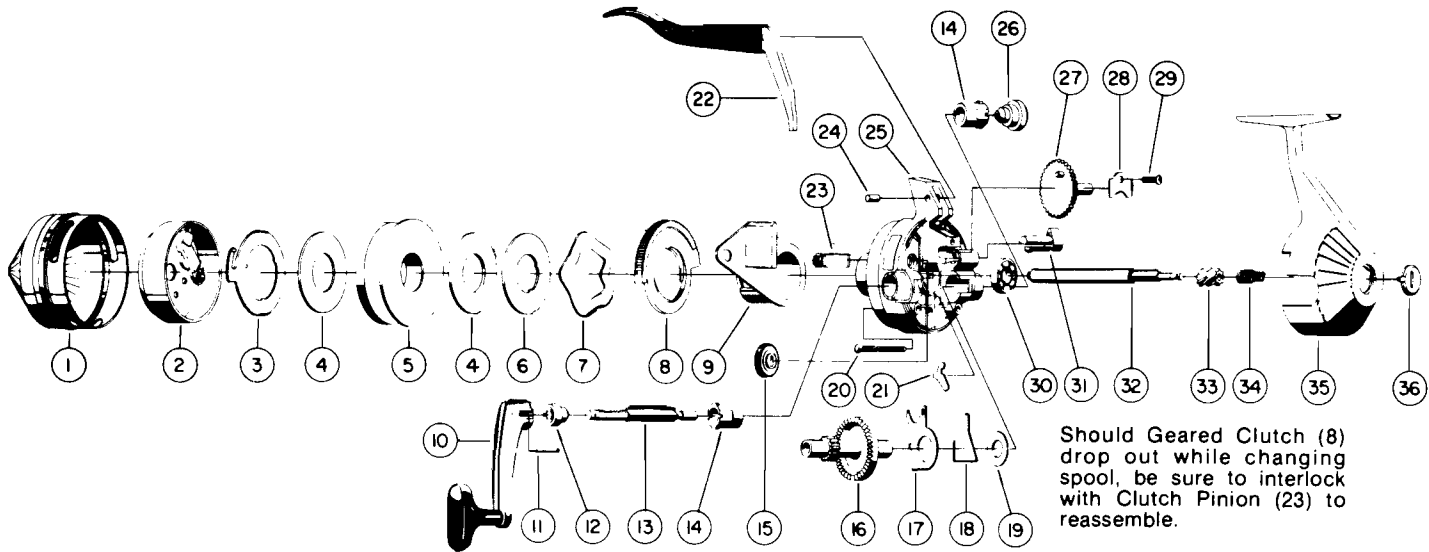

MODEL 164 (Gold)

[WWW.REELDR.COM](http://WWW.REELDR.COM)

Key No.	Part No.	Description
1	DJ324-3	Front Cover Assy. (Gold)
2	DJ310	Spinner Head Assy.
3	DJ034	Spool Clip
4	DJ103	Flat Washer
5	DJ021	Spool (Empty)
	DJ321-17T	Spool w/17# Trilene
6	DJ040	Spool Washer
7	DJ027	Clutch Ring
8	DJ197	Geared Clutch
9	DJ189	Spool Carrier
10	DJ318-3	Crank Handle (G/11-13)
11	CJ171	Crank Handle Pin
12	DJ068	Crank Handle Spacer
13	DJ067	Crank Rod
14	CJ026	Crank Bearing
15	DJ032	Clutch Wheel
16	DJ012	Crank Gear
17	CJ014	Anti-Rev. Drag
18	CJ061	Anti-Rev. Pawl Sprg.

Key No.	Part No.	Description
19	CJ106	Pawl Spring Washer
20	DJ126	Machine Screw
21	CJ060	Anti-Rev. Pawl
22	DJ350	Finger Brake Assy.
23	DJ054	Clutch Pinion
24	CJ172	Finger Brake Pin
25	DJ301-2	Body Assy (G)/w/bearing
26	DJ769-1	Crank Rod Nut (Gold)
27	DJ190	Oscillator Gear
28	DJ199	Oscillator Gear Ret.
29	AJ057	Retainer Screw
30	AZ028	Ball Bearing
31	DJ002	Anti-Rev. Actuator
32	DJ015	*Center Shaft
33	CJ011	*Pinion Gear
34	DJ020	*Center Shaft Spring
35	DJ023	Back Cover Assy.
36	DJ075	Back Cap

\*Available as one unit,  
DJ315 Center Shaft Assy.

PLEASE ORDER BY PART NUMBER

Zebco Division Brunswick Corporation, Box 270, Tulsa, OK 74101 USA 918-836-5581