

ZEBCO 164™

CLOSED-FACE SPINNING REEL

weight	15.5 oz./440 g		
pound test	12	14	17
yards	180	165	125
meters	165	151	114
gear ratio	3.5:1		

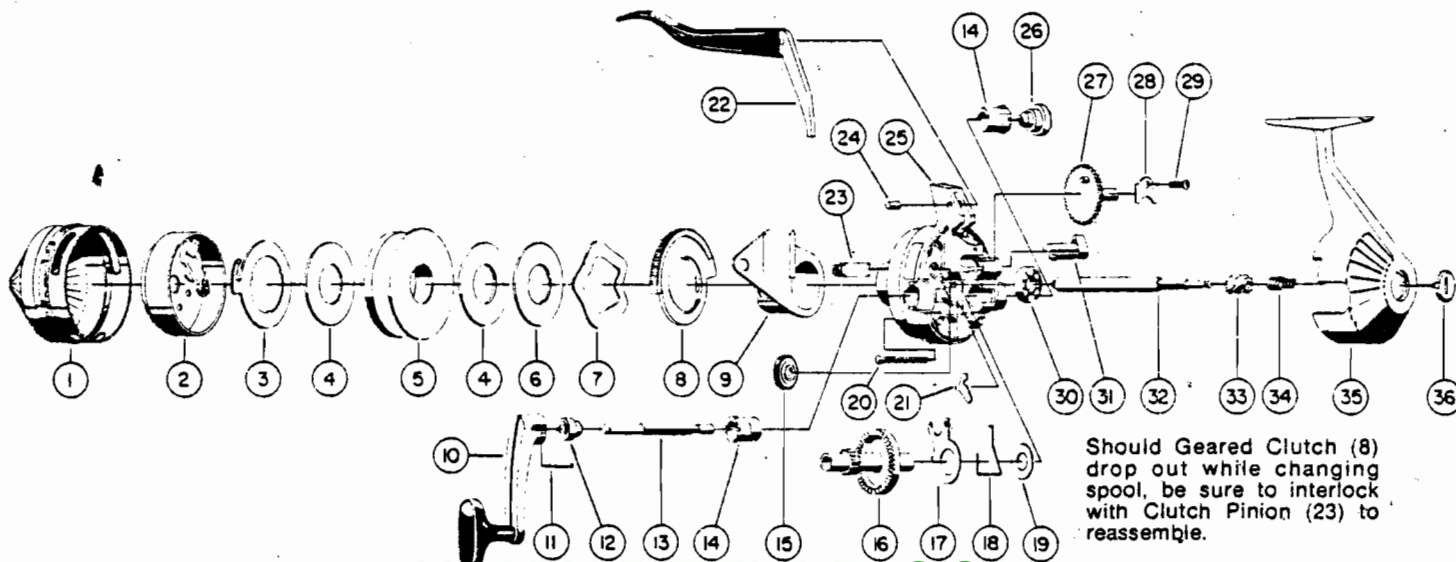

WWW.REELDR.COM

Should Geared Clutch (8) drop out while changing spool, be sure to interlock with Clutch Pinion (23) to reassemble.

KEY No.	PART No.	DESCRIPTION	PRICE	KEY No.	PART No.	DESCRIPTION	PRICE
1	DJ24//SA	FRONT COVER ASSY.	\$3.90	19	CJ106/A	PAWL SPRING WASHER	\$.30
2	DJ10//SA	SPINNER HEAD ASSY.	3.70	20	DJ126/A	MACHINE SCREW	.35
3	DJ34/F	SPOOL CLIP	.50	21	CJ60/0	ANTI-REVERSE PAWL	.40
4	DJ108/D	FLAT WASHER	.50	22	DJ50//SA	FINGER BRAKE ASSY.	1.60
5	DJ21//CP	SPOOL (EMPTY)	2.50	23	DJ54/J	CLUTCH PINION	.70
6	DJ40/C	SPOOL WASHER	.70	24	CJ172/0	FINGER BRAKE PIN	.45
7	DJ27/G	CLUTCH RING	.95	25	DJ1//SA	BODY ASSY.	5.50
8	DJ197/F	GEARED CLUTCH	.80	26	DJ69//CP	CRANK ROD NUT	.80
9	DJ189/L	SPOOL CARRIER	1.80	27	DJ190/C	OSCILLATOR GEAR	.50
10	DJ18//SA	CRANK HANDLE ASSY.	3.95	28	DJ199/B	OSCILLATOR GEAR RET.	.25
11	CJ171/A	CRANK HANDLE PIN	.30	29	AJ57/1	RETAINER SCREW	.25
12	DJ68/B	CRANK HANDLE SPACER	.60	30	AZ28/B	BALL BEARING	3.35
13	DJ67/C	CRANK ROD	2.25	31	DJ2/B	ANTI-REVERSE ACTUATOR	.50
14	CJ26/B	CRANK BEARING	.65	32	DJ15//TP	*CENTER SHAFT	1.25
15	DJ32/H	CLUTCH WHEEL	.85	33	CJ11/A	*PINION GEAR	2.05
16	DJ12/C	CRANK GEAR	1.80	34	DJ20//CP	*CENTER SHAFT SPRING	.30
17	CJ14/0	ANTI-REVERSE DRAG	.35	35	DJ23//CP	BACK COVER ASSY.	5.50
18	CJ61/0	ANTI-REVERSE PAWL SPRG.	.35	36	DJ75/C	BACK CAP	.65

*AVAILABLE AS ONE UNIT,
DJ15//SA CENTER SHAFT ASSY. 3.20

PLEASE ORDER BY PART NUMBER