

ZEBCO 154™ (Gold)

CLOSED-FACE SPINNING REEL

| | | | |
|------------|----------------|-----|----|
| weight | 10.5 oz./298 g | | |
| pound test | 8 | 10 | 12 |
| yards | 120 | 110 | 90 |
| meters | 110 | 101 | 82 |
| gear ratio | 3.5:1 | | |

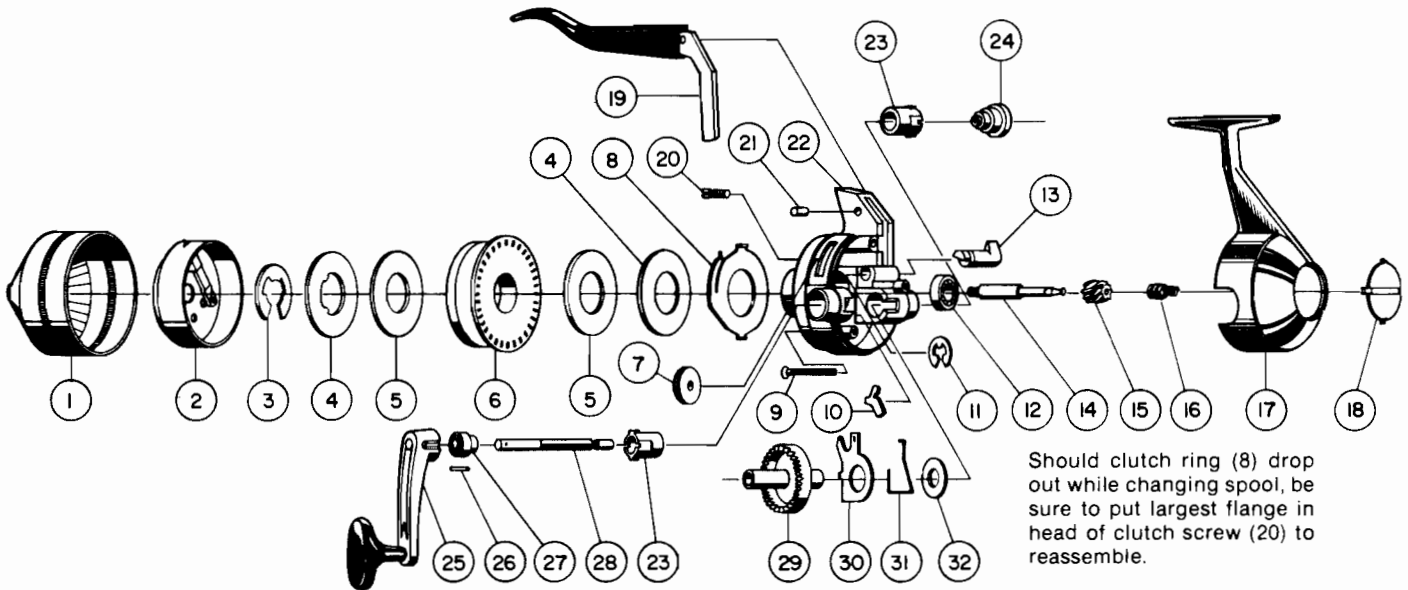

Should clutch ring (8) drop out while changing spool, be sure to put largest flange in head of clutch screw (20) to reassemble.

MODEL 154 (Gold)

WWW.REELDR.COM

| Key No. | Part No. | Description | Key No. | Part No. | Description |
|---------|-----------|-----------------------|---------|----------|-------------------------|
| 1 | CJ324-3 | Front Cover (Gold) | 17 | CJ023 | Back Cover |
| 2 | CJ310 | Spinner Head | 18 | DJ075 | Back Cap |
| 3 | GZ034 | Retainer Clip | 19 | CJ350 | Finger Brake |
| 4 | CJ040 | Spool Washer | 20 | BJ054 | Clutch Screw |
| 5 | CJ108 | Flat Washer | 21 | CJ172 | Finger Brake Pin |
| 6 | CJ021 | Spool (Empty) | 22 | CJ301-2 | Body Assy. (G) w/Bear. |
| | CJ321-10T | Spool w/10# Trilene | 23 | CJ026 | Crank Bearing |
| 7 | CJ032 | Clutch Wheel | 24 | DJ769-1 | Crank Rod Nut (G) |
| 8 | CJ027 | Clutch Ring | 25 | CJ318-2 | (G) Crank Handle(25-28) |
| 9 | CJ126 | Machine Screw | 26 | CJ171 | Crank Handle Pin |
| 10 | CJ060 | Anti-Reverse Pawl | 27 | DJ068 | Crank Rod Spacer |
| 11 | BJ121 | Retaining Clip | 28 | CJ067 | Crank Rod |
| 12 | AZ028 | Ball Bearing | 29 | CJ012 | Crank Gear |
| 13 | CJ002 | Anti-Reverse Actuator | 30 | CJ014 | Anti-Reverse Drag |
| 14 | CJ015 | *Center Shaft | 31 | CJ061 | Anti-Rev. Pawl Spring |
| 15 | CJ011 | *Pinion Gear | 32 | CJ106 | Washer |
| 16 | DJ020 | *Center Shaft Spring | | | |

*Available as One Unit,
CJ315 Center Shaft Assy.

PLEASE ORDER BY PART NUMBER

Zebco Division Brunswick Corporation, Box 270, Tulsa, OK 74101 USA 918-836-5581