

ZEBCO 144™

CLOSED-FACE SPINNING REEL

weight	3.7 oz./108 g		
pound test	4	6	8
yards	85	60	45
meters	78	55	41
gear ratio	4.1:1		

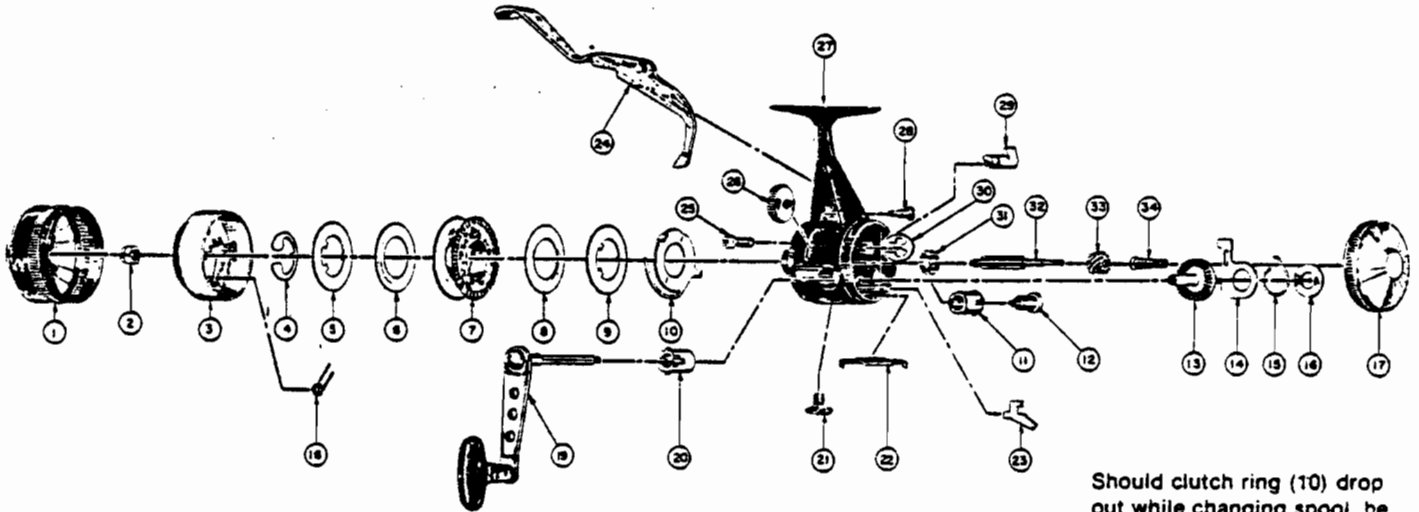

Should clutch ring (10) drop out while changing spool, be sure to put largest flange in head of clutch screw (25) to reassemble.

WWW.REELDR.COM

KEY No.	PART No.	DESCRIPTION	PRICE	KEY No.	PART No.	DESCRIPTION	PRICE
1	BJ24//SA	FRONT COVER	\$2.50	18	AJ49/0	SPINNER HEAD SPRING	\$.25
2	AJ6/C	SPINNER HEAD NUT	.30	19	BJ18//SA	HANDLE ASSY.	3.75
3	AJ10//SA	SPINNER HEAD ASSY.	2.20	20	BJ26/0	CRANK BEARING	1.00
4	XZ34/0	SPOOL CLIP	.25	21	AJ55/B	COVER LOCK SCREW	.30
5	BJ40//TP	SPOOL WASHER	.45	22	BJ56/0	COVER LOCK NUT	.30
6	BJ108/0	FLAT WASHER	.30	23	BJ60/0	ANTI-REVERSE PAWL	.75
7	AJ21//SA	SPOOL (EMPTY)	1.40	24	BJ50//CP	FINGER BRAKE	2.00
8	BJ108/0	FLAT WASHER	.30	25	BJ54/0	CLUTCH SCREW	.25
9	BJ40//TP	SPOOL WASHER	.45	26	BJ32/0	CLUTCH WHEEL	.25
10	BJ27/A	CLUTCH RING	1.00	27	BJ1//SA	BODY	6.50
11	BJ26/0	CRANK BEARING	1.00	28	BJ126/0	FINGER BRAKE SCREW	.25
12	BJ69/B	CRANK ROD NUT	.25	29	BJ2/A	ANTI-REVERSE ACTUATOR	.35
13	BJ12/0	CRANK GEAR	1.50	30	BJ121/0	RETAINER CLIP	.25
14	BJ14//TP	ANTI-REVERSE DRAG	.75	31	BJ17/0	CENTER SHAFT BEARING	3.50
15	BJ61/0	ANTI-REVERSE PAWL SPRING	.50	32	BJ15/THT	* CENTER SHAFT	1.15
16	BJ106/0	THRUST WASHER	.25	33	BJ11/0	* PINION GEAR	1.10
17	BJ23/0	BACK COVER	2.50	34	BJ20/0	* CENTER SHAFT SPRING	.25

*AVAILABLE AS ONE UNIT, BJ15//SA CENTER SHAFT ASSY. 3.00

PLEASE ORDER BY PART NUMBER